



K-STEEL

CALL MODULE

Download from www.urmet.com Technical Manuals area.

SECTION CONTENTS

K-STEEL CALLING MODULE WITH REPERTORY Ref.1072/14	2
PERFORMANCE	2
STRUCTURE	2
DESCRIPTION OF TERMINALS AND CONNECTORS.....	3
TECHNICAL SPECIFICATIONS.....	3
DEFAULT SETTINGS.....	3
OPERATION	3
Calls to users.....	3
Direct call to concierge switchboard.....	4
Door opener codes.....	4
Busy function.....	4
ADJUSTMENTS	5
Volume adjustment.....	5
Display contrast regulation.....	5
ADDITIONAL ALPHABETIC KEYBOARD Ref. 1038/73.....	5
INSTALLATION.....	5
Flush-mounted version.....	5
Wall-mounted version with case and hood.....	7
EXAMPLES OF MODULAR CONSTRUCTIONS.....	8
PROGRAMMING	See section 1A



K-STEEL CALLING MODULE WITH REPERTORY Ref. 1072/14

PERFORMANCE - STRUCTURE

urmet

K-STEEL CALLING MODULE WITH REPERTORY Ref. 1072/14

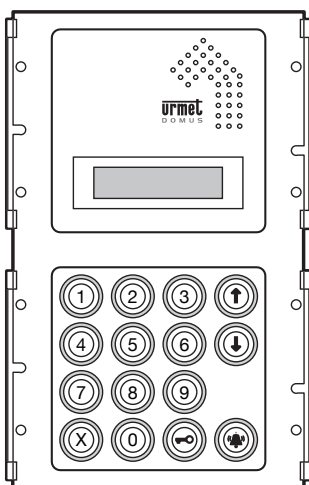

The Ref. 1072/14 calling module corresponds to 2 K-Steel modules and is provided with back-lit 16x2 character display, built-in door unit and back-lit buttons. Flush-mounting boxes or cases with hood and respective frame are required for installation (see "Installation" section).

The 2nd edition Ref. 1072/14 calling module with repertory can be used both in new installations and for retrofitting old 1st edition systems.

 Systems are called "2nd edition" (and consequently offer BIBUS 2nd edition performance) when all devices in the system are 2nd edition devices and configured as such.

PERFORMANCE

The calling module with repertory Ref. 1072/14 offers the following functions:

- Direct user call by entering numeric code.
- Direct user call by entering alphanumeric code connecting optional alphabetic keyboard Ref. 1038/73. Codes can have letter prefixes or suffixes with letters A-J.
- User calls by selecting stored names (max. 250).
- Direct concierge switchboard call (day mode only) by pressing specific button  only (where configured).
- Management of 250 names with respective 4-digit door opener code.
- Management of additional 8 generic door opener codes with time bands using external clock.
- The module can be programmed by means of a keyboard, programming keyboard Ref. 1032/65 or PC.
- Direct lock management by capacitance discharge and hold current with programmable activation time from 1 to 30s.
- Programmable door phone pick-up time (10, 20, 30, 40s).
- Programmable minimum guaranteed conversation time (10, 20, 30, 40s).
- Maximum conversation time: 250s.
- Open door contact input.
- Hall button timed input.
- Mail key input.
- Acoustic "call placed" signal.
- Busy function signalled by message on display.
- Speaker and microphone volume adjustment trimmer.
- Display contrast adjustment.
- Opto-isolated control signal management for video door phone systems.
- Multilingual message display without additional EEPROM: Italian, English, French, German, Spanish, Portuguese, Swedish, Norwegian, Finnish, Dutch, Danish, Czech, Slovak, Polish, Turkish and Russian.

STRUCTURE

The calling module with directory consists of the following parts:

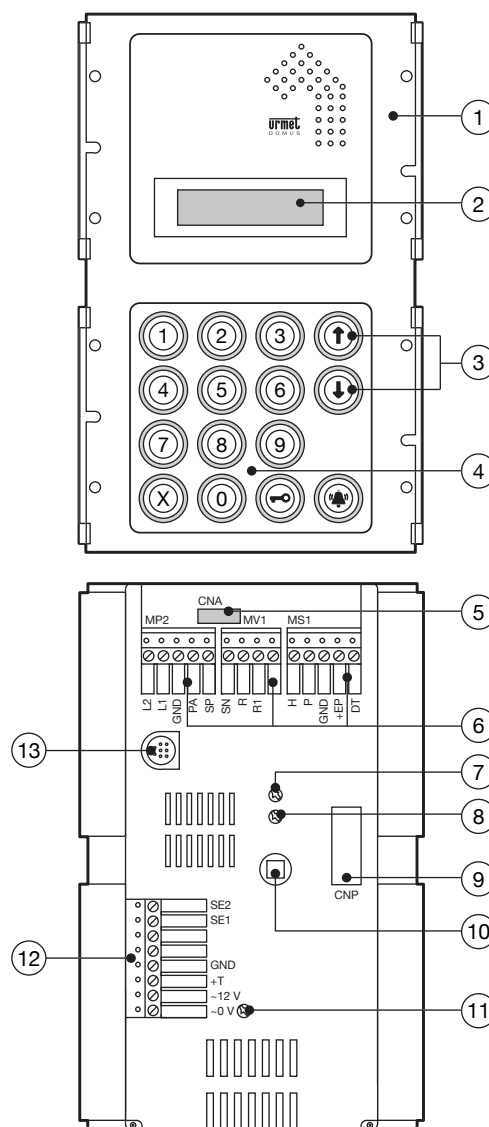

- 1 K-Steel 2 module front panel.
- 2 Alphanumeric display, two-rows, 16-characters, back-lit.
- 3 Yellow back-lit name selection buttons.
- 4 Green back-lit number pad buttons with yellow back-lit function buttons: "Cancel", "Key" and "Call".
- 5 Additional alphanumeric keyboard (1038/73) connector.
- 6 Extractable connection terminal boards (MP2, MV1, MS1).
- 7 Calling module speaker volume adjustment trimmer.
- 8 Calling module microphone volume adjustment trimmer.
- 9 Programming alphanumeric keyboard (1032/65) connector (CNP).
- 10 Programming button (for use only when password is not known).
- 11 LCD display contrast adjustment trimmer.
- 12 Extractable connection terminal board (MP1).
- 13 PC wire connector (CNS).



DESCRIPTION OF TERMINALS AND CONNECTORS

MP1 terminal board

~0	Power 12Vac
~12	Power 12Vac
+T	Back-up power positive
GND	Back-up power negative
SE1	Electrical lock connection
SE2	Electrical lock connection

MP2 terminal board

L1	Bus line 1st wire
L2	Bus line 2nd wire
GND	Reference electrical ground
PA	Hall door opener button input
SP	Open door sensor contact input

MV1 terminal board

SN	Video power unit on signal for video door phone systems
R	Video switching enable signal for video door phone systems
R1	Video power ground

MS1 terminal board

H	Door opener code time band contact input
P	Mail key input
GND	Reference electrical ground
+EP	Auxiliary device power
DT	Not used

CNA Alphanumeric keyboard connector 1038/73

CNP Programming keyboard connector 1032/65

CNS PC serial line connector

The module is programmed by default with a jumper between ground and the "SP" signal to simulate the door closed contact. Remove the jumper and connect the sensor between GND and SP when the open door contact is required.

Connect the electrical lock positive to terminal SE1 and the negative to terminal SE2 when polarised electrical locks are used.

IMPORTANT: Observe the instructions contained in section 1 for wiring and maximum distances.

TECHNICAL SPECIFICATIONS

Power:	12Vac rated
Stand-by consumption:	300mAac max.
Maximum consumption:	600mAac max. (*)
R signal:	I_{max}=80mA
Lock hold current:	190mA max.
Working temperature range:	-10 +50°C
Humidity:	90% RH at 30°C

(*) With alphanumeric keyboard 1038/73.

DEFAULT SETTINGS

Refer to section 1A "Programming" in this manual for how to program the device.

The default settings of the device are:

• System type:	2nd Edition
• Station type:	main
• Code format:	numeric (0001-9999)
• Station number:	1
• Pick-up time:	20s
• Busy time:	20s
• Door opener time:	pulse

To restore default settings:

- Disconnect module power.
- Hold the red programming button pressed and power up the module.
- Hold the button pressed for approximately 10 seconds and wait for a tone.
- Release the button.

OPERATION

CALLS TO USERS

A user can be called by entering the user's code on the keypad. Obviously, the code must be known to do so. The name can be sought in the integrated electronic directory if the code is not known.

CALLS TO USERS BY SELECTING THE NAME

The following message will appear on the display:

Select NAME
with ↑ or ↓

Press ↑ or ↓ to scroll the names and the codes. Hold either button pressed to increase scrolling speed.

Select the name and press to call the selected user.

The apartment door phone will ring for approximately 3 seconds. Hold pressed to send up to three consecutive calls.

Name/code display example:

URMET
1001

The following prompt will appear on the display if is not pressed for longer than two seconds after selecting a name:

To call
press

At this point, press to call or press ↑ or ↓ to scroll the name list. The following will appear on the display when the button is pressed:

CALL
IN COURSE

Press **X** to interrupt the call to the previously selected user.

The following message will appear on the display if the user picks up the handset:

TALK
PLEASE

Press **X** to end the conversation with the user.

The following message will appear if the user does not answer within the programmed pick-up time:

User
does not reply



CALLS TO USERS BY SELECTING THE CODE

Select NAME
with ↑ or ↓

Dial the code of the user to be called (numeric or alphanumeric with optional keyboard). The following will appear on the display:

CALL TO:
n°1001

Enter the code and press the to call the selected user. The apartment door phone will ring for approximately 3 seconds. Hold pressed to send up to three consecutive calls.

CALL
IN COURSE

Press **X** to interrupt the call to the previously selected user.

The following message will appear on the display if the user picks up the handset:

TALK
PLEASE

Press **X** to end the conversation with the user.

The following message will appear if the user does not answer within the programmed pick-up time:

User
does not reply

DIRECT CALL TO CONCIERGE SWITCHBOARD

Press on a calling module installed in a system with concierge switchboard to call it directly. This is only possible when the concierge switchboard is in day mode, i.e. when the concierge service is operative and the function has been activated (see "Programming"). The following message will appear on the display:

CALL TO:
Switchboard

The following will appear on the display if is pressed and either the concierge switchboard is in night mode or the function has not been activated (see "Programming").

CODE NOT
VALID

DOOR OPENER CODES

Press the button before entering each door opener code. Symbol "*" will appear on the display when entering the code for each button.

The module will open the door if the code is valid. A warning will be output if the code is not valid.

The sequence is the same for "Generic" and "Personal" door opener codes: press followed by the door opener code. The following will appear on the display:

LOCK REL. CODE

The lock will be operated and the following message will appear if the code is correct:

Go in
Please

GENERIC DOOR OPENER CODES

The generic door opener codes can be used by residents and other authorised persons to release the lock.

The calling module is dimensioned to contain **up to eight generic door opener codes** for operating the electrical lock. The codes have four digits (no letter permitted).

The eight generic door opener codes must be validated according to the time of day. The codes will operate the door lock only if the contact of the clock external to the module is open. Otherwise, the eight generic codes cannot be used to open the lock.

PERSONAL DOOR OPENER CODES

A door opener code can be associated to each name. Other 250 door opener codes can be thus programmed in addition to the generic codes. These 250 door opener codes are not concerned by the clock contact.

BUSY FUNCTION

This function is only required in systems with more than one calling device. This function is used to ensure that a conversation lasts sufficiently long following a call. The following message indicates busy status:

LINE BUSY
Please wait

The keyboard is disabled during this time. Two cases can occur:

BUSY TIME BEFORE THE CALL USER GOES ON-HOOK

This is the maximum time for the user to lift the handset or open the door without losing the call after the ring.

BUSY TIME AFTER USER GOES ON-HOOK

This is the minimum guaranteed conversation time from when the handset is picked up.



ADJUSTMENTS

VOLUME ADJUSTMENT

Volumes are calibrated by default so not to require adjustments in most cases.

Use a screwdriver to adjust the trimmers if required.

DISPLAY CONTRAST REGULATION

The display contrast is set at the factory and will not need to be adjusted in most installations.

Use a screwdriver to adjust the trimmers if required.

ADDITIONAL ALPHABETIC KEYBOARD Ref. 1038/73

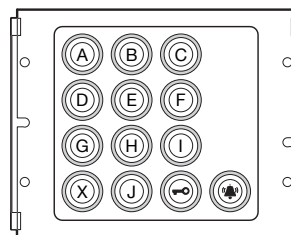

The additional alphabetic keyboard Ref. 1038/73 can be used to entered letters for dialling call codes.

The device must be combined with a calling module Ref. 1072/14 to which it is connected by means of the specific connection wire. In any case, the device must be arranged UNDERNEATH (or by THE SIDE OF) the calling module.

INSTALLATION

Calling module with repertory Ref. 1072/14 can be used alone or in combination with a camera unit and/or alphabet keyboard add-on Ref. 1038/73.

Examples of modular constructions using 2 or 3 module holder frames with respective flush-mounting boxes are shown below.

The door unit module should be installed at a height of approximately 1.55 ÷ 1.60 metres.

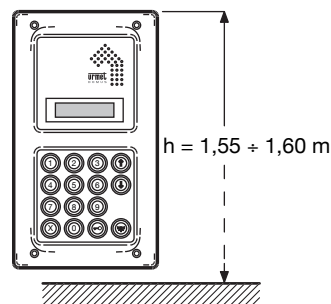

Important

The module should not be illuminated from behind to make the calling module display easier to read. Never direct the module towards strong sources of light (e.g. the sun, lampposts, light bulbs, flashes or glare).

FLUSH-MOUNTED VERSION

The flush-mounting box and respective frame must be used for flush-mounted installation.

The available models, dimensions and box and frame installation procedures are shown in Technical product manual - door phone and video door phone systems - section "Modular Vandal-Proof Panel K-Steel".

1. Refer the protections from the hole to be used to pass the wires only from the flush-mounting box.

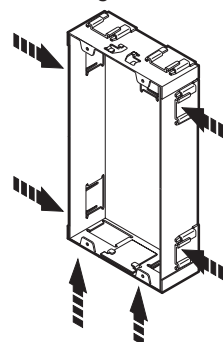



K-STEEL CALLING MODULE WITH REPERTORY Ref. 1072/14

INSTALLATION

The holes in the upper part must only be used for introducing the cables if overlapped to other boxes.

2. Flush the box and the required height considering the direction and the indications provided for video systems.

Warning: During installation, protect all parts which will be exposed to view from mortar, plaster and cement. Never use abrasive detergents to clean units.

3. Fit the flush mounting box in line with the wall: it must not project.

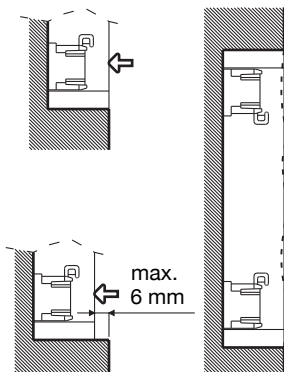

The wall surface on which the front rests must be as smooth as possible (max. tolerance 1.5 mm).

4. If the internal production has been removed from the box for any reason, insert it as shown in the figure. Fix it in the upper part not used for fixing the module holder frame.

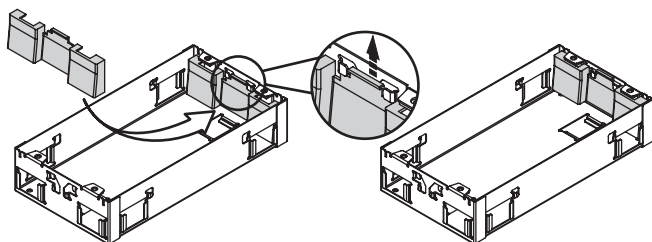

IMPORTANT: the warranty conditions will be forfeited if the protection is either not installed or installed incorrectly.

5. For fitting, loosen the two tap screws and remove the crossbar from the embedding box frame. Fit the modules in the frame.

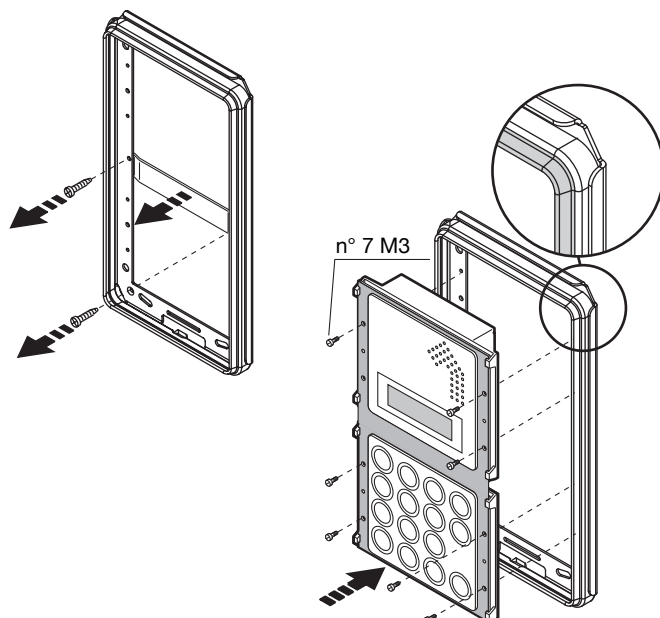

6. Fasten the module holder frame to the flush mounting boxes by means of the specific hinged attachment.

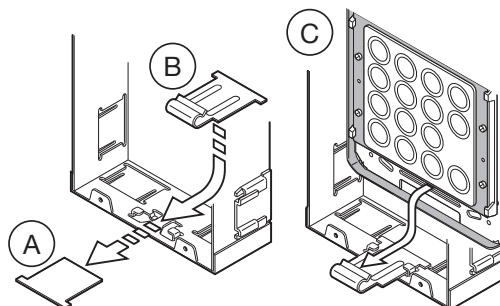

7. Fit the seal and close the frame.

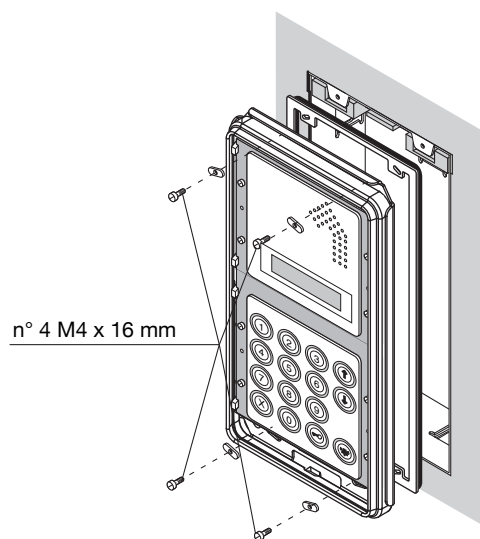
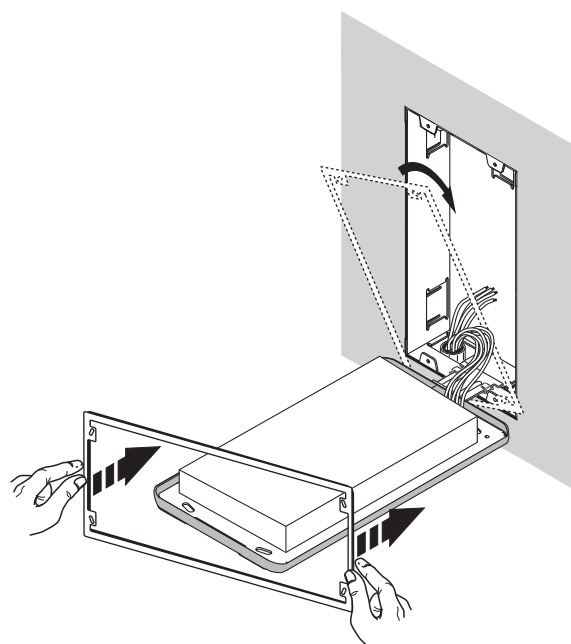



INSTALLATION

8. Fasten the frame with the three screws provided.

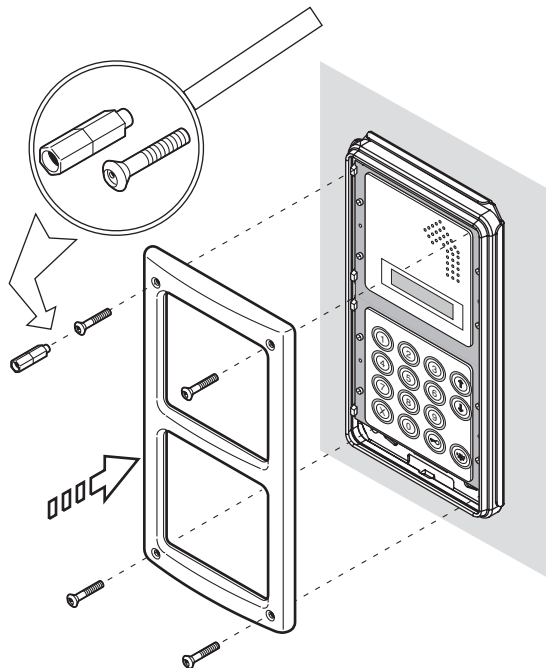

The tool must only be used manually, and not fitted on electrical screwdrivers, to prevent damaging the screws and/or the tool.

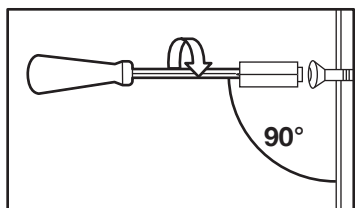

OK

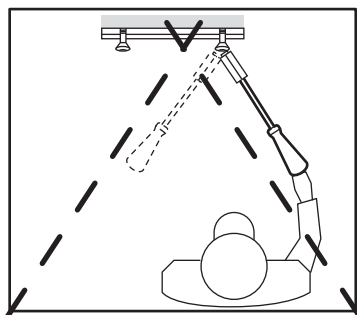
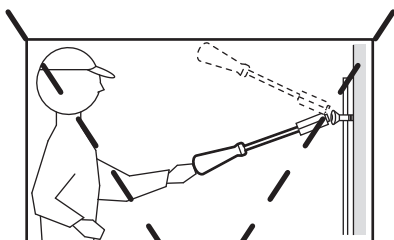

NO

WALL-MOUNTED VERSION WITH CASE AND HOOD

Cases and hoods protect the calling module from the weather and may be used for installation on walls without flush-mounted parts.

The case is provided with module holder frame. The available models and the dimensions of cases and frames are shown in Technical product manual - door phone and video door phone systems section "Modular Vandal-proof panel K-Steel".

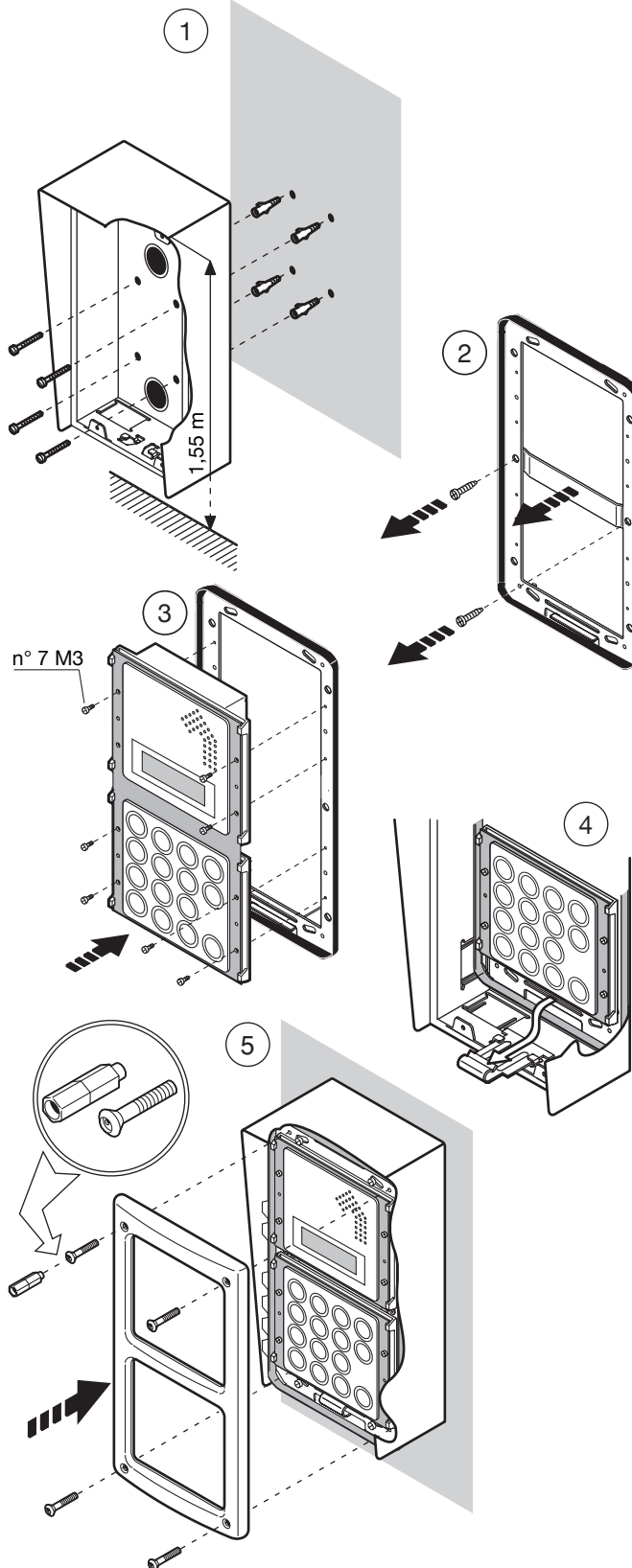



EXAMPLES OF MODULAR CONSTRUCTIONS



(*) A colour camera Ref. 1755/45 can be fitted as an alternative.