

## OVERALL DIMENSIONS

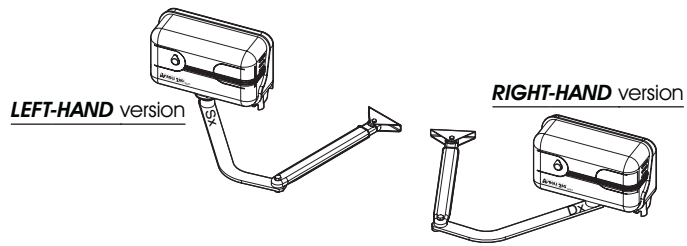

FADINI  
the gate opener  
Made in Italy

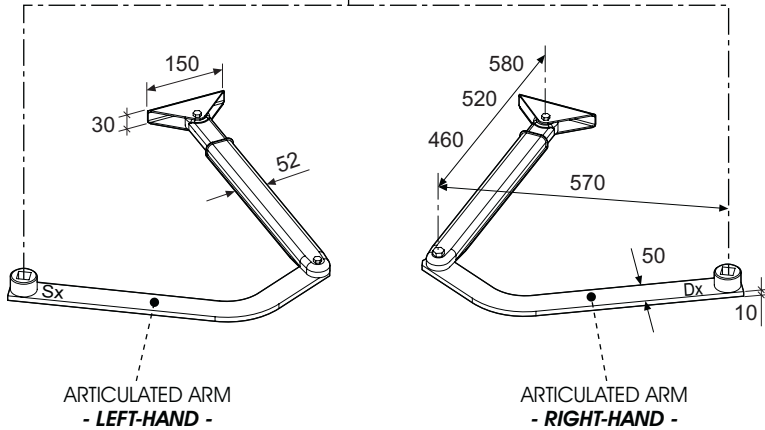
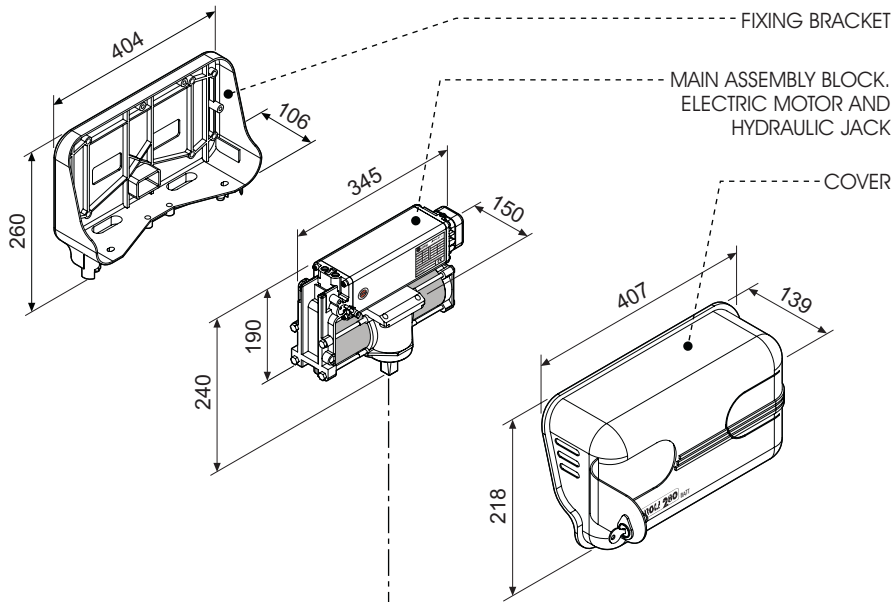

"APROLI 280/700 STRONG" is an oil-hydraulic gate operator designed for swinging gates hinged to large pillars. It consists of an hydraulic mechanism ie. Drive 700 (designed towork in the most harsh conditions) over an oil reservoir-valve block assembly. The valve block incorporates the main hydraulic features of the unit, ie. manual override by unscrewing the release valve in events like power failure and the adjustable open and close safety pressure valves to control the amount of force developed by the operator and ensure total anti-crush operations. In the valve block there is also a double locking valve that holds the gates open or closed, ie. hydraulically locked in either positions, when the motor stops (a non locking option is also available). The electric motor and the lobe-design pump are in an oil bath inside the oil reservoir, the external end cap of which is fitted with the electrical connections for power supply. The shaft has a toothed central part that can mesh a rack system and can rotate 120°; shaft rotation is by oil pressure applied to either side of the rack by means of two pistons. A strong, anti-crush, articulated arm, made of steel, is fitted to the operator shaft. The terminal section of the arm (adjustable to meet three distance requirements) is made of aluminium, and is fitted with an articulated shoe for fixing to a gate. The whole operator is weatherproof and made of shock resistant materials: the valve block, the main assembly block, the jack central casting and the fixing bracket are made of pressure cast aluminium. The high quality standards of part machining and the hardening treatment made to the gear coupling ensure maximum smoothness of operation and therefore long life to the equipment; perfect sealing of the parts that have power oil inside is guaranteed by thirty years' expertise. All the moving parts and protections have been designed to prevent any arm or danger to people.

"APROLI 280/700 STRONG" can be fitted on request with two flow regulators to be incorporated into the oil circuit to control arm speed.

"APROLI 280/700 STRONG" can be connected to the Elpro control panel, an extremely reliable control unit, and can be remotely operated from a distance by a radio transmitter, customized on request, or by a key switch, the key can be also customized having different toothing options, or by a digital key pad; the system can be connected to safety devices such as safety rubber profiles and photocells.

## TECHNICAL SPECIFICATIONS

### HYDRAULIC PUMP

P3 - Hydraulic pump capacity.....0.85 l/min.  
Average working pressure ..... 1 MPa (10 bar)  
Maximum supplied pump pressure ..... 3 MPa (30 bar)  
Working temperature .....-20°C +80°C  
Rated torque ..... 235Nm  
Maximum shaft rotation ..... 120°  
Piston diameter..... 80mm  
Piston stroke ..... 62mm  
Hydraulic oil type..... Oil Fadini  
Static weight of operator with arm ..... 20Kg  
Maximum gate weight ..... 300Kg  
Protection standard ..... IP 653

### ELECTRIC MOTOR

Power output.....0.18KW (0.25PS)  
Supply voltage..... 230V  
Frequency ..... 50Hz  
Absorbed current ..... 1.2A  
Absorbed power ..... 250W  
Capacitor ..... 12.5µF  
Motor rotation speed..... 1'350 r.p.m.  
Intermittent service..... S3

### PERFORMANCE

Service cycle: 23s opening - 30s dwell - 23s closing - 30s dwell  
Complete cycle time..... 106 s  
Complete Opening - Dwell - Closing - Dwell cycles..No.34/hour  
Annual cycles (with 8 hours of use per day).....No.99'000

### VERSIONS

- Hydraulic, non locking -----
  - Hydraulic, locking -----
  - With flow regulator -----
- } Gate length max. 3m - Gate weight max. 300Kg (An electric gate lock is recommended beyond 2m)

Drwg. No. **3506**

## TECHNICAL DATA TABLE

**OIL-HYDRAULIC OPERATOR  
FOR SWINGING GATES  
WITH VERY LARGE PILLARS**

**APROLI 280/700  
STRONG**

