



Model : MVD83SPX/12

Pixim Digital Day/Night Mini Vandal Dome Camera

Instruction Guide



GENIE CCTV LTD.

CCTV House, City Park, Watchmead, Welwyn Garden City, Hertfordshire, AL7 1LT
Tel : +44 (0) 1707 330541 Fax : +44 (0) 1707 330543
www.geniecctv.com

Edition, GN-OCTOBER 2011

Features

High Resolution colour for crisp, clear video

- 690TVL Effective

Wide Dynamic Range (WDR)

The camera delivers clear, high quality pictures even in backlight, by increasing exposure in dark areas while decreasing it in bright areas; a corrected image with clear details results.

- 120dB maximum dynamic range

DNR (Digital Noise Reduction)

The amount of low illuminance noise has been significantly reduced, and the signal-to-noise ratio (S/N ratio) as well as horizontal resolution, have been improved resulting in a clear and sharp image even in low light.

Day & Night

The camera identifies whether it is day or night and automatically switches to the appropriate mode, depending on its environment. By day, the camera switches to colour mode in order to maintain optimal colour. At night, it switches to B/W mode so as to obtain better picture definition.

High Sensitivity for low-light images

The built-in high sensitivity PIXIM SEAWOLF Sensor enables a clear image even at 0.1Lux

Programmable GAMMA Processing

Motion Detection

Since the camera detects motion without any additional external sensor, you can monitor activity more efficient.

Additional Functions

SENS-UP, FREEZE, FLIP (H/V-REV), D-ZOOM, SHARPNESS and PRIVACY functions are provided.

Controlled by OSD Menu

The camera can be controlled by selecting text displayed on the monitor screen.

3 Axis built-in Vandal Resistant Dome Housing

Weather Proof (IP66)

Installation Of Camera

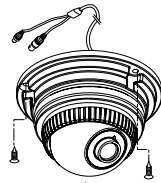

Surface mount

- Fix the BASE HOUSING to the desired place with screws supplied.
- Adjust desired scene by turning and moving the CAMERA BRACKET and fix it with STOPPER RING by turning it by hand.
- Put the DOME COVER over the BASE HOUSING and turn it clockwise by hand.
- To fix DOME COVER tight, use SET SCREW.



Flush mount

- Use "Ceiling processing sticker" on the desired place to install camera and make a hole on that place.
- Place the BASE HOUSING on the hole and fix it with screws supplied.
- Adjust desired scene by turning and moving the CAMERA BRACKET and fix it with STOPPER RING by turning it by hand.
- Put the DOME COVER over the BASE HOUSING and turn it clockwise by hand.

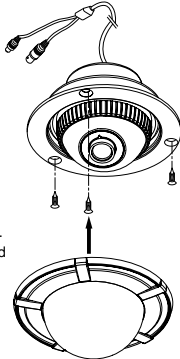

Dimensions

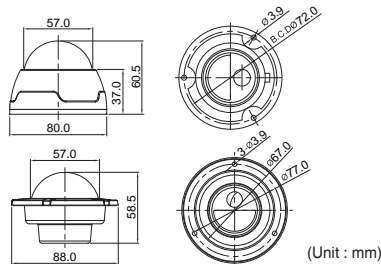

Cable Connections

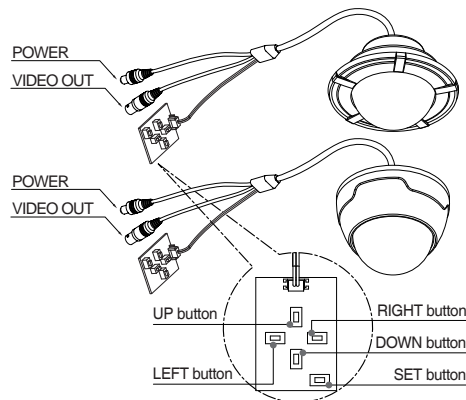

How to Use the Camera

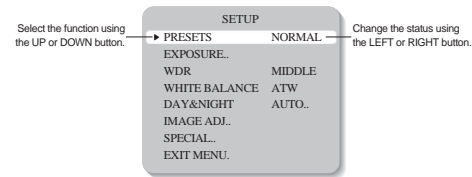

- Set up a selected item by using the Left and Right buttons.
- To finish and save the settings, select 'EXIT MENU' and press the SET button.

Note

- An item with the ... icon also has sub-menus. To select a sub-menu, press the SET button.

PRESETS

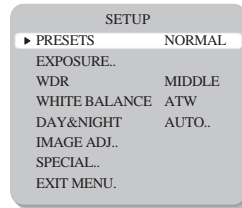

- **NORMAL** : Normal environment.
- **INDOOR** : Indoor environment.
- **OUTDOOR** : Outdoor environment.
- **BACKLIGHT** : Backlight environment.

EXPOSURE

When the SETUP menu screen is displayed, select 'EXPOSURE' by using the Up and Down buttons so that the arrow indicates 'EXPOSURE'.

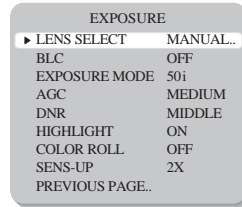
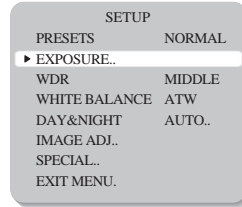

- **LENS SELECT** : Using this function, you can control the screen brightness.
- DC / Manual : Select Lens Type.

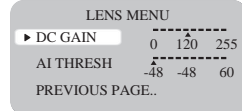

- **BLC** : To optimize the scene when there is a strong backlight behind the object.
- ON / OFF selectable

How to Use the Camera

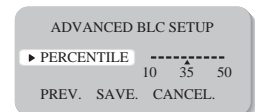

- **EXPOSURE MODE** : To select the number of fields and number of exposure cycles.
- 50i/25p selectable
- **AGC (AUTO GAIN CONTROL)** : In dark environments, the higher the gain level, the brighter the screen but the higher the noise.
- OFF / LOW / MEDIUM / HIGH selectable
- **DNR (Digital Noise Reduction)** : The level of background noise in low light decreases automatically as the level of gain changes.
- OFF / LOW / MIDDLE / HIGH selectable
- **HIGHLIGHT** : To optimise the scene when high dynamic range lighting is detected.
- ON : bright parts of the image are most visible.
- OFF : dark parts of the image are most visible.
- **COLOR ROLL** : To control a detector that finds colour fluorescent roll.
- OFF / LOW selectable
- **SENS-UP** : When it is night or dark, the camera automatically detects the light level and maintains a clear picture if this mode is activated.
- 2X, 4X, 8X, 16X, 32X
- OFF : Deactivates the SENS-UP function.

WDR

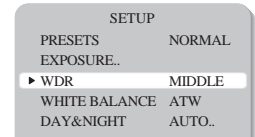

- **WDR** : When the image has simultaneous bright and dark areas, the Wide Dynamic Range makes both areas distinct.
- LOW / MIDDLE / HIGH / USER selectable.

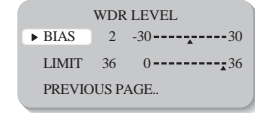

WHITE BALANCE

Use the White Balance function to adjust the screen colours.

- Position the cursor to point to WHITE BAL on the SETUP menu screen, select using the Up and Down buttons.
- Select the desired mode using the Left and Right buttons.

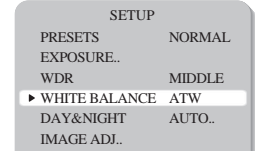

*Select one of the following 5 modes, as appropriate.

- **ATW** : The ATW mode continuously monitors.
- **INDOOR** : Select when the colour temperature is between 4000°K and 8500°K
- **OUTDOOR** : Select when the colour temperature is between 2000°K and 11000°K
- **AWB** : To obtain the optimum state under the current luminance levels, direct the camera to point toward a sheet of white paper and press the SET button. If the environment changes, including the light source, the white balance will require re-adjustment.
- **MANUAL** : Select to "fine-tune" the White Balance manually. Set White Balance first using the ATW or AWB mode. Afterwards switch to MANUAL mode, fine-tune the White Balance and then press the SET button.

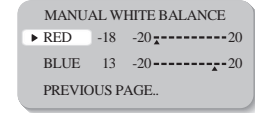

How to Use the Camera

Note

- Under the following conditions White Balance may not work properly. In such cases, select the AWC mode.
 - When the colour temperature of the subject environment has a very high temperature range (e.g. clear sky, or sunset)
 - When the ambient illumination of the subject is low.
 - If the camera is directed toward a fluorescent light, or is installed in a place where illumination changes dramatically, the White Balance operation may become unstable.

DAY&NIGHT

SETUP

PRESETS NORMAL

EXPOSURE..

WDR MIDDLE

WHITE BALANCE ATW

▶ DAY&NIGHT AUTO..

IMAGE ADJ..

SPECIAL..

EXIT MENU.

- AUTO** : This camera has a function which automatically changes to the appropriate mode according to lighting levels. To set up the switching time for the AUTO mode press the SET button.

DAY&NIGHT SETUP

▶ NIGHT MODE BW +burst
BW
COLOR

TIME DELAY 0 1 255

PREVIOUS PAGE..

- COLOR** : The picture is displayed in colour.
- B/W** : The picture is always displayed in black and white.

IMAGE ADJ.

When the SETUP menu screen is displayed, select 'IMAGE ADJ.' using the Up and Down buttons.

SETUP

PRESETS NORMAL

EXPOSURE..

WDR MIDDLE

WHITE BALANCE ATW

DAY&NIGHT AUTO..

▶ IMAGE ADJ..

SPECIAL..

IMAGE

▶ FREEZE OFF

FLIP OFF

SHARPNESS -8 0 8

COLOR GAIN -8 0 8

GAMMA 45 25 100

FOCUS..

PREVIOUS PAGE..

- FREEZE** : View still pictures.
- OFF / ON selectable
- FLIP** : OFF / HORIZ / VERT / BOTH selectable

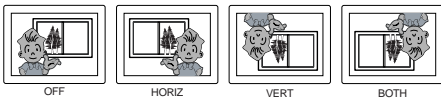

How to Use the Camera

- SHARPNESS** : The outline of the video image becomes cleaner and more distinctive as the level of SHARPNESS increases. If the level goes up excessively, however, it may affect the video image and generate noise.
- The available range of level is -8 ~ 8
- COLOR GAIN** : To control the colour level in the video.
- The available range of level is -8 ~ 8
- GAMMA** : Users can change the gamma setting between 25 and 100
- FOCUS** : To adjust the lens focus.

FOCUS DETECTOR

▶ FOCUS METER 88

SET FOCUS REGION..

PREVIOUS PAGE..

SET FOCUS REGION

SPECIAL

When the SETUP menu screen is displayed, select 'SPECIAL' by using the Up and Down buttons so that the arrow indicates 'SPECIAL'.

SETUP

PRESETS NORMAL

EXPOSURE..

WDR MIDDLE

WHITE BALANCE ATW

DAY&NIGHT AUTO..

IMAGE ADJ..

▶ SPECIAL..

EXIT MENU.

SPECIAL

▶ CAMERA ID OFF

VIDEO OUT..

DZOOM OFF

MOTION OFF

PRIVACY MASK..

RESET

PREVIOUS PAGE..

- CAMERA ID** : User can enter a unique name for the respective camera. The maximum length of the ID is ten characters.
 - You can choose the ON and OFF with the selector. If you select ON, the entered camera ID is displayed at the selected position in the video picture (normal operation).
 - Please select the setup button while in On mode.
 - Select the desired position with the selector.

CAMERA ID

▶ ID CAM-001

POSITION UP-LEFT

PREVIOUS PAGE..

- Move the cursor to the letter required by using the Set-Up button.
- Select an ID from A,B-Y,Z, a,b-y,z, 0,1-8,9 by using the LEFT and RIGHT buttons.
- Repeat the above steps until the ID is complete.

CAMERA ID

ID CAM-001

▶ POSITION UP-LEFT

PREVIOUS PAGE..

- Select the position where the ID is to be displayed by using the LEFT and RIGHT buttons.
- VIDEO OUT** : Move the cursor to select the video system
- VIDEO STANDARD : You can control NTSC / PAL, Video level, Sync level, Burst level.

How to Use the Camera

VIDEO STANDARD

▶ VIDEO SELECT PAL

VIDEO LEVEL 80 110 150

SYNC LVL 0 -16 15

BURST LVL 0 -16 15

COLOR BAR OFF

PREVIOUS PAGE..

- DZOOM** : Digital P/T/Z are used to create a zoom lens effect. Zoom Factor (1X to 4X), Pan ($\pm 100\%$, center of image can be moved to left and right edges of screen), Tilt ($\pm 100\%$, center of image can be moved to top and bottom edges of screen)

DZOOM

▶ ZOOM 1 1 4

PAN 0 -100 100

TILT 0 -100 100

PREVIOUS PAGE..

- MOTION** : This product has a feature that allows you to observe movements of objects in on the screen, hence a single individual can conduct supervision efficiently. The camera detects an object's movement by sensing disparity of outline, and level of brightness and colour.

MOTION DETECTION

▶ ACTIVITY THR. 0 25 255

MESSAGE TIME 1 3 10

SETUP MOTION PAGE..

PREVIOUS PAGE..

MOTION ZONE SETUP

- White : MOTION ZONE Position movement
- Green : MOTION ZONE Size enlargement
- Red : MOTION ZONE Size reduction
- For MOTION ZONE Confirm, long press SET button

- PRIVACY MASK** : Hide an area you want to hide on the screen.

PRIVACY MASK SETUP

▶ PRIVACY MASK OFF

MASK COLOR WHITE

PREVIOUS PAGE..

ENABLE MASKS (1 to 6)

▶ MASK 1 ON

MASK 2 OFF

MASK 3 OFF

MASK 4 OFF

MASK 5 OFF

MASK 6 OFF

PREV. NEXT.

ENABLE MASKS (7 to 12)

▶ MASK 7 OFF

MASK 8 OFF

MASK 9 OFF

MASK 10 OFF

MASK 11 OFF

MASK 12 OFF

PREVIOUS PAGE..

- White : PRIVACY-ZONE Position movement
- Blue : PRIVACY-ZONE Size enlargement or reduction
- For PRIVACY-ZONE Confirm, long press SET button

- RESET** : Resets the camera.

How to Use the Camera

EXIT MENU.

EXIT MENU

▶ VERSION : 7.3.2-7.0.281

SAVE&EXIT

DEFAULT

CANCEL

- VERSION** : 7.3.2-7.0.281
- SAVE&EXIT** : Saves all the setting menus and then exits.
- DEFAULT** : Resets the camera settings to the factory defaults.
- CANCEL** : Cancel to the camera settings.

Specifications

ITEM	SPEC.
Power Consumption	12VDC (Max.150mA)
Image Sensor	PIXIM 1/3" High Sensitivity Digital Sensor
Signal processing	17-bit Digital Signal Processing
Transfer Format	Progressive with Segmented Frames
Sync. System	Internal
Effective Pixels	758(H) x 540(V)
Dynamic Range	120dB(Max), 102dB(Typical)
Horizontal Resolution	690TVL Effective
Min. Illumination	0.1Lux
Day & Night	AUTO / COLOR / B/W
White Balance	ATW / AWB / INDOOR / OUTDOOR / MANUAL
WB Range	2000°K~11,000°K
Shutter Speed	up to 1/30, 720 sec
Sens-up	AUTO / OFF (Selectable x2 ~ x32)
Privacy Masking	12 Zones
AGC	OFF / LOW / MEDIUM / HIGH
Image Flip	OFF / HORIZ / VERT / BOTH
Camera ID	ON / OFF
S/N Ratio	More than 50dB
Video Output	Composite video output 75 ohm terminated
OSD	Built-in
Operating Humidity	30% ~ 90% RH
Operating Temp.	-10°C to 50°
Weatherproof	IP66
Weight	Approx. 230g