

bitronvideo

Est. 1967

S T Y L E A N D I N N O V A T I O N



door entry
door chimes
access control

FDi

ACCESS CONTROL
SPECIALIST

GROTHE
SIGNALLING

UK catalogue

edition six



Est. 1967 - 45 Years of International Excellence

Bitron Video's industrial experience started out with the aim of designing, manufacturing and distributing video door phone systems. A great idea for an innovative challenge which dates back to 1967. The awareness that the market was ready and able to receive innovative equipment and solutions, motivated the Company to look for and propose completely revamped solutions, focussing on national and international operators.

BitronVideo, following the popularity it gained right from its first products - products which demonstrated excellent performance capacity including in the most demanding operating conditions. In the 1980s the company manufactured extra-flat monitors and eliminated coaxial cables in video door phone systems. During the 1990s it introduced colour monitors, using LCD screens with active-matrix. Armed with its solid know-how, it is considered a leading company in the Italian market and achieves excellent sales results throughout the world.

During its long industrial career, filled with creativity and strong innovative contents, Bitron Video has introduced solid technological benchmarks and made the most significant and original steps in the specific evolution of the door phone industry.

- 1967 - Founding of Bitron Video, in Turin, Italy
- 1968 - Birth of video door phones with the GC1 group and MV1 monitor
- 1972 - First wall mounted compact monitor MV5
- 1987 - Elimination of the coaxial cable, miniaturisation of the filming unit (G60K) and first flat cathode tube monitor (MV55)
- 1991 - Creation of the DOMULAR line with modular pushbutton panel combinable with audio and video units in a single model
- 1999 - Presentation of digital BUS technology (BUS2 and BUS4)
- 2001 - Presentation of new design with introduction of the DRIN line for audio and video door phone kit
- 2003 - Announcement of the evolved pushbutton panel range, DOMULAR 3000
- 2007 - Launch of the new T-line line designed by Designer Francesco Trabucco
- 2010 - Launch of new T-class panel - Another result of the tried and tested collaboration between architect Trabucco and Bitron Video
- 2012 - Launch of new B-twin 2 wires non-polarized system - 'Installation simplified'
- 2012 - Launch of B-touch Handsfree Monitor for use with B-twin

bitronvideo



UK Catalogue

Edition Six

Contents

Introduction

Btwin two wire systems

1-4

Btwin TClass/Btwin VR Inox/B Touch monitors

Audio and Video Analogue Systems

5-19

Cable examples/TClass analogue/Domular Classic/VR Inox analogue/Bespoke panels

Audio and Video Digital Systems

20-23

Dig-Inox/MDK

Audio and Video Door Phones

24-26

T-line Audio/T-line Video/T-look

Starter Kits and Accessories

27-33

Audio and Video T-line boxed kits/PSUs and Switchers/Seal Bit/Simple Case

Telephone Entry Systems

34-37

Platel Digital/Alpha +/TPI +

FDI Access Control Proximity Systems

38-49

Introduction/Easy Door/Transit/BSoft/Passan/Keys and accessories

FDI Access Control Coded Access Systems

50-51

KPad/VR

Grothe Door Chimes

52-57

Wired and Wireless Chimes/Kits/Bell pushes and accessories

Locks, Locking Accessories and Metal work

58-59

Lock Releases/Magnet Locks/PTEs/BGUs/Fire Switches Vehicle Post's



	WIRES	MAX. USERS	MONITORS	A MT BETWEEN ENTRY PANEL AND POWER SUPPLY UNIT	B MT BETWEEN POWER SUPPLY UNIT AND MONITOR	Extension*
	2 wires	128	Colour	200	200	800
			B/W	200	200	800
	CAT5 UTP (1 twisted pair)	64	Colour	100	125	800
			B/W	100	75	800

* Extension is the sum of all cabled segments both in apartment and in riser column to the entry panel.
When using multicolour cables, NEVER short-circuit several conductors to increase the wire cross-section area.

A system implementing modern functions without needing to replace wires: any two of the existing wires can be used in common modernisation jobs. See wire table for extensions.

Simply Smart

Btwin is the new two non-polarised wire system for 2012. Entirely designed and made in Italy, Btwin has been developed according to strict standards and processes. Rigorous quality control, testing guarantees maximum system performance and reliability.

Btwin is designed with installers in mind and styled according to modern market expectations it enables the installation of a top-class system with state of the art functions in an easy way using only two wires throughout, from entry panel to apartment handset. By taking advantage of the new innovations and technology in its design a fully operational system of up to 4096 users can be installed more easily and in less time than ever before. The system is easily set up using dip switch programming and includes intercom function and cycle control for two cameras as standard with no other modules required.

System replacement using Btwin becomes easy without the need to replace wiring and a full range of monitors and handsets are available to compliment any installation.

These are only some of the advantages of this system which brings a new era to the door entry market, giving flexible solutions it is ideal for applications spanning from villas and apartment blocks, to residential compounds.

Think big, work easy. Btwin: designed for installers, and their customers.



DISTANCE A
MT BETWEEN
ENTRY PANEL AND
POWER SUPPLY UNIT



DISTANCE B
MT BETWEEN
POWER SUPPLY UNIT
AND MONITOR



Compatible with full range of BITRON products



System architecture using Btwin cable or Cat

- 2 wires throughout
- 128 users per riser column (64 Cat 5)
- 4 common main entrances
- 2 further inner entry panels per riser column
- 32 riser columns
- 4,096 total users (2048 cat5)
- 200 mt. from power supply to entry panel (100mtr Cat5)
- 800 mt. of extension on each riser column
- 4 apartment handsets (monitors and/or door phones) in parallel per apartment
- 2 entrances managed from a single entry panel (main door lock and inner lock)
- 4 user floor distributors save on amount of cables required in the riser.

TWO NON-POLARISED WIRES. THROUGHOUT.

All devices are connected using only two wires, including the entry panel.



FOR INSTALLERS, FOR THEIR CUSTOMERS.

Btwin is designed for installers: simple, rapid installation for making even complex systems with guaranteed success. Top-notch satisfaction also for end users: Btwin provides the comfort of modern functional needs and a wide assortment of apartment stations and entry panels.

Quick and easy installation, for new and modernisation projects

In Btwin, everything is studied to make the installer's job easy. In modernisations, the advantages are truly surprising: no wires need to be replaced to install Btwin. Using the existing wires, the system is updated and new functions can be used.

Less time, maximum profits

Simplicity means quick installation and programming (using convenient dip switches): for saving not only time!

Flexibility: quality dedicated to small and large numbers

Two wires throughout: using the same simple wiring in all situations, the system adapts to the needs of end customers, from standard to sophisticate. For this reason, Btwin is the best solution for villas, apartment blocks and large residential compounds alike.

Only three components, many combinations

Only three components form the heart of the system: these components are enough to make a basic system with standard colour camera and freeintercom function. All with only two wires.

Maximum result, certain guarantee

Reliable, simple: no mistakes are possible. Furthermore, the system guarantees service continuity even in case of short-circuits. The branch protections make sure the column keeps on working. A great advantage for users!

Quick maintenance

Quick system management: all operations must be carried out with the system live. The short-circuit block delimits the faulty area so that it can be promptly identified.

code	description
AV1001/07	T-Class audio module. 2 push buttons. B-Twin installation
AV1001/08	T-Class colour video module. 2 push buttons. B-Twin installation
AV4187/16	16 push buttons encoder module for B-Twin video systems on T-Class panels
AV1001/02	Power supply for B-Twin video systems
AV1001/05	B-Twin riser multiplexer
AV1001/09	B-Twin panel hub
AV1001/03	4 outputs video distributor for B-Twin video systems
AV1001/20	Cable for B-Twin video systems
AV1001/04	Porter's exchange for B-Twin installations





2 WIRE NON-POLARISED SYSTEM

Simply Smart

Btwin is the new non-polarised 2 wire system.

Btwin is designed with installers in mind and styled according to modern market expectations.

It enables the installation of a top-class system with state of the art functions in an easy way using only two wires throughout, from entry panel to apartment handset.

A fully operational system can be installed more easily and in less time than ever before.

Think big, work easy. Btwin: designed for installers and their customers.



VR Btwin Part Numbers

code	description
VR-1FBTV	Btwin VR-Inox vandal resistant 316l marine grade stainless steel flush colour video 1 way 2 wire kit, includes VR colour panel, AV1423/002 video handset(s), AV1423/15 bracket(s) and PSU)
VR-2FBTV	Btwin VR-Inox vandal resistant 316l marine grade stainless steel flush colour video 2 way 2 wire kit, includes VR colour panel, AV1423/002 video handset(s), AV1423/15 bracket(s) and PSU)
VR-3FBTV	Btwin VR-Inox vandal resistant 316l marine grade stainless steel flush colour video 3 way 2 wire kit, includes VR colour panel, AV1423/002 video handset(s), AV1423/15 bracket(s) and PSU)
VR-4FBTV	Btwin VR-Inox vandal resistant 316l marine grade stainless steel flush colour video 4 way 2 wire kit, includes VR colour panel, AV1423/002 video handset(s), AV1423/15 bracket(s) and PSU)
VR-5FBTV	Btwin VR-Inox vandal resistant 316l marine grade stainless steel flush colour video 5 way 2 wire kit, includes VR colour panel, AV1423/002 video handset(s), AV1423/15 bracket(s) and PSU)
VR-6FBTV	Btwin VR-Inox vandal resistant 316l marine grade stainless steel flush colour video 6 way 2 wire kit, includes VR colour panel, AV1423/002 video handset(s), AV1423/15 bracket(s) and PSU)
VR-7FBTV	Btwin VR-Inox vandal resistant 316l marine grade stainless steel flush colour video 7 way 2 wire kit, includes VR colour panel, AV1423/002 video handset(s), AV1423/15 bracket(s) and PSU)
VR-8FBTV	Btwin VR-Inox vandal resistant 316l marine grade stainless steel flush colour video 8 way 2 wire kit, includes VR colour panel, AV1423/002 video handset(s), AV1423/15 bracket(s) and PSU)
VR-9FBTV	Btwin VR-Inox vandal resistant 316l marine grade stainless steel flush colour video 9 way 2 wire kit, includes VR colour panel, AV1423/002 video handset(s), AV1423/15 bracket(s) and PSU)

The above are the flush kit part numbers, to change to surface, change suffix "fbtv" to "sbtv" i.e VR-1FBTV to VR-1SBTV



btouch



BEAUTY TO SEE, TOUCH TECHNOLOGY TWO COLOURS, MANY FUNCTIONS

Btouch Monitor (for use with Btwin)

The new hands-free monitor Btouch with soft touch technology is dedicated to those seeking style in every detail of the furnishings. The formal rigor of the lines Btouch creates a light object, that is combined with delicacy and harmony to the environment as a modern classic. The attention to detail, the preciousness of the finish in white or black, the chrome frame gives the monitor supplied with character, personality and elegance.

Designed for those who want to make a choice of style, in terms of aesthetics and performance, Btouch is the ideal monitor for the system Btwin: all the advanced features of this integrated video door entry system can be controlled directly from a simple display with icons guide every step.

Videophone speakerphone black and white transparencies

- Metal plate black or absolute white
 - Display 3.5" backlit colour
 - Flush Mounting
 - Removable terminal blocks
 - Frame supplied
 - Dimensions (W x H x D) 160 x 190 x 10mm
- Display
 - DISPLAY MUTE CALL CONNECTED (green LED)
 - AUTOMATIC DOOR RELEASE STATEMENT ON (green LED)
 - MESSAGES INDICATOR (green LED)
 - MENU BUTTON
 - DOOR OPEN INDICATION OR LACK OF REPORTING ON (RED LED)
 - BUTTON ON / OFF VOICE
 - BUTTON RELEASE
 - NAVIGATION BUTTONS, CALL THE STATION, OPEN GATE, MUTE ALARM, ETC.
 - HOME AUTOMATION

Functions:

- Intercom
- Contacts with 32 names
- Ability to report absence

 Btouch has integrated provision for users of hearing aids.



Ability to customise the templates, thanks to compatibility with Vera plates 44 in black and white glass, and metal alloy plates 44, available in silver and dark grey colors. Further colours & styles available direct from AVE in Italy.

code	description
AV1001/40	3.5" colour BTouch hands free video monitor. B-Twin installation. Black colour.
AV1001/41	3.5" colour BTouch hands free video monitor. B-Twin installation. White colour.
AVBL05P	Embedding box for BTouch monitor.
AVBL05CG	Embedding box for BTouch monitor to be installed in thin walls.

ideas, technology, experience,
yesterday and today



Analogue audio door phone systems

4+n doorphone systems

4+n wire systems are basic doorphone installations. Single and multiple entrances, either main or secondary, may be installed as required. Bitron Video systems include modern technical solutions such as electronic calls, conversation privacy and intercom options. A wide range of accessories, including relay boxes, power units and wired and wireless ringers give you the freedom to customise the system.

These are traditional audio systems and are familiar to most installers. 4+n systems are available in all different panel styles and can accommodate any number of users. The only limit is the number of buttons that can fit on a panel.

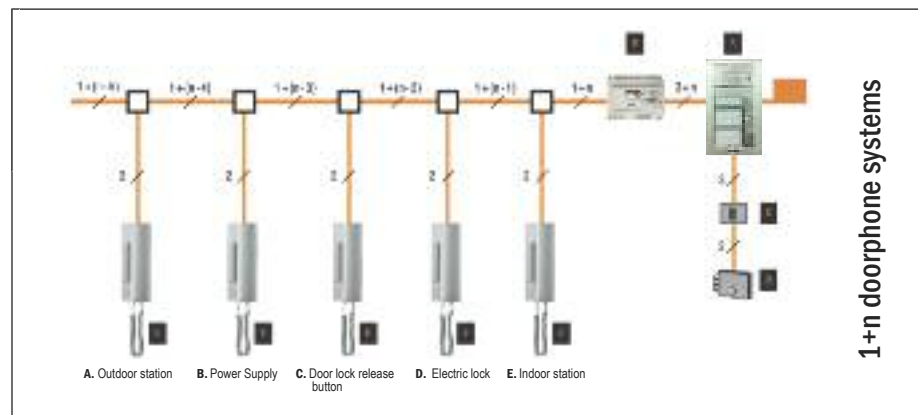
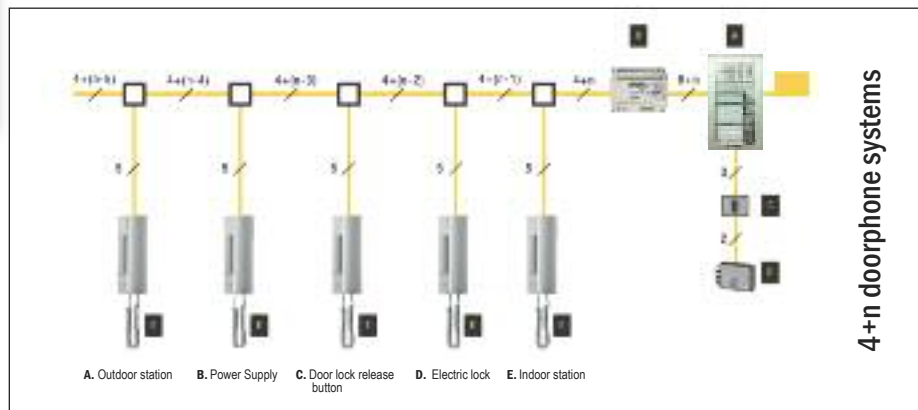

1+n doorphone systems

This is the necessary choice for renovating older buildings and replacing an old bell with a modern doorphone. Installation is today as flexible as all the other doorphone systems because considerably fewer wires are employed in the system.

Bitron Video offer 1+n panel modules for all panel styles, providing the same features as traditional doorphones: easy installation, great aesthetics and extremely practical use and maintenance.

Analogue video doorphone system

5 wires no-coax

5-wires no-coax systems are Bitron Video's history. Bitron Video is a leader in this technology, offering high-performance, either black and white or colour systems, with or without intercom functions, which are easy to set up. The Domular Classic Evolution panel instead implements modern systems of proven technology and reliability. The VR-Inox range offers exactly the same technology wrapped in a robust, stainless steel shell with vandal resistant push-buttons.

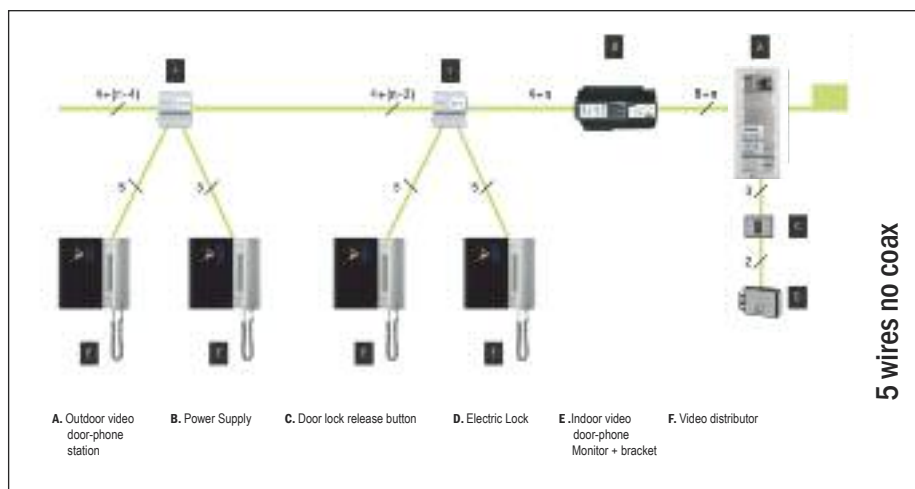

Up to 4 monitors can be connected to each distributor

Systems can also be wired back to a common point

Up to 2 monitors can be connected in parallel without requiring an additional PSU (when using the AV7362 PSU)

Analogue video doorphone uses 4 common wires in the installation and a wire for each user. It is not necessary to have a coaxial cable for video signal distribution.

The illustration above shows wiring modality and video signal distribution in a video doorphone installation with one riser and distributors at the floor.

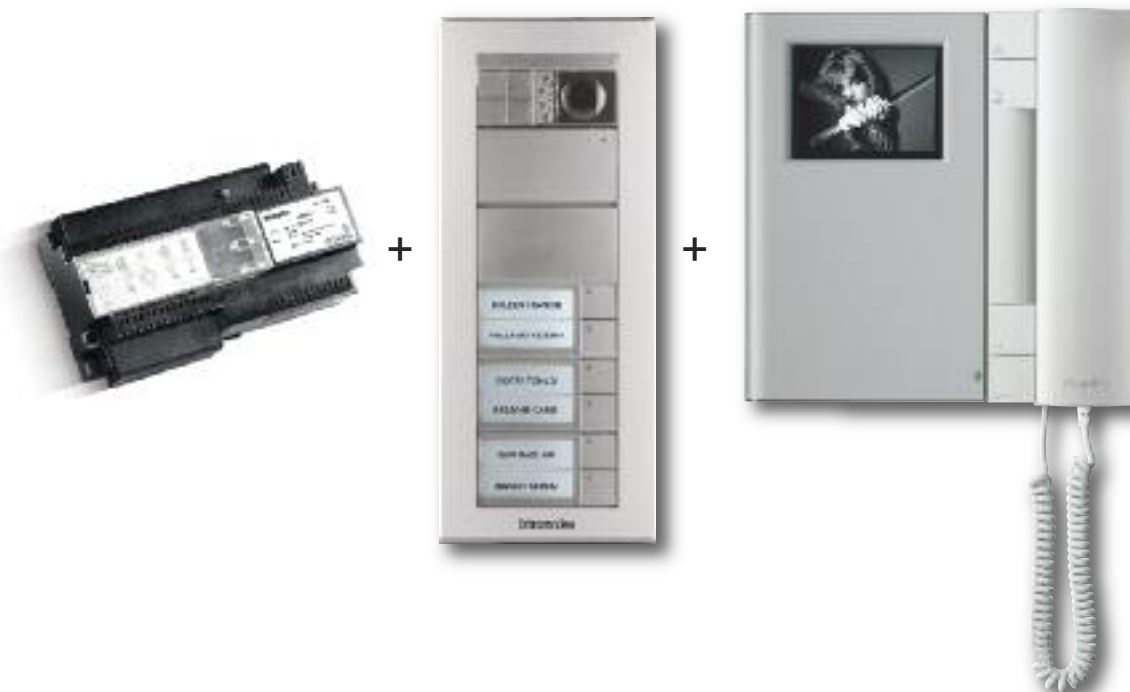



TCLASS

...the character of performance...



T-Class is the new panel which continues Bitron Video's "Style and Innovation" philosophy. With this new product, Bitron Video confirms the vision of a range revamping project with the goal of providing stylish, reliable answers to the market.

T-Class houses flexible technology (analogue and digital versions are available in audio and video) in a slim casing. The design features of the range include perfectly flat surfaces, blue LED illumination, high quality metallic finish and soft-to-the-touch buttons.



With a matt aluminium frame and techno-polymer metallic finish modules, the panel structure is both light and tough. The light-colour finish is refined and discreet. The panel has a large name window area for resident names or apartment numbers.

The design follows on from the range of T-Line doorphones and video doorphones and updates the external elements of the system in line with the internal units.

The standard colour camera implements wide angle technology: ahead of the most recent European standards, the wider framed area means that the system can be used also by a person in a wheelchair.





Tclass



■ TC-9FA



code	description
Flush 4+n Audio Kits	
TC-1FA	T-Class 1-way flush audio 4+N Kit (Kit Includes T-Class surface panel, AN1299 PSU & AV1407/001 Handsets)
TC-2FA	T-Class 2-way flush audio 4+N Kit (Kit Includes T-Class surface panel, AN1299 PSU & AV1407/001 Handsets)
TC-3FA	T-Class 3-way flush audio 4+N Kit (Kit Includes T-Class surface panel, AN1299 PSU & AV1407/001 Handsets)
TC-4FA	T-Class 4-way flush audio 4+N Kit (Kit Includes T-Class surface panel, AN1299 PSU & AV1407/001 Handsets)
TC-5FA	T-Class 5-way flush audio 4+N Kit (Kit Includes T-Class surface panel, AN1299 PSU & AV1407/001 Handsets)
TC-6FA	T-Class 6-way flush audio 4+N Kit (Kit Includes T-Class surface panel, AN1299 PSU & AV1407/001 Handsets)
TC-7FA	T-Class 7-way flush audio 4+N Kit (Kit Includes T-Class surface panel, AN1299 PSU & AV1407/001 Handsets)
TC-8FA	T-Class 8-way flush audio 4+N Kit (Kit Includes T-Class surface panel, AN1299 PSU & AV1407/001 Handsets)
TC-9FA	T-Class 9-way flush audio 4+N Kit (Kit Includes T-Class surface panel, AN1299 PSU & AV1407/001 Handsets)
TC-10FA	T-Class 10-way flush audio 4+N Kit (Kit Includes T-Class surface panel, AN1299 PSU & AV1407/001 Handsets)
Surface 4+n Audio Kits	
TC-1SA	T-Class 1-way surface audio 4+N Kit (Kit Includes T-Class surface panel, AN1299 PSU & AV1407/001 Handsets)
TC-2SA	T-Class 2-way surface audio 4+N Kit (Kit Includes T-Class surface panel, AN1299 PSU & AV1407/001 Handsets)
TC-3SA	T-Class 3-way surface audio 4+N Kit (Kit Includes T-Class surface panel, AN1299 PSU & AV1407/001 Handsets)
TC-4SA	T-Class 4-way surface audio 4+N Kit (Kit Includes T-Class surface panel, AN1299 PSU & AV1407/001 Handsets)
TC-5SA	T-Class 5-way surface audio 4+N Kit (Kit Includes T-Class surface panel, AN1299 PSU & AV1407/001 Handsets)
TC-6SA	T-Class 6-way surface audio 4+N Kit (Kit Includes T-Class surface panel, AN1299 PSU & AV1407/001 Handsets)
TC-7SA	T-Class 7-way surface audio 4+N Kit (Kit Includes T-Class surface panel, AN1299 PSU & AV1407/001 Handsets)
TC-8SA	T-Class 8-way surface audio 4+N Kit (Kit Includes T-Class surface panel, AN1299 PSU & AV1407/001 Handsets)
TC-9SA	T-Class 9-way surface audio 4+N Kit (Kit Includes T-Class surface panel, AN1299 PSU & AV1407/001 Handsets)
TC-10SA	T-Class 10-way surface audio 4+N Kit (Kit Includes T-Class surface panel, AN1299 PSU & AV1407/001 Handsets)





Tclass

code	description
Flush Mono Video Kits	
TC-1FMV	T-Class 1-way flush mono video Kit (Kit Includes surface panel, AV2900/303 PSU & AV1423/001 Monitor & AV1423/010 Bracket)
TC-2FMV	T-Class 2-way flush mono video Kit (Kit Includes T-Class surface panel, AV2900/303 PSU & AV1423/001 Monitor & AV1423/010 Bracket)
TC-3FMV	T-Class 3-way flush mono video Kit (Kit Includes T-Class surface panel, AV2900/303 PSU & AV1423/001 Monitor & AV1423/010 Bracket)
TC-4FMV	T-Class 4-way flush mono video Kit (Kit Includes T-Class surface panel, AV2900/303 PSU & AV1423/001 Monitor & AV1423/010 Bracket)
TC-5FMV	T-Class 5-way flush mono video Kit (Kit Includes T-Class surface panel, AV2900/303 PsSU & AV1423/001 Monitor & AV1423/010 Bracket)
TC-6FMV	T-Class 6-way flush mono video Kit (Kit Includes T-Class surface panel, AV2900/303 PSU & AV1423/001 Monitor & AV1423/010 Bracket)
TC-7FMV	T-Class 7-way flush mono video Kit (Kit Includes T-Class surface panel, AV2900/303 PSU & AV1423/001 Monitor & AV1423/010 Bracket)
TC-8FMV	T-Class 8-way flush mono video Kit (Kit Includes T-Class surface panel, AV2900/303 PSU & AV1423/001 Monitor & AV1423/010 Bracket)
TC-9FMV	T-Class 9-way flush mono video Kit (Kit Includes T-Class surface panel, AV2900/303 PSU & AV1423/001 Monitor & AV1423/010 Bracket)
TC-10FMV	T-Class 10-way flush mono video Kit (Kit Includes surface panel, AV2900/303 PSU & AV1423/001 Monitor & AV1423/010 Bracket)
Surface Mono Video Kits	
TC-1SMV	T-Class 1-way surface mono video Kit (Kit Includes T-Class surface panel, AV2900/303 PSU & AV1423/001 Monitor & AV1423/010 Bracket)
TC-2SMV	T-Class 2-way surface mono video Kit (Kit Includes T-Class surface panel, AV2900/303 PSU & AV1423/001 Monitor & AV1423/010 Bracket)
TC-3SMV	T-Class 3-way surface mono video Kit (Kit Includes T-Class surface panel, AV2900/303 PSU & AV1423/001 Monitor & AV1423/010 Bracket)
TC-4SMV	T-Class 4-way surface mono video Kit (Kit Includes T-Class surface panel, AV2900/303 PSU & AV1423/001 Monitor & AV1423/010 Bracket)
TC-5SMV	T-Class 5-way surface mono video Kit (Kit Includes T-Class surface panel, AV2900/303 PSU & AV1423/001 Monitor & AV1423/010 Bracket)
TC-6SMV	T-Class 6-way surface mono video Kit (Kit Includes T-Class surface panel, AV2900/303 PSU & AV1423/001 Monitor & AV1423/010 Bracket)
TC-7SMV	T-Class 7-way surface mono video Kit (Kit Includes T-Class surface panel, AV2900/303 PSU & AV1423/001 Monitor & AV1423/010 Bracket)
TC-8SMV	T-Class 8-way surface mono video Kit (Kit Includes T-Class surface panel, AV2900/303 PSU & AV1423/001 Monitor & AV1423/010 Bracket)
TC-9SMV	T-Class 9-way surface mono video Kit (Kit Includes T-Class surface panel, AV2900/303 PSU & AV1423/001 Monitor & AV1423/010 Bracket)
TC-10SMV	T-Class 10-way surface mono video Kit (Kit Includes T-Class surface panel, AV2900/303 PSU & AV1423/001 Monitor & AV1423/010 Bracket)

■ TC-6FMV



■ AV1423/001



Tclass

code	description
Flush Colour Video Kits	
TC-1FCV	T-Class 1-way flush colour video Kit (Kit Includes T-Class surface panel, AV2900/303 PSU & AV1423/002 Monitor & AV1423/010 Bracket)
TC-2FCV	T-Class 2-way flush colour video Kit (Kit Includes T-Class surface panel, AV2900/303 PSU & AV1423/002 Monitor & AV1423/010 Bracket)
TC-3FCV	T-Class 3-way flush colour video Kit (Kit Includes T-Class surface panel, AV2900/303 PSU & AV1423/002 Monitor & AV1423/010 Bracket)
TC-4FCV	T-Class 4-way flush colour video Kit (Kit Includes T-Class surface panel, AV2900/303 PSU & AV1423/002 Monitor & AV1423/010 Bracket)
TC-5FCV	T-Class 5-way flush colour video Kit (Kit Includes T-Class surface panel, AV2900/303 PSU & AV1423/002 Monitor & AV1423/010 Bracket)
TC-6FCV	T-Class 6-way flush colour video Kit (Kit Includes T-Class surface panel, AV2900/303 PSU & AV1423/002 Monitor & AV1423/010 Bracket)
TC-7FCV	T-Class 7-way flush colour video Kit (Kit Includes T-Class surface panel, AV2900/303 PSU & AV1423/002 Monitor & AV1423/010 Bracket)
TC-8FCV	T-Class 8-way flush colour video Kit (Kit Includes T-Class surface panel, AV2900/303 PSU & AV1423/002 Monitor & AV1423/010 Bracket)
TC-9FCV	T-Class 9-way flush colour video Kit (Kit Includes T-Class surface panel, AV2900/303 PSU & AV1423/002 Monitor & AV1423/010 Bracket)
TC-10FCV	T-Class 10-way flush colour video Kit (Kit Includes T-Class surface panel, AV2900/303 PSU & AV1423/002 Monitor & AV1423/010 Bracket)
Surface Colour Video Kits	
TC-1SCV	T-Class 1-way surface colour video Kit (Kit Includes T-Class surface panel, AV2900/303 PSU & AV1423/002 Monitor & AV1423/010 Bracket)
TC-2SCV	T-Class 2-way surface colour video Kit (Kit Includes T-Class surface panel, AV2900/303 PSU & AV1423/002 Monitor & AV1423/010 Bracket)
TC-3SCV	T-Class 3-way surface colour video Kit (Kit Includes T-Class surface panel, AV2900/303 PSU & AV1423/002 Monitor & AV1423/010 Bracket)
TC-4SCV	T-Class 4-way surface colour video Kit (Kit Includes T-Class surface panel, AV2900/303 PSU & AV1423/002 Monitor & AV1423/010 Bracket)
TC-5SCV	T-Class 5-way surface colour video Kit (Kit Includes T-Class surface panel, AV2900/303 PSU & AV1423/002 Monitor & AV1423/010 Bracket)
TC-6SCV	T-Class 6-way surface colour video Kit (Kit Includes T-Class surface panel, AV2900/303 PSU & AV1423/002 Monitor & AV1423/010 Bracket)
TC-7SCV	T-Class 7-way surface colour video Kit (Kit Includes T-Class surface panel, AV2900/303 PSU & AV1423/002 Monitor & AV1423/010 Bracket)
TC-8SCV	T-Class 8-way surface colour video Kit (Kit Includes T-Class surface panel, AV2900/303 PSU & AV1423/002 Monitor & AV1423/010 Bracket)
TC-9SCV	T-Class 9-way surface colour video Kit (Kit Includes T-Class surface panel, AV2900/303 PSU & AV1423/002 Monitor & AV1423/010 Bracket)
TC-10SCV	T-Class 10-way surface colour video Kit (Kit Includes T-Class surface panel, AV2900/303 PSU & AV1423/002 Monitor & AV1423/010 Bracket)

TC-6FMV



AV1423/002



the modern classic,
video doorphone

Robust Metal Construction

Domular Classic EVOLUTION

Domular Classic Evolution has a modular structure for highly versatile use.

The embedding boxes may be arranged side-by-side very easily by exploiting the pre-cut areas for introducing wires. Furthermore, the modules can be fixed to each box and connected safely and rapidly using the specially provided supports. Agile and ready to satisfy all needs, the "Classic" is designed to adapt to all audio and video doorphone systems. It may be either embedded or wall-mounted.

In designing and renewing the Domular Classic Evolution panel, Bitron Video has enhanced the appearance of the panel with a matt silver anodised finish and added complementary blue LED backlighting.

The call buttons are large and splittable, with plenty of room for displaying several names. The position of the camera in the video version (black and white or colour), can be adjusted to ensure the best view.

Standard devices can be integrated with one of the latest technological innovations in the sector: an access control proximity reader which by means of a special key allows to open doors and monitor all system accesses simply by connecting to a computer.

Note: All Domular Classic Evolution buttons include a diode plate and are therefore suitable for 4+n and 1+n systems



Panels have
Splittable buttons

Stainless Steel
Shell

Domular Classic VOLUTION



■ C-8FA / C-16FA

Audio Kits

code	description
Flush - AUDIO 4+N	
C-1FA	Domular Classic 1-way flush audio 4+N Kit (Kit Includes Classic flush panel, AV1142 Psu & AV1407/001 handsets)
C-2FA	Domular Classic 2-way flush audio 4+N Kit (Kit Includes Classic flush panel, AV1142 Psu & AV1407/001 handsets)
C-3FA	Domular Classic 3-way flush audio 4+N Kit (Kit Includes Classic flush panel, AV1142 Psu & AV1407/001 handsets)
C-4FA	Domular Classic 4-way flush audio 4+N Kit (Kit Includes Classic flush panel, AV1142 Psu & AV1407/001 handsets)
C-5FA	Domular Classic 5-way flush audio 4+N Kit (Kit Includes Classic flush panel, AV1142 Psu & AV1407/001 handsets)
C-6FA	Domular Classic 6-way flush audio 4+N Kit (Kit Includes Classic flush panel, AV1142 Psu & AV1407/001 handsets)
C-7FA	Domular Classic 7-way flush audio 4+N Kit (Kit Includes Classic flush panel, AV1142 Psu & AV1407/001 handsets)
C-8FA	Domular Classic 8-way flush audio 4+N Kit (Kit Includes Classic flush panel, AV1142 Psu & AV1407/001 handsets)
C-9FA	Domular Classic 9-way flush audio 4+N Kit (Kit Includes Classic flush panel, AV1142 Psu & AV1407/001 handsets)
C-10FA	Domular Classic 10-way flush audio 4+N Kit (Kit Includes Classic flush panel, AV1142 Psu & AV1407/001 handsets)
Surface - AUDIO 4+N	
C-1SA	Domular Classic 1-way surface audio 4+N Kit (Kit Includes Classic surface panel, AV1142 Psu & AV1407/001 handsets)
C-2SA	Domular Classic 2-way surface audio 4+N Kit (Kit Includes Classic surface panel, AV1142 Psu & AV1407/001 handsets)
C-3SA	Domular Classic 3-way surface audio 4+N Kit (Kit Includes Classic surface panel, AV1142 Psu & AV1407/001 handsets)
C-4SA	Domular Classic 4-way surface audio 4+N Kit (Kit Includes Classic surface panel, AV1142 Psu & AV1407/001 handsets)
C-5SA	Domular Classic 5-way surface audio 4+N Kit (Kit Includes Classic surface panel, AV1142 Psu & AV1407/001 handsets)
C-6SA	Domular Classic 6-way surface audio 4+N Kit (Kit Includes Classic surface panel, AV1142 Psu & AV1407/001 handsets)
C-7SA	Domular Classic 7-way surface audio 4+N Kit (Kit Includes Classic surface panel, AV1142 Psu & AV1407/001 handsets)
C-8SA	Domular Classic 8-way surface audio 4+N Kit (Kit Includes Classic surface panel, AV1142 Psu & AV1407/001 handsets)
C-9SA	Domular Classic 9-way surface audio 4+N Kit (Kit Includes Classic surface panel, AV1142 Psu & AV1407/001 handsets)
C-10SA	Domular Classic 10-way surface audio 4+N Kit (Kit Includes Classic surface panel, AV1142 Psu & AV1407/001 handsets)

1+n versions also available - Add "1n" suffix to list part numbers



Panels have
splittable buttons

Stainless Steel
Shell

Domular Classic EVOLUTION

code	description
Flush Mono VIDEO	
C-1FMV	Domular Classic 1-way flush mono video kit (Kit Includes Classic flush panel, AV7362 Psu & AV1423/001 handsets & AV1423/010 bracket)
C-2FMV	Domular Classic 2-way flush mono video kit (Kit Includes Classic flush panel, AV7362 Psu & AV1423/001 handsets & AV1423/010 bracket)
C-3FMV	Domular Classic 3-way flush mono video kit (Kit Includes Classic flush panel, AV7362 Psu & AV1423/001 handsets & AV1423/010 bracket)
C-4FMV	Domular Classic 4-way flush mono video kit (Kit Includes Classic flush panel, AV7362 Psu & AV1423/001 handsets & AV1423/010 bracket)
C-5FMV	Domular Classic 5-way flush mono video kit (Kit Includes Classic flush panel, AV7362 Psu & AV1423/001 handsets & AV1423/010 bracket)
C-6FMV	Domular Classic 6-way flush mono video kit (Kit Includes Classic flush panel, AV7362 Psu & AV1423/001 handsets & AV1423/010 bracket)
C-7FMV	Domular Classic 7-way flush mono video kit (Kit Includes Classic flush panel, AV7362 Psu & AV1423/001 handsets & AV1423/010 bracket)
C-8FMV	Domular Classic 8-way flush mono video kit (Kit Includes Classic flush panel, AV7362 Psu & AV1423/001 handsets & AV1423/010 bracket)
C-9FMV	Domular Classic 9-way flush mono video kit (Kit Includes Classic flush panel, AV7362 Psu & AV1423/001 handsets & AV1423/010 bracket)
C-10FMV	Domular Classic 10-way flush mono video kit (Kit Includes Classic flush panel, AV7362 Psu & AV1423/001 handsets & AV1423/010 bracket)
Flush Colour VIDEO	
C-1FCV	Domular Classic 1-way Colour video kit (Kit Includes Classic flush panel, AV7362 Psu & AV1423/002 handsets & AV1423/010 bracket)
C-2FCV	Domular Classic 2-way Colour video kit (Kit Includes Classic flush panel, AV7362 Psu & AV1423/002 handsets & AV1423/010 bracket)
C-3FCV	Domular Classic 3-way Colour video kit (Kit Includes Classic flush panel, AV7362 Psu & AV1423/002 handsets & AV1423/010 bracket)
C-4FCV	Domular Classic 4-way Colour video kit (Kit Includes Classic flush panel, AV7362 Psu & AV1423/002 handsets & AV1423/010 bracket)
C-5FCV	Domular Classic 5-way Colour video kit (Kit Includes Classic flush panel, AV7362 Psu & AV1423/002 handsets & AV1423/010 bracket)
C-6FCV	Domular Classic 6-way Colour video kit (Kit Includes Classic flush panel, AV7362 Psu & AV1423/002 handsets & AV1423/010 bracket)
C-7FCV	Domular Classic 7-way Colour video kit (Kit Includes Classic flush panel, AV7362 Psu & AV1423/002 handsets & AV1423/010 bracket)
C-8FCV	Domular Classic 8-way Colour video kit (Kit Includes Classic flush panel, AV7362 Psu & AV1423/002 handsets & AV1423/010 bracket)
C-9FCV	Domular Classic 9-way Colour video kit (Kit Includes Classic flush panel, AV7362 Psu & AV1423/002 handsets & AV1423/010 bracket)
C-10FCV	Domular Classic 10-way Colour video kit (Kit Includes Classic flush panel, AV7362 Psu & AV1423/002 handsets & AV1423/010 bracket)



■ C-10FMV / C-5FMV

■ AV1423/002



Panels have
splittable buttons

Stainless Steel
Shell

Domular Classic EVOLUTION

code	description
Surface Mono VIDEO	
C-1SMV	Domular Classic 1-way surface mono video kit (Kit Includes Classic surface panel, AV7362 Psu & AV1423/001 handsets & AV1423/010 bracket)
C-2SMV	Domular Classic 2-way surface mono video kit (Kit Includes Classic surface panel, AV7362 Psu & AV1423/001 handsets & AV1423/010 bracket)
C-3SMV	Domular Classic 3-way surface mono video kit (Kit Includes Classic surface panel, AV7362 Psu & AV1423/001 handsets & AV1423/010 bracket)
C-4SMV	Domular Classic 4-way surface mono video kit (Kit Includes Classic surface panel, AV7362 Psu & AV1423/001 handsets & AV1423/010 bracket)
C-5SMV	Domular Classic 5-way surface mono video kit (Kit Includes Classic surface panel, AV7362 Psu & AV1423/001 handsets & AV1423/010 bracket)
C-6SMV	Domular Classic 6-way surface mono video kit (Kit Includes Classic surface panel, AV7362 Psu & AV1423/001 handsets & AV1423/010 bracket)
C-7SMV	Domular Classic 7-way surface mono video kit (Kit Includes Classic surface panel, AV7362 Psu & AV1423/001 handsets & AV1423/010 bracket)
C-8SMV	Domular Classic 8-way surface mono video kit (Kit Includes Classic surface panel, AV7362 Psu & AV1423/001 handsets & AV1423/010 bracket)
C-9SMV	Domular Classic 9-way surface mono video kit (Kit Includes Classic surface panel, AV7362 Psu & AV1423/001 handsets & AV1423/010 bracket)
C-10SMV	Domular Classic 10-way surface mono video kit (Kit Includes Classic surface panel, AV7362 Psu & AV1423/001 handsets & AV1423/010 bracket)
Surface Colour VIDEO	
C-1SCV	Domular Classic 1-way Colour video kit (Kit Includes Classic surface panel, AV7362 Psu & AV1423/002 handsets & AV1423/010 bracket)
C-2SCV	Domular Classic 2-way Colour video kit (Kit Includes Classic surface panel, AV7362 Psu & AV1423/002 handsets & AV1423/010 bracket)
C-3SCV	Domular Classic 3-way Colour video kit (Kit Includes Classic surface panel, AV7362 Psu & AV1423/002 handsets & AV1423/010 bracket)
C-4SCV	Domular Classic 4-way Colour video kit (Kit Includes Classic surface panel, AV7362 Psu & AV1423/002 handsets & AV1423/010 bracket)
C-5SCV	Domular Classic 5-way Colour video kit (Kit Includes Classic surface panel, AV7362 Psu & AV1423/002 handsets & AV1423/010 bracket)
C-6SCV	Domular Classic 6-way Colour video kit (Kit Includes Classic surface panel, AV7362 Psu & AV1423/002 handsets & AV1423/010 bracket)
C-7SCV	Domular Classic 7-way Colour video kit (Kit Includes Classic surface panel, AV7362 Psu & AV1423/002 handsets & AV1423/010 bracket)
C-8SCV	Domular Classic 8-way Colour video kit (Kit Includes Classic surface panel, AV7362 Psu & AV1423/002 handsets & AV1423/010 bracket)
C-9SCV	Domular Classic 9-way Colour video kit (Kit Includes Classic surface panel, AV7362 Psu & AV1423/002 handsets & AV1423/010 bracket)
C-10SCV	Domular Classic 10-way Colour video kit (Kit Includes Classic surface panel, AV7362 Psu & AV1423/002 handsets & AV1423/010 bracket)



■ C-9SMV / C-18SMV
9 / 18 way panel



■ AV1423/002

VR-Inox

Vandal Resistant Analogue Panel Range

The VR-Inox range of audio and video entry panels brings a new level of vandal resistance to the Bitron Video range.

The panels are manufactured from a marine grade 316L low carbon stainless steel and have a brushed finish. They use the same trusted "5-wire" video technology and "1+n" or "4+n" audio systems as the rest of the range.

The push buttons to call flats or to activate the Trades facility are also stainless steel with a mechanical stop and are securely fixed into the panel by a hex-nut on the rear so they will stand up to sustained heavy traffic and vandalism attacks.

The panels have a robust acrylic camera window and speaker protection grille that protects the audio/video call module inside the panel and still allows excellent image and speech quality.

Video image quality is maintained even in poor lighting conditions due to built in illumination LEDs (infrared on mono-chrome systems) and the panel is supplied with anti-tamper screws to prevent unauthorised persons opening the panel.



VR-Inox Vandal Resistant features

Panels are available either as flush fitment or surface fixed and come in a variety of sizes to accommodate different button configurations and to allow integration of an access control proximity reader or keypad.

The surface hoods are also manufactured from stainless steel, have a cable entry hole in the rear and incorporate a rain hood.

Flush back boxes are made from corrosion resistant Zintec and have "knock-out" cable entry points in all sides.

Functional panels engraved to clients requirements



Robust, acrylic camera window



Anti-vandal stainless steel push button



Integrated coded access keypad (optional)



Speaker protection grill

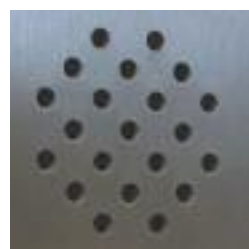

Illumination LEDs (infrared on monochrome systems)



Lead time
10 working days

1 to 20 way as
standard, other
sizes available
on request

Brass and mirror
finishes available

VR-Inox



■ VR-1FAK



■ VR-9SA + VR Trades

code	description
With heavy duty Vandal Resistant Flush Stainless Steel Panel	
VR-1FA	VR-Inox VR marine grade 316L low carbon stainless steel flush 1-way audio kit (includes AV1407/001 handset(s) & PSU)
VR-2FA	VR-Inox VR marine grade 316L low carbon stainless steel flush 2-way audio kit (includes AV1407/001 handset(s) & PSU)
VR-3FA	VR-Inox VR marine grade 316L low carbon stainless steel flush 3-way audio kit (includes AV1407/001 handset(s) & PSU)
VR-4FA	VR-Inox VR marine grade 316L low carbon stainless steel flush 4-way audio kit (includes AV1407/001 handset(s) & PSU)
VR-5FA	VR-Inox VR marine grade 316L low carbon stainless steel flush 5-way audio kit (includes AV1407/001 handset(s) & PSU)
VR-6FA	VR-Inox VR marine grade 316L low carbon stainless steel flush 6-way audio kit (includes AV1407/001 handset(s) & PSU)
VR-7FA	VR-Inox VR marine grade 316L low carbon stainless steel flush 7-way audio kit (includes AV1407/001 handset(s) & PSU)
VR-8FA	VR-Inox VR marine grade 316L low carbon stainless steel flush 8-way audio kit (includes AV1407/001 handset(s) & PSU)
With heavy duty Vandal Resistant Surface Stainless Steel panel	
VR-1SA	VR-Inox VR marine grade 316L low carbon stainless steel surface 1-way audio kit (includes AV1407/001 handset(s) & PSU)
VR-2SA	VR-Inox VR marine grade 316L low carbon stainless steel surface 2-way audio kit (includes AV1407/001 handset(s) & PSU)
VR-3SA	VR-Inox VR marine grade 316L low carbon stainless steel surface 3-way audio kit (includes AV1407/001 handset(s) & PSU)
VR-4SA	VR-Inox VR marine grade 316L low carbon stainless steel surface 4-way audio kit (includes AV1407/001 handset(s) & PSU)
VR-5SA	VR-Inox VRmarine grade 316L low carbon stainless steel surface 5-way audio kit (includes AV1407/001 handset(s) & PSU)
VR-6SA	VR-Inox VR marine grade 316L low carbon stainless steel surface 6-way audio kit (includes AV1407/001 handset(s) & PSU)
VR-7SA	VR-Inox VR marine grade 316L low carbon stainless steel surface 7-way audio kit (includes AV1407/001 handset(s) & PSU)
VR-8SA	VR-Inox VR marine grade 316L low carbon stainless steel surface 8-way audio kit (includes AV1407/001 handset(s) & PSU)

Lead time
10 working days

1 to 20 way as
standard, other
sizes available
on request

Brass and mirror
finishes available

VR-Inox

code	description
With heavy duty Vandal Resistant Flush Stainless Steel panel and mono T-line monitors	
VR-1FMV	VR-Inox vandal resistant marine grade 316L low carbon stainless steel flush 1 way mono video kit (includes AV1423/001 video handset(s), AV1423/010 bracket(s) and PSU)
VR-2FMV	VR-Inox vandal resistant marine grade 316L low carbon stainless steel flush 2 way mono video kit (includes AV1423/001 video handset(s), AV1423/010 bracket(s) and PSU)
VR-3FMV	VR-Inox vandal resistant marine grade 316L low carbon stainless steel flush 3 way mono video kit (includes AV1423/001 video handset(s), AV1423/010 bracket(s) and PSU)
VR-4FMV	VR-Inox vandal resistant marine grade 316L low steel flush 4 way mono video kit (includes AV1423/001 video handset(s), AV1423/010 bracket(s) and PSU)
VR-5FMV	VR-Inox vandal resistant marine grade 316L low carbon stainless steel flush 5 way mono video kit (includes AV1423/001 video handset(s), AV1423/010 bracket(s) and PSU)
VR-6FMV	VR-Inox vandal resistant marine grade 316L low carbon stainless steel flush 6 way mono video kit (includes AV1423/001 video handset(s), AV1423/010 bracket(s) and PSU)
VR-7FMV	VR-Inox vandal resistant marine grade 316L low carbon stainless steel flush 7 way mono video kit (includes AV1423/001 video handset(s), AV1423/010 bracket(s) and PSU)
VR-8FMV	VR-Inox vandal resistant marine grade 316L low carbon stainless steel flush 8 way mono video kit (includes AV1423/001 video handset(s), AV1423/010 bracket(s) and PSU)
With heavy duty Vandal Resistant Flush Stainless Steel panel and colour T-line monitors	
VR-1FCV	VR-Inox vandal resistant marine grade 316L low carbon stainless steel flush 1 way colour video kit (includes AV1423/002 video handset(s), AV1423/010 bracket(s) and PSU)
VR-2FCV	VR-Inox vandal resistant marine grade 316L low carbon stainless steel flush 2 way colour video kit (includes AV1423/002 video handset(s), AV1423/010 bracket(s) and PSU)
VR-3FCV	VR-Inox vandal resistant marine grade 316L low carbon stainless steel flush 3 way colour video kit (includes AV1423/002 video handset(s), AV1423/010 bracket(s) and PSU)
VR-4FCV	VR-Inox vandal resistant marine grade 316L low carbon stainless steel flush 4 way colour video kit (includes AV1423/002 video handset(s), AV1423/010 bracket(s) and PSU)
VR-5FCV	VR-Inox vandal resistant marine grade 316L low carbon stainless steel flush 5 way colour video kit (includes AV1423/002 video handset(s), AV1423/010 bracket(s) and PSU)
VR-6FCV	VR-Inox vandal resistant marine grade 316L low carbon stainless steel flush 6 way colour video kit (includes AV1423/002 video handset(s), AV1423/010 bracket(s) and PSU)
VR-7FCV	VR-Inox vandal resistant marine grade 316L low carbon stainless steel flush 7 way colour video kit (includes AV1423/002 video handset(s), AV1423/010 bracket(s) and PSU)
VR-8FCV	VR-Inox vandal resistant marine grade 316L low carbon stainless steel flush 8 way colour video kit (includes AV1423/002 video handset(s), AV1423/010 bracket(s) and PSU)

■ VR-9FMV + VR Trades Flush



■ AV1423/001

Lead time
10 working days

1 to 20 way as
standard, other
sizes available
on request

Brass and mirror
finishes available

VR-Inox

code	description
With heavy duty Vandal Resistant Surface Stainless Steel panel and mono T-line monitors	
VR-1SMV	VR-Inox vandal resistant marine grade 316L low carbon stainless steel surface 1 way mono video kit (includes AV1423/001 video handset(s), AV1423/010 bracket(s) and PSU)
VR-2SMV	VR-Inox vandal resistant marine grade 316L low carbon stainless steel surface 2 way mono video kit (includes AV1423/001 video handset(s), AV1423/010 bracket(s) and PSU)
VR-3SMV	VR-Inox vandal resistant marine grade 316L low carbon stainless steel surface 3 way mono video kit (includes AV1423/001 video handset(s), AV1423/010 bracket(s) and PSU)
VR-4SMV	VR-Inox vandal resistant marine grade 316L low carbon stainless steel surface 4 way mono video kit (includes AV1423/001 video handset(s), AV1423/010 bracket(s) and PSU)
VR-5SMV	VR-Inox vandal resistant marine grade 316L low carbon stainless steel surface 5 way mono video kit (includes AV1423/001 video handset(s), AV1423/010 bracket(s) and PSU)
VR-6SMV	VR-Inox vandal resistant marine grade 316L low carbon stainless steel surface 6 way mono video kit (includes AV1423/001 video handset(s), AV1423/010 bracket(s) and PSU)
VR-7SMV	VR-Inox vandal resistant marine grade 316L low carbon stainless steel surface 7 way mono video kit (includes AV1423/001 video handset(s), AV1423/010 bracket(s) and PSU)
VR-8SMV	VR-Inox vandal resistant marine grade 316L low carbon stainless steel surface 8 way mono video kit (includes AV1423/001 video handset(s), AV1423/010 bracket(s) and PSU)
With heavy duty Vandal Resistant Surface Stainless Steel panel and colour T-line monitors	
VR-1SCV	VR-Inox vandal resistant marine grade 316L low carbon stainless steel surface 1 way colour video kit (includes AV1423/002 video handset(s), AV1423/010 bracket(s) and PSU)
VR-2SCV	VR-Inox vandal resistant marine grade 316L low carbon stainless steel surface 2 way colour video kit (includes AV1423/002 video handset(s), AV1423/010 bracket(s) and PSU)
VR-3SCV	VR-Inox vandal resistant marine grade 316L low carbon stainless steel surface 3 way colour video kit (includes AV1423/002 video handset(s), AV1423/010 bracket(s) and PSU)
VR-4SCV	VR-Inox vandal resistant marine grade 316L low carbon stainless steel surface 4 way colour video kit (includes AV1423/002 video handset(s), AV1423/010 bracket(s) and PSU)
VR-5SCV	VR-Inox vandal resistant marine grade 316L low carbon stainless steel surface 5 way colour video kit (includes AV1423/002 video handset(s), AV1423/010 bracket(s) and PSU)
VR-6SCV	VR-Inox vandal resistant marine grade 316L low carbon stainless steel surface 6 way colour video kit (includes AV1423/002 video handset(s), AV1423/010 bracket(s) and PSU)
VR-7SCV	VR-Inox vandal resistant marine grade 316L low carbon stainless steel surface 7 way colour video kit (includes AV1423/002 video handset(s), AV1423/010 bracket(s) and PSU)
VR-8SCV	VR-Inox vandal resistant marine grade 316L low carbon stainless steel surface 8 way colour video kit (includes AV1423/002 video handset(s), AV1423/010 bracket(s) and PSU)



■ VR-9SMV + VR Trades

■ AV1423/001



■ VR-1SMV / VR-1SCV

Capable of withstanding any environment

Bespoke Panels

Panels are available either as flush fitment or surface fixed and come in a variety of sizes to accommodate different button configurations and to allow integration of an access control proximity reader or keypad.

The surface hoods are also manufactured from marine grade 316L low carbon stainless steel, have a cable entry hole in the rear and incorporate a rain hood.

Flush back boxes are made from corrosion resistant Zintec and have "knock-out" cable entry points in all sides.



Functional panels engraved to clients requirements



Robust, acrylic camera window



Integrated coded access keypad (optional)



Speaker protection grill



Anti-vandal stainless steel push button



Illumination LEDs (infrared on monochrome systems)

Bespoke Panels

We can also supply bespoke sized vandal resistant panels using the same internal components as the VR-Inox range but in sizes to suit your needs. For example when replacing an old panel that was flushed into masonry and the new panel is required to fit the same aperture so no masonry work is required. We can also provide stainless steel panels with illuminated name windows or illuminated buttons. Panels can also be powder coated in a range of RAL colours to suit the specific design requirements of an architect or designer.

Brass versions also available

Brass equivalents of the VR-Inox range are also available. Surface versions have a complimentary hardwood surround.



■ Brass panel, surface mounted with exotic hardwood surround

Digital technology for reduced cabling requirements

Dig-Inox system

Up to 2 entrances

The Dig-Inox system is the next step into digital systems and increases the capacity up to 240 users. The Dig-Inox system still uses the “1+n” audio handsets for audio systems and “5-wire” brackets for video systems. The same connections exist in the riser with the addition of a pair of wires for the data bus to the 10-way decoders.

These decoders are the key to the system as they decode the digital signal from the panel and direct the call to the required apartment. The same decoders are used for audio and video systems, so it is possible to mix audio and video door phones on the same riser/panel.

They also distribute the video in video systems so no separate video distributors are required, keeping cabling as simple as possible. The decoders also mean that Dig-Inox systems are “isolated” as each apartment is connected to a separate switched output on the decoder. This means any fault in one apartment has no effect on the rest of the system.

Dig-Inox systems can manage multiple entrances and perimeter panels with the use of 2-door switchers. Calls are made either by typing in apartment numbers or scrolling through a list of apartments in the directory.

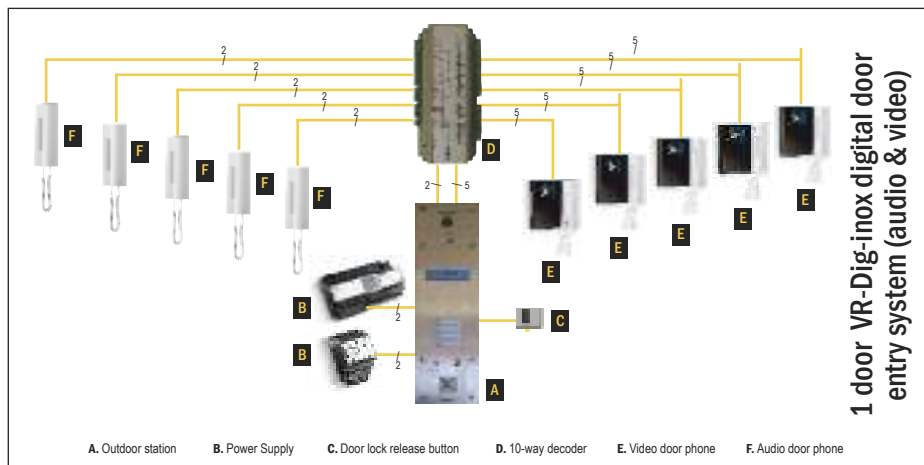

Capable of withstanding
any environment

Vandal Resistant Digital Panel Range

VR Dig-Inox Panels

The VR Dig-Inox range of audio and video digital dial entry panels provides a stylish and vandal resistant solution for the larger blocks of apartments where a functional panel would become too large. The panels are manufactured to marine grade 316L Low carbon stainless steel and have a brushed finish. They use the same trusted “5-wire” video technology and “1+n” technology for audio systems as the rest of the range but utilises 10 way decoders that can be located up the building. The decoders use a separate data bus to switch the call to the required apartment providing complete isolation of the apartments when not in use.

The call module in the panel can handle calls to up to 240 apartments and callers can scroll through the directory or enter the apartment number and press the call button using the 16 button blue backlit keypad. This keypad can also be set to act as a coded access keypad to allow residents keyless access to the building. Instructions and status messages are displayed on the blue LCD display to communicate with the caller. The panels features a “busy” LED which informs the caller if another call is in progress on the same riser from another entrance. A “trades” button is also included to allow connection to a time clock for timed access for services and trades.

The panels have a robust acrylic camera window and speaker protection grille that protects the audio/video call module inside the panel and still allows excellent image and speech quality.

Video image quality is maintained even in poor lighting conditions due to built in illumination LEDs (infrared on mono-chrome systems) and the panel is supplied with anti-tamper screws to prevent unauthorised persons opening the panel.

Panels are available either as flush fitment or surface fixed and can have a 40mm x 40mm cut-out to allow integration of an access control proximity reader. The surface hoods are also manufactured from stainless steel, have a cable entry hole in the rear and incorporate a rain hood. Flush back boxes are made from galvanised steel and also have a cable entry hole at the rear.



Busy indication
and trade buttons



Blue LED backlit
keypads



Large blue LCD display



Optional proximity
reader cutout

Meeting all current
dda legislation

Vandal Resistant Digital Panels

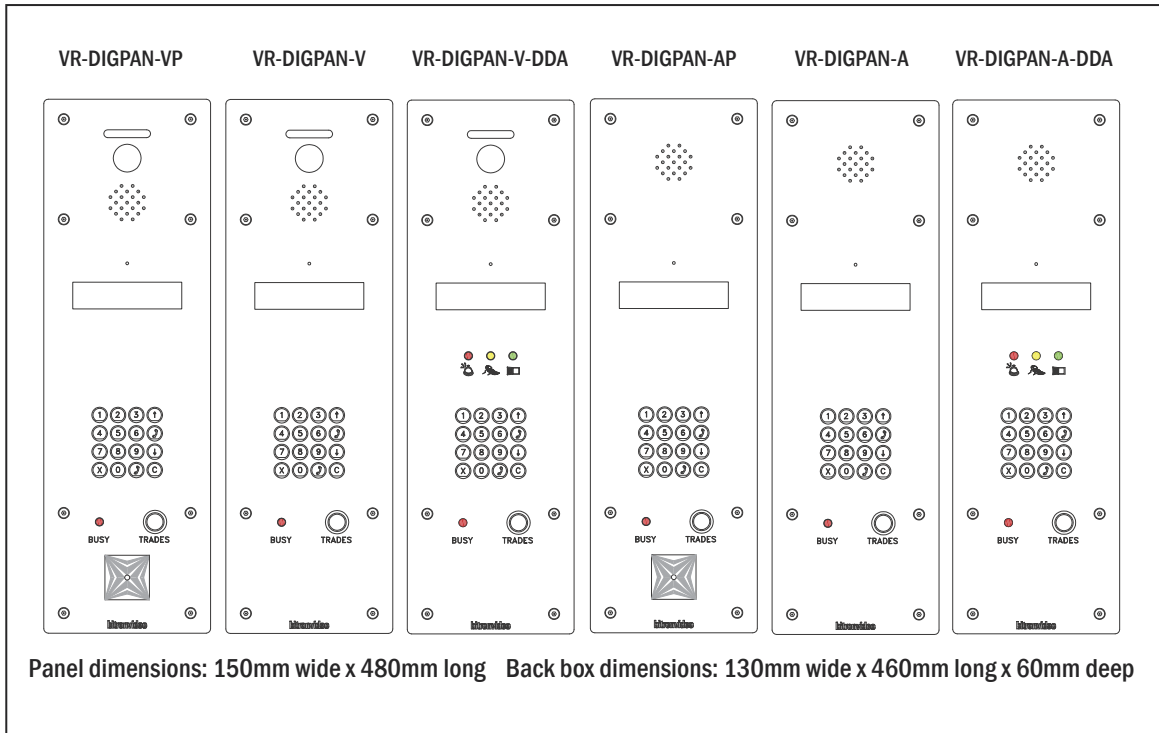

DDA Dig-Inox Panels

A DDA version of the VR Dig-Inox panels is also available on request. This has additional features that make it easier to operate for people with impaired hearing or vision. It has three bright LED indicator lights on the panel, each permanently engraved with a symbol to indicate that the call is in progress, when a call is answered and a door open symbol for when the lock release is triggered.

A synthesised built-in voice module also gives audible instructions to callers with impaired vision (see diagram).



multiuser microprocessor
technology

Up to 16 Entrances =
6 Main & 10 Inner

MDK digital audio and video doorphones

Up to ten thousand users, with multiple digital inputs, using a very low number of common wires. Possibility of creating mixed audio and video doorphone systems.

The MDK digital microprocessor audio and video doorphone systems are designed to make systems with a higher number of users employing a very low number of common wires. Up to ten thousand users can be connected to the system with only six wires in column and two wires for connecting each doorphone. Alternatively, 10 wires can be used in the column with only 5 wires for connecting each monitor. This can be used to make special systems with several digital entrances without switching devices and with 'busy function' for up to six main entrances and ten secondary entrances. Furthermore, mixed digital systems can be made, with main digital entrance and secondary analogue traditional entrances. The particularities of MDK digital systems, such as the timed door opening code, messages and the possibility of programming either remotely or via a PC, anticipate the Building Automation functions of the future. Now available with Domular-Classic type panel or with a stainless steel VR panel.

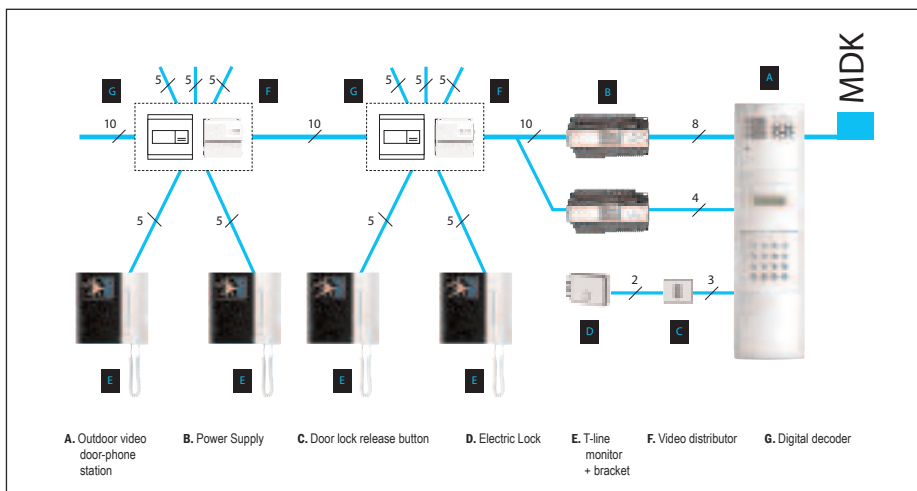
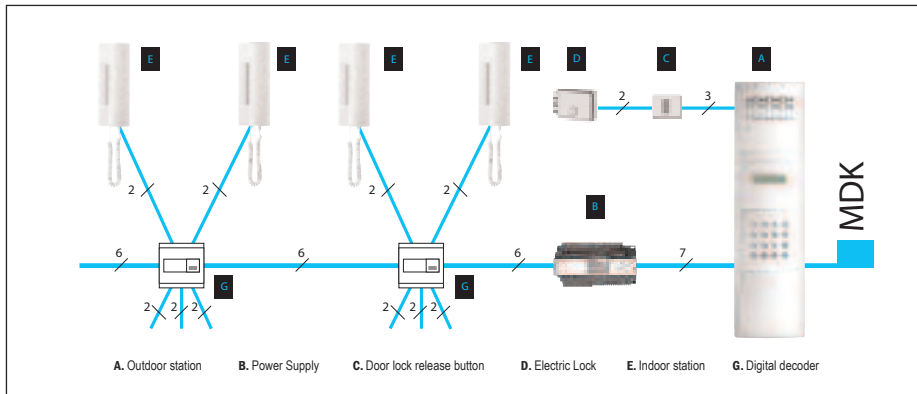

Tline

Audio handsets

The T-line doorphone features slimline design and excellent finish. The standard doorphones feature an auxiliary service button that can be used to operate other devices such as stairwell lights or automated gates. Manufactured from ABS shockproof plastic.

There is a version that also features a door open indication LED and a supplementary button extension can be added for intercom function.

Our universal h/set replaces
95% of all audio h/sets
(1+N 4+N 2 & 5 wire systems)
See website www.bitronvideo.co.uk for
compatibility details

Additional button module allows up to
7 audio h/sets to be configured for
intercom function (4+N, 1+N only)



code	description
AV1407/001	T-line 4+n doorphone
AV1407/002	T-line 1+n doorphone
AV1407/003	T-line 4+n doorphone with additional service and switch-on button
AV1407/004	T-line 1+n doorphone with additional service button call tone mute and mute indicator
AV1407/102	Eurobus decoder board for T-line doorphones (required for AV1407/002 and AV1407/004 doorphones for Eurobus systems)
AV1407/010	T-line universal doorphone with additional service button
AV1407/021	T-line doorphone for 2 wire audio kits
AV1407/050	Additional module with 6 buttons, 1 switch and 2 LEDs for T-line audio or video doorphones
AV1407/051	Additional module with 6 buttons, 1 switch and 2 LEDs for B-Fast T-line audio or video doorphones
AV1407/100	T-line secrecy device for 4+n doorphones
AV1407/200	T-line doorphone table top assembly base in clear plexiglass
AK7034	12v AC mechanical buzzer for T-line doorphones



a slim style with an elegant appeal

T-line

Video handsets

T-line doorphones and video doorphones: a new, refined and slender line with a technology that offers such a widely versatile range that can be adapted to any type of system. The original and still unique T-line product range attracts the most selective and exclusive tastes. This unmistakable range created by Francesco Trabucco, the internationally famous designer and architect, skillfully blends into the surrounding environment.

Elegant, linear and minimal, T-line video doorphones add light and charm to a room. In addition to being attractive, they are capable of combining two very different needs: the needs of users who want an audio system only and the more demanding requirements of users who want a video system with a high definition 4" TFT colour display.



Feature: Now with induction loop as standard.



code	description
Video Monitor/Handsets	
AV1423/001	T-line 4" B&W video doorphone with status LED, call volume adjustment, mute function with indication and 3 service buttons- requires bracket
AV1423/002	T-line 4" colour video doorphone with status LED, call volume adjustment, mute function with indication and 3 service buttons- requires bracket
AV1423/010	T-line monitor bracket for 5 wire video kits
AV1423/15	T-Line Monitor Bracket Btwin Systems
AV1423/013	T-line monitor bracket for Co-ax video systems
AV1423/012	T-line monitor bracket for Eurobus systems
AV4161/103	T-line monitor bracket for 2 wire video kits
AV1423/202	Tabletop assembly kit for T-line video doorphone, clear plexiglass
AV1407/050	Additional module with 6 buttons, 1 switch and 2 LEDs for T-line audio or video doorphones.
 AV1423/007	Replacement handset for T-Line audio and video phones with induction loop for the hard of hearing for older T-Line models.

T-look hands-free monitor
providing simplicity, with style

TLOOK

Bitron Video again presents design, entrusted to the architect Francesco Trabucco, in the new hands-free T-look video doorphone. Its slim line matches the shaded polycarbonate casing of the liquid crystal monitor and continues for the whole length of the video doorphone. Extremely thin (220 x 124 x 38mm in the wall mounted version), the new T-look hands-free video doorphone can also be used for embedded installation, thanks to a simple kit, with a thickness of barely 16 mm.

Ideal for all styles and all systems, hands-free T-look adapts to all systems (5 wires, Eurobus, B-fast) thanks to a practical system of brackets for immediate installation.



code	description
Hands-Free Monitor	
AV2850/1	T-look colour hands free video doorphone with TFT 4" display
AV2850/50	5 wire bracket for T-look hands free video doorphone
AV2850/60	Embedding box for T-look hands free video doorphone
AV2850/61	Plasterboard fixing kit for AV2850/60
AV2850/56	Wall mounting connector for T-Look monitor. B-Twin installation.

A wide selection of styles for every application

Surface mount as standard, or Flush with embedding box

Tline

With the new T-line panel, design makes way even outside the building.

Sophisticated and modern, the panel attracts attention firstly for its extra slim proportions: only 190 x 100 x 36 mm. The perfectly blended blue backlighting is an original solution for both the video and audio versions. Furthermore, the name tags are particularly large meaning that longer names can be written. The panel may be easily wall-mounted or fitted on 100mm wide pillars.



■ AV1878-10



■ AV1878-12



■ AV1878-20



■ AV1878-22

Audio solutions for
houses and villas

T-line

AudioEntry Kits

We have created a range of kits which should satisfy most requirements for door entry systems.

The kits can easily be customised to additional entrances, more than one handset per call button or to add access control elements such as access control readers. The kits come complete with panel, handsets, power supply, fixing and full instructions.

Villa Audio Kits

A solution for all doorphones and video doorphone needs, with one and two buttons, for all system types

Bitron Video's villa kits are ideal for one- and two-family buildings, the comprehensive product range includes various stylish solutions, all cutting-edge and customisable, with a view to simple installation: replacing an old bell system with a modern, high-tech, audio kit is quick and easy.

The T-line kit includes the new T-line panel and the new range of T-line doorphones.

T-line panels: The new T-line panel design with the blended blue backlighting is a perfect solution for both the video and audio versions.

M-inox panels: Made of stainless steel, the M-inox audio panel is a high-tech and versatile panel providing reliability of use even in the worst weather.

Domular Classic Evolution panels: The unmistakable Domular Classic Evolution embedded panel comes in sleek aluminium and has a very high level of waterproofing. The speakers are made of Mylar and are also weatherproof.



code	description
Basic Kits	
AV2058/51	T-line audio kit for one family (includes AV1407/001 4+n doorphone)
AV2058/52	T-line audio kit for two families (includes AV1407/001 4+n doorphones)
AV2066/21	T-line audio kit for one family (includes AV1407/002 1+n doorphone)
AV2066/22	T-line audio kit for two families (includes AV1407/002 1+n doorphones)
AN9920/LT	Domular Classic Evolution audio kit for one family (includes AV1407/001 4+n doorphone) with flush mount entry panel

Video solutions for
houses and villas

T-line

Video Entry Kits

As with our audio kits, our UK video kits will satisfy most requirements for smaller video systems. They come complete with all the necessary system components, including video distributors, power supplies, fixings and full instructions.

Villa Video Kits

Bitron Video's video villa kits come with a choice of mono or colour camera's in the T-line panels. The video doorphone can be hands free or traditional handset type. There are two wire video kits where cables are in place, such as replacing a bell on existing cables.



■ AV1423/002



■ AV4161/1



■ AV4179/VT1



■ AV4179/61

code	description
Basic Kits	
AV4179/51	T-iine 5 wire B&W video kit for one family (includes AV1423/001 & AV1423/010 videophone/bracket)
AV4179/61	T-line 5 wire colour video kit for one family (includes AV1423/002 & AV1423/010 videophone/bracket)
AV4161/	T-line 2 wire B&W video kit for one family (includes AV1423/001 & AV4161/103 videophone/bracket)
AV4161/2	T-line 2 wire colour video kit for one family (includes AV1423/002 & AV4161/103 videophone/bracket)
AV4179/VT1	T-line Swire colour video kit for one family (includes AV2S50/1 & AV2850/50 hands free video doorphones/brackets)

Psu's, door entry accessories and switchboards

As well as the standard control equipment, we have a range of accessories and modifications to enable additional features over and above standard door entry functions.

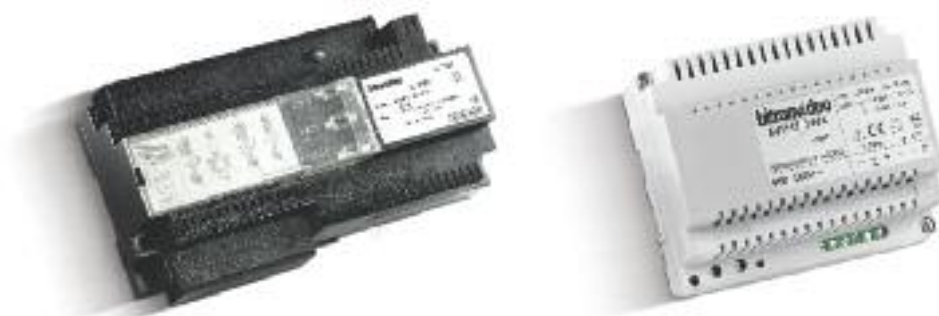

code	description
Power Supplies	
AN1299	12v AC transformer PSU-Acc
AV1142	A3000 audio PSU with tone generator for floor call (14.5v AC & 8v DC outputs)
AK5053	PSU for audio/video systems and intercom systems with AK5343 relay
AN1349	PSU for audio systems with intercom - integrated relay
AV7362	Video PSU with supplementary integrated services relay
AN5498	PSU for additional monitor
AV2900/303	Video PSU with lock output relay
AN9326	Auxiliary PSU for AV7362 where remote camera is used
AV4161/102	Video PSU for 2 wire video kits
AV4179/101	PSU for 5 wire video kits
AN1364	14.5v AC transformer for Eurobus systems/concierge switchboard
AN9680	AD80 PSU for MDK systems
AN7429	A700 MDK PSU for switchboard and supplementary digital inputs



Relay Boxes	
AN7775	Doorphone relay box for 2 audio/video panels (5 wire and 1+n)
AK5343	Doorphone relay box for intercom applications (4+n) to be used with AK5053 PSU, or to be used as 4+n two door switcher
AN0614	Universal relay with 4 sets of contacts, useful for lock switching
AN5621	RC60 call repeater, required when 4 or more h/sets to be called at once
Distributors and Decoders	
AK7513	SD55 floor video distributor - 4 way (5 wire / Eurobus)
AK7547	SD59 column video distributor (5 wire / Eurobus)
AN7734	5 user decoder for MDK systems
AN7742	24 user decoder for MDK systems (no suitable for concierge system)
BV-040-041	10 user decoder / video distributor for Dig-inox systems
AV1407-102	1 user decoder for Eurobus audio systems

code	description
Auxiliary Ringers / Extension Sounders	
AN7817	Auxiliary ringer for audio and video doorphones
AN7759	Auxiliary ringer for 1+n and 5 wire audio and video doorphones powered by 9v battery
AV9988/001	Echo 1 wireless call repeater - battery powered
AV9988/Kit	Wireless extension sounder with strobe kit, battery powered, includes transmitter board
AV9988/008	Echoflash Rx - mains powered
Miscellaneous	
TS2000	7 Day programmable digital timeclock for trades facility (used in conjunction with AN0614 relay)
TP1	Trades pack for Classic and T-Class systems, includes digital time clock and relay box
VR - Trades Surface	VR-Inox Trades pack for surface panels, includes digital time clock
VR - Trades Flush	VR-Inox Trades pack for flush panels, includes digital time clock

SEAL-Bit RTV 200 GEL

2-component silicon rubber gel

Seal-Bit Super IP waterproofing gel

AV9996	SEAL-Bit RTV 200 two component transparent silicone gel kit - 1 kg
AV9996/002	SEAL-Bit kit 0.2kg



SEAL-Bit RTV 200 GEL

The innovative Seal-Bit RTV 200 GEL (AV 9996) is a 2-component silicon gel. Rightly dosed and poured inside whatever watertight housing, it firms up making the junction perfectly watertight.

Applications: doorphone systems, video doorphone systems, telephone systems, outdoor lighting systems.
Advantages: water resistance, transparency, atoxicity, fast application, possibility of later maintenance and restoration.

Technical Description

Description:

Material: AV 9996 - *Seal-Bit* RTV 200 is a 2-component (A+B) silicon rubber, vulcanising at ambient temperature.

Physical Features:

- ✓ Water resistant
- ✓ Easy to use (Fig. 3)
- ✓ Easy-pouring
- ✓ Transparent (Fig. 4)
- ✓ Short detachment time

Technical Features:

Components appearance:	A e B are colourless
Pot life:	<10 minutes (*)
Hardening time:	<30 minutes (*)
Set status:	Gel (Fig. 5)
Volume reduction:	<0,1%

(*) Higher temperatures reduce working time and polymerisation time.

Lower room-temperatures act adversely.

Simplecase

Installation of analogue systems is simplified with the use of the Simplecase

Simplecase has been designed to make installing Bitron Video analogue audio and video systems simple.

Simplecase ensures a neat installation whilst also greatly reducing time on site. Available in two sizes Simplecase1 for analogue audio systems up to 1 entrance 8-way + trades and Simplecase 2 for analogue audio and video systems up to 2 entrances 16-way + trades.

Installation is made simple by using the Simplewire connection board. This allows all connections including speech, lock release, ground, video power and the call line to be made individually providing simple isolation of each handset/monitor. Each connection is made using clearly marked robust rising clamp screw terminals.

Recommended
for NEW
INSTALLATIONS



Lockable, removeable lid



REMOVEABLE
Simplewire PCB
connection board



Simplewire connection
board for connections
including speech, lock
release, ground, video
power and the call line



Din rail mounting for
power supplies and relays

Simplecase 1 standard features

- Bitron Video analogue audio systems up to 1 entrance 8-way + trades
- Neat installation guaranteed
- Greatly reduces time on site
- Robust 1.2mm Zintec coated steel construction
- Removable lockable lid
- Simplewire connection board with clearly marked rising clamp screw terminals
- 200mm Din rail fitted with end stops for power supplies and relays
- Mounting points provided for Bitron Video TS2000 trades clock
- Separate cable entry points for LV and ELV connections
- Push on earth lead

Simplecase 2 standard features over Simplecase 1

- Bitron Video analogue audio/video systems up to 2 entrances 16-way + trades (requires additional Simplewire connection board)
- 340mm Din rail fitted with end stops for power supplies and relays
- Mounting points provided for 4 video distributors

The Simplecase is supplied with a removable, lockable lid for simple mounting and connection. Din rail is fitted as standard allowing quick mounting of system power supplies and relays, fixing points are also provided for video distributors (Simplecase2) and the Bitron Video TS2000 BST digital time clock. Separate cable entry points for LV and ELV connections and a push on earth lead are also provided.

Simplifying door entry installations
and saving you time

Simplecase

Sample installation using Simplewire connection board for audio or video systems

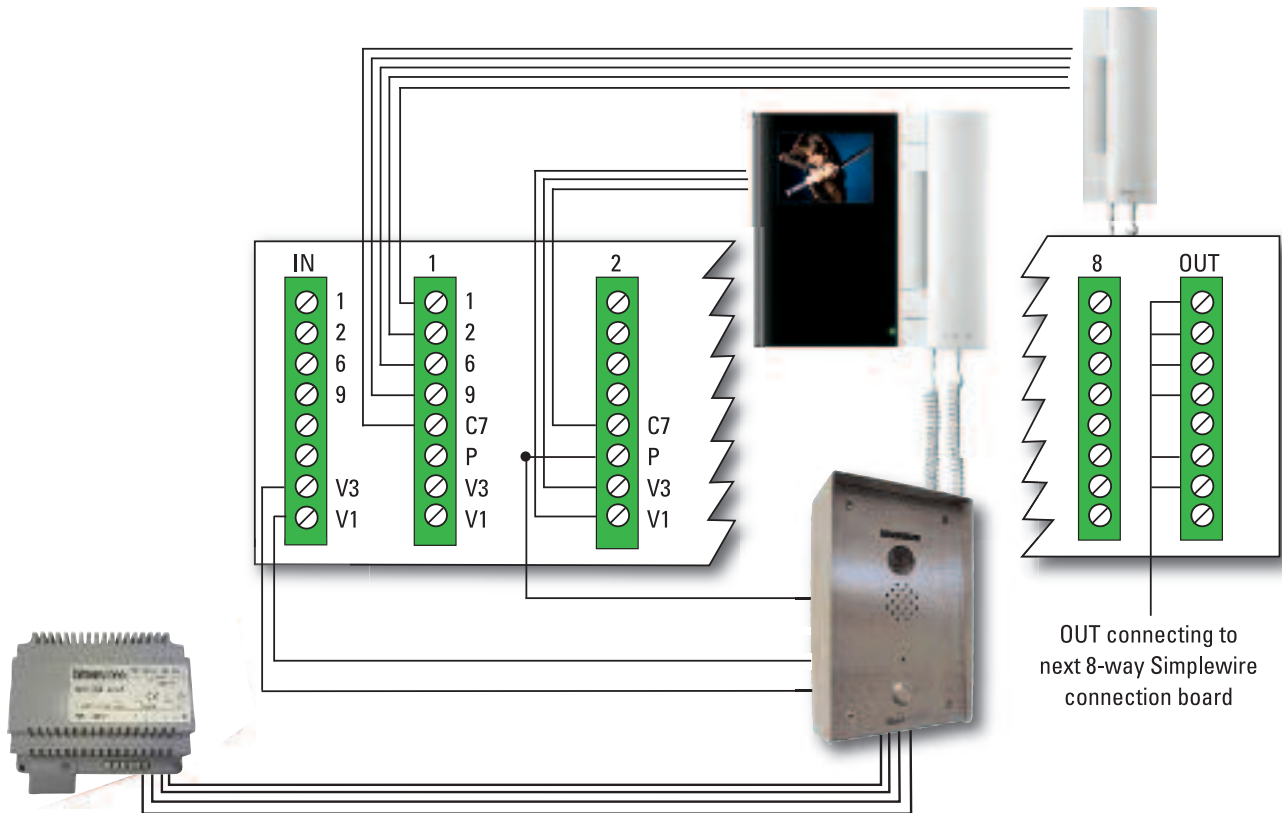

Simplecase 1 shown with power supply and trades clock fitted



Simplecase comes with complete fixing kit, all screws, fittings, lock and keys



Simplecase 1 standard features Bitron Video analogue audio systems up to 1 entrance 8-way + trades

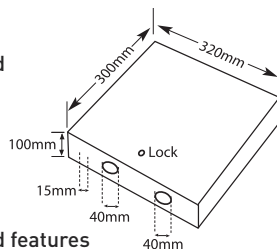

Simplecase 2 standard features over Simplecase 1

Bitron Video analogue audio/video systems up to 2 entrances 16-way + trades (requires additional Simplewire connection board)

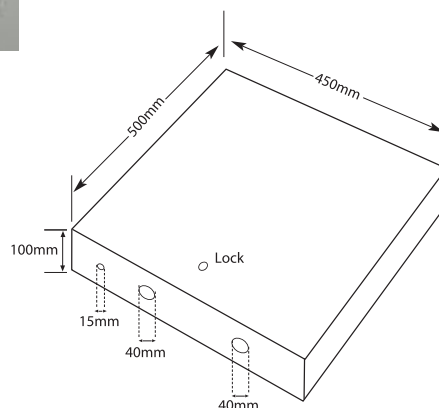

Platel Telephone Entry Panels

The Platel entry panels are a self contained 1000 user telephone entry and access control system, with or without video. It is ideal for a residential block of apartments where the cabling for a standard Door Entry is not possible or would prove very expensive. A dedicated telephone line and power supply is all that is required.

The panel is programmed with a telephone number for each resident (landline or mobile). The panels with video allow images from the camera in the panel to be modulated onto the apartment blocks' TV distribution system. This means if a resident wants to be able to see who is calling, they can use their TV remote control to selection the channel the panel camera is on.

The panels also include a keypad for coded access and proximity reader for proximity access control. System administration, including number changes and deleting/adding proximity fobs can carried out remotely by dialling into the panel from a computer with the Platel software via a dial-up modem.

GB-601-076 and GB-601-077

PLATEL panels standard features:

- Stainless steel (2.5mm thick).
- Work with all phones included cellular.
- Capacity of 1000 users with call number, 2 phone numbers, 1 keypad access code and 1 proximity key each.
- 3 relays.
- Mifare 40x40 proximity reader.
- Flush mount back box included -
Dimensions : 410mmx155mmx60mm.
- Visual and acoustic call progress indication
«CALLING», «SPEAK NOW», «ENTER».
- Integrated visually impaired user help to comply with DDA act.
- Wiring: 2 wires for PSU, 2 for phone line, 2 for lock and 2 for RTE push button.
- Needs an analogue telephone line.
- Power supply from 12 to 24VDC or VAC.
- Optional surface mount back box rain hood
(part number 60-030-266).



code	description
GB-601-076	Platel VR panel flush with graphical display and built in 1000 user single door proximity 380mm x 190mm.
GB-601-077	Platel VR panel flush with graphical display and built in 1000 user single door proximity 460mm x 190mm.
GB-60-030-266	Platel VR surface mount backbox supplied with rain hood.



PSTN entry panels

Specific features available via Platel software. Supplied with panel.

- **6 Time profiles.**
 - => Door Time Profile: Free access at certain times for specific doors.
 - => Resident Time Profile: time profile for names displayed on the panel.
- **Event management:** 30,000 last events saved such as «door open» «door forced» and communication time.
- **Recall** towards second number or the concierge in case of no answer or when the line is engaged.
- **Night mode.** After a certain hour, calls transferred directly to the second number.
- **Self activation.** It is possible to call the entry panel, enter a password and then start a conversation or command a relay.
- **Door contact:** detect when a door is open for too long and send a voca message to the concierge.

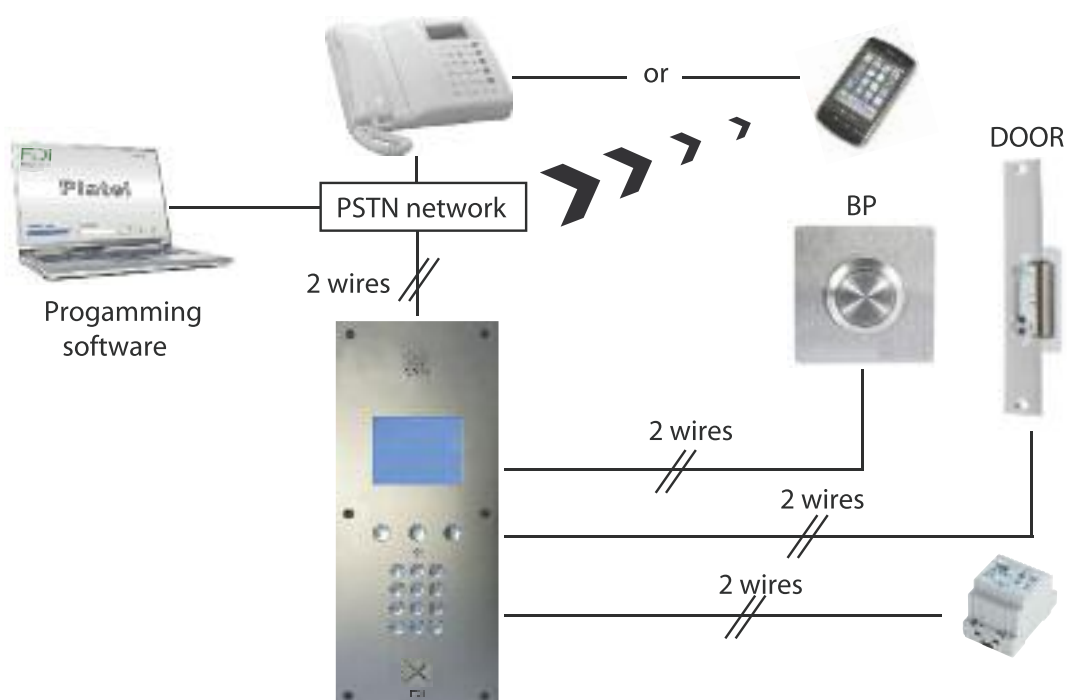

telephone entry solutions

Alpha+ Interface

Alpha+ Telephone Interface for PABX systems is an ideal solution for offices, other commercial premises or large houses that have PABX telephone system and want to add an entry panel.

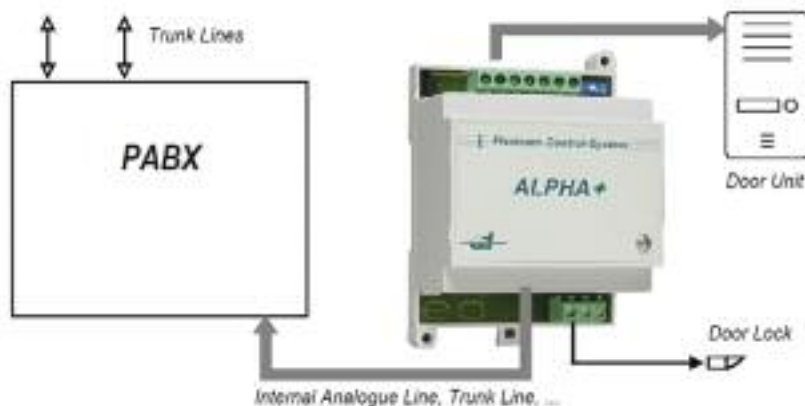

The Alpha+ telephone interface can be interfaced with most PABX telephone systems.

It serves to connect the audio from a door entry panel to a telephone on a PABX rather than a dedicated entry system handset. It can be set to ring any extension or calling group on the PABX, including cordless DECT phones to give a new level of mobility and flexibility. The call from the entry panel is answered on the telephone and two way speech is initiated as with a dedicated entry system handset. The door can be released by pressing ** on the telephone keypad.

There are many applications for this system including people with reduced mobility or personnel that are mobile in and around a premises. As an added feature, a call that is not answered within a pre-determined time can be diverted to a outside telephone number. This enables a call to be sent off site to a remote telephone when there is no user on site.



Compatible with the full range of Bitron Video audio entry and video entry panels including our vandal resistant range, special DDA panels or the standard Domular Classic or TClass modular panels.

code	description
ALPH+	Telephone interface for PABX systems
FL/RS+	Programming interface for Alpha+ module
ALPHA4P	Multiple entrance extension for ALPH+ Module (Max 4 entrance)

Telephone Entry

Telephone entry differs from standard door systems in that there is no dedicated doorphone or video doorphone. The call from the entry panel is sent to a standard telephone within the property or even to a residents' mobile phone. The benefit of these systems is that there is very little cabling which can mean big savings on installation costs.

However, in some instances there may be significant call charges and line rental for outgoing calls. The telephone interfaces may only ever make internal calls within a property so no charges are incurred. The option to utilise existing telephony gives us more possibilities to offer solutions to various site requirements.

Telephone Interfaces

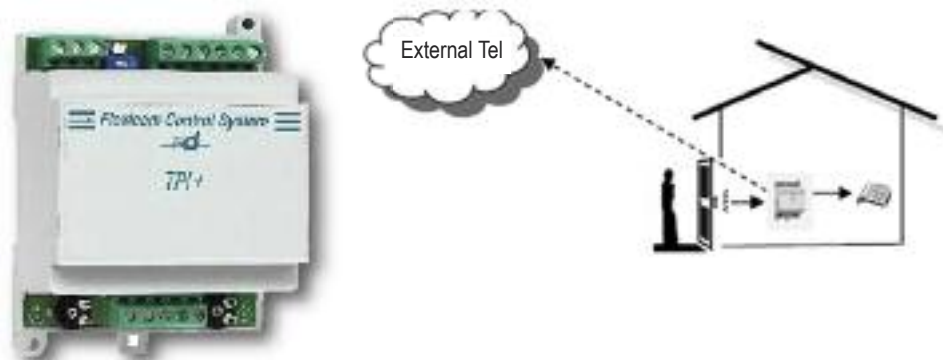

TPI+ Interface

This unit is ideal for a home or a business premises with standard landline telephone (i.e. no PABX is required) where they wish to take calls from an audio entry panel without having an additional handset just for the audio entry system.

An added benefit is the diversion feature; if the call is not answered within a pre-set time period, the unit can be set to divert the call, using the telephone line it is connected to, to another pre-programmed number (landline or mobile).



TPI+ Telephone Interface for Standard telephone/PSTN Lines

Compatible with the full range of BitronVideo audio entry panels (4+n) including special DDA panels or the standard Domular Classic or Domular 3000 modular panels.

Can be interfaced to any home telephone including cordless DECT phones to give a new level of mobility and flexibility. There are many applications for this system including people with reduced mobility or personnel that are mobile in and around a premises.

As an added feature a call that is not answered within a predetermined time can be diverted to a third party. This enables a carer or caretaker to be alerted of any possible on site problem.

FDi

FDI MATELEC is specialised in designing and producing access control solutions.

The company manages projects from R&D level to the production and sales. Through its use of up-to-date technology and highly skilled and experienced people, FDI MATELEC has made it to the forefront of access control manufacturers for residential and industrial applications.

Our product range provides dedicated solutions to small single-site installation as well as large multi-sites networks.

www.fdi-access.co.uk

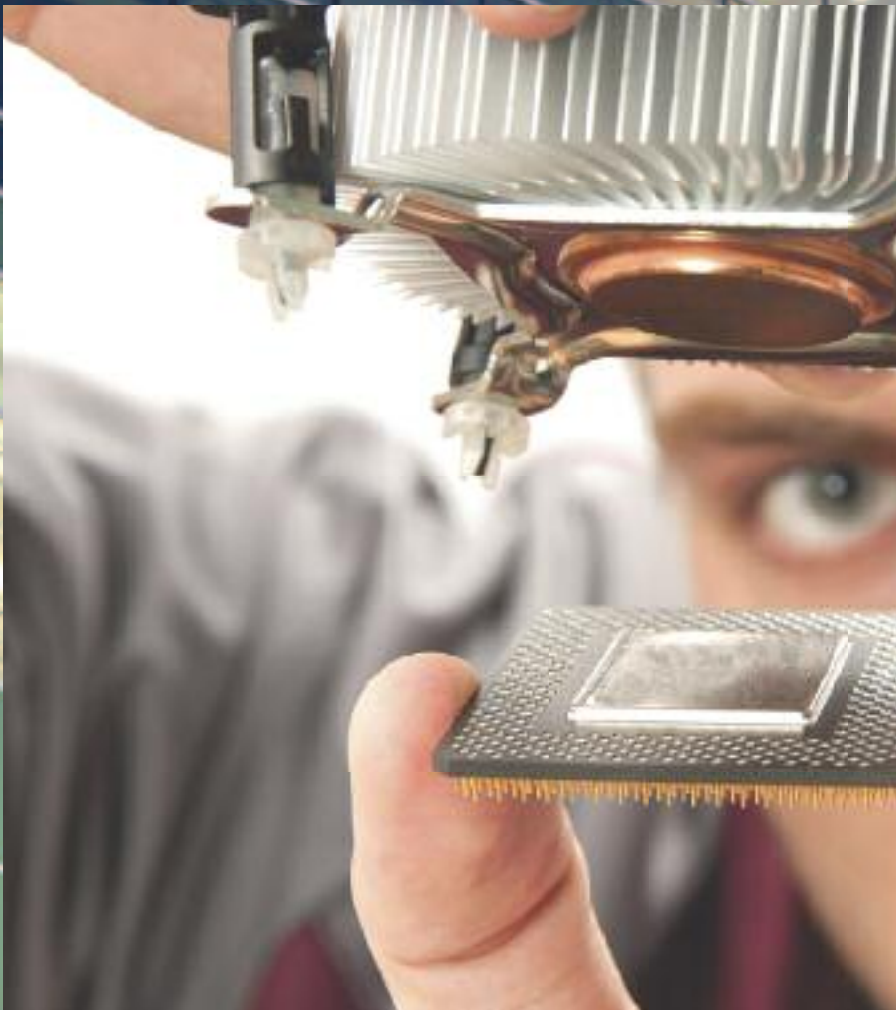

FDI Access Control Specialist

Over the past several years, FDI has forged a relationship based on trust with these British distributors, which is enabling the company to become established in the UK on a long-term basis.

FDI is committed to a zero-defects approach to quality. In addition, the company is ISO9001:2008-certified. At every stage of the manufacturing process, each product is inspected in order to isolate, analyse and discard any defective parts.

What is access control:

Access control systems allow authorised persons, residents or employees, to gain access to a building without the use of a mechanical key. It can be installed alongside audio or video door entry systems with keypads or proximity readers integrated into entry panels or independently with a mullion or vandal resistant reader. This is usually required in residential buildings with multiple residents where managing normal keys would be expensive, time consuming and less secure.

Access control is also an integral part of many buildings in the commercial sector; offices, warehouses, factories and other commercial properties all need to secure their premises from unauthorised entry and restrict staff and visitors to certain areas within a premises. The main methods for gaining entry to a controlled area are:

- Proximity token/card
- RF remote
- Access code
- Biometric reader (fingerprint)



Our range is divided into **THREE** categories: **STANDALONE**, **NETWORK SYSTEMS** and **VIRTUAL NETWORKS**, offering a solution for each type and size of project.

1. STANDALONE

- EASYDOOR CONTROLLER - TRANSIT

Ability to work without any operator supervision to grant or deny access. The controller just needs power and initial programming to work alone. These systems are usually found in smaller residential schemes.

2. VIRTUAL NETWORK

- EASYDOOR CONTROLLER - VITWO READ & WRITE - MICRO LE

Products based on the principle of reading and writing. They have some of the benefits of both traditional methods of Standalone & Network systems. Thanks to this technology, it is no longer necessary to connect the controllers physically in order to manage access controls centrally and remotely.

The concept for a Read & Write system is quite different from the previous system types, in that information is actually encoded onto the proximity fob or card. When the fob/card is first presented to a reader on the system, it enrolls itself on the controller.

Advantages of the System

Therefore there is no need for the installer to go on site in order to manage the proximity key. It's like a networked system but without the expense of cabling the data network or providing a TCP/IP connection at the site. This type of system is ideal for managing multiple residential blocks to be administered centrally.

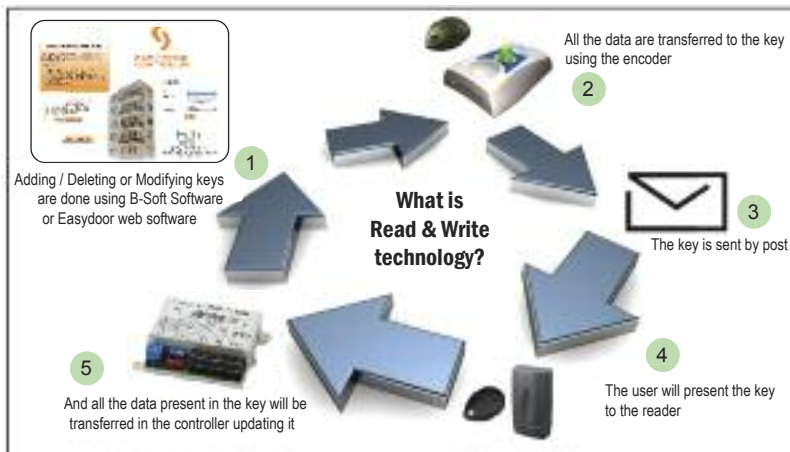

3. NETWORK SYSTEM

- PASSAN

Network system means that all doors can be managed together from a same location in using a software. FDI developed Passan allow you to administrate instantly your access control on site or off site using modem or IP connection. Larger systems with many doors and users can be programmed and managed by one PC.

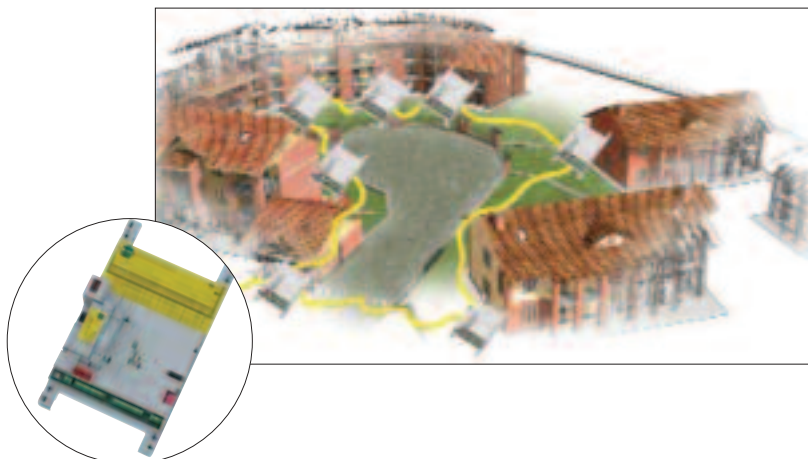

Easy Door System

STANDALONE MANAGEMENT

By master key in 3 steps

- 1 Swipe the master key to start programming.
- 2 Enrol the residents' keys by swiping them.
- 3 Swipe the master key to end programming.



Standalone



or



Virtual Network

Easydoorcontroller (Read & Write)

Through its strong collaboration with various players in the sector, FDI has successfully developed new systems that respond to the technological challenges of our time.

Easydoorcontroller: a new, more efficient concept

With the help of Easydoorcontroller web software, FDI's clients can program their access keys directly via the internet with an encoder connected to their computers. The keys themselves will transmit information about access profiles and door programming to the controllers. As a result, there is no need for the installer to go on-site in order to remove (or add) more badges or keys.

What advantages does this type of system offer?

Firstly, FDI's system allows for time savings concerning installation. When installing a traditional network-access system, each controller must be wired to a single network in order to manage the access-control system.

Why use web software?

With the Easydoorcontroller web-based software, there is no need to install computer software on the client system. An internet connection is the only thing required. Time is saved, and compatibility issues, linked to operating systems or software, are avoided. Keys are simply registered and programmed at www.easydoorcontroller.com.

In addition, if a computer is lost, stolen or has technical issues, site data will not be lost, because it is stored on the FDI server: FDI automatically backs up client data, allowing for the 20 most recent backups to be recovered. In the event of an operator error, for example, previously saved data can easily be recovered.

How is a key programmed?

Keys are programmed using an encoder connected to the client's computer. No installation is required, as a plug-and-play system is used. Data concerning the access rights of various users is transferred directly to the keys, which will then transmit this information to the on-site controllers. Sites can therefore be programmed and managed from the comfort of the office or the home. The client no longer needs to return to the site for any type of programming; he (or she) must simply send the keys to their recipients at the premises.

How can one (or more) key(s) be removed?

In order to remove a key (or keys), or to change access profiles, the client merely needs to visit www.easydoorcontroller.com and alter the key-related data on the internet platform. The client will then encode a key using the encoder connected to his (or her) computer. Once this key has been used on-site, the information will be sent directly to the various access controllers.

READ AND WRITE MANAGEMENT

Via the internet



Specifications of standalone controller or controllers/readers :

- Technology : 13.56 MHz Mifare
- Users : 5000 in read and write / 1500 read only
- Output: 1door
- Key programming : on www.easydoorcontroller.com with an encoder or on site with a master key in read only
- Power supply : 12/24Vac or Vde
- 2 wires to reader: up to 20 meters (FTP cable)
- Control relay NO/NC
- Adjustable time delay from 0,1 second to 99 seconds
- Removable terminal connections
- Operating temperature : -20°C to +70°C
- Relay: Normally Closed / Normally Open
- Self diagnosis via on-board LEDs
- Large range of readers all in one (plug & play)



Easydoorcontroller Read & Write

CONTROLLER

code	description
GB-140-052	Easy Door Controller alone



CONTROLLER & READER All in one

GB-140-058	Flush Mounted reader + easydoorcontroller all in one
GB-140-059	Surface Mounted reader + easydoorcontroller all in one

READERS

GB-020-122	Mullion reader Easy Door Controller
GB-020-123	Vandal resistant surface mount reader Easy Door Controller
GB-020-126	40 x 40 panel mount reader

KEYS

AV0151/012	13.56 MHz proximity fob for use with Ciprox, Vitwo, Micro LE & EASYDOORCONTROLLER
------------	---

Coloured proximity tokens

FD-010-010	Key 13.56MHz black
FD-010-027	Key 13.56MHz white
FD-010-028	Key 13.56MHz blue
FD-010-029	Key 13.56MHz red
FD-010-030	Key 13.56MHz green
FD-010-078	Key 13.56MHz yellow
FD-010-081	Key 13.56MHz orange

ACCESSORIES

GB-500-045	USB Encoder + cable
------------	---------------------

Standalone System

Transit

TRANSIT is a standalone controller which can control up to 2 doors. Controllers have a useful removable backup memory making programming of multiple controllers simple. Transit has a built in RF receiver allowing FDI dual technology combined proximity and RF tokens to be used for controlling access of a gate/barrier. Installing the Transit allows the integration of automation and door access into one simple control system ensuring site security.

To program Transit, only three buttons are needed, and to set up easily the lock time release from 0 to 99 seconds, password, monostable or bistable contacts and the relay Normally Open or Normally Closed.

Transit is suitable for private homes or residences which need a reliable and easy-to-use access control system to control one remote access (gate, car-park) and / or one pedestrian access (front door, main entrance).

- Technology: 125 KHz / 433 MHz
- Users: 999
- Output: 2 doors
- Programming: on site
- Power Input: 12Vdc or Vac, 1A
- Built in internal management reader
- Easy to program with LED display
- Simple to install 3 wires to reader
- Useful removable backup memory for simple programming of multiple controllers



The Transit controller is compatible with full range of 125KHz proximity readers and has the RF receiver built in.

CONTROLLERS

code	description
GB-100-021	Stand Alone Transit Controller 2 Doors, 999 Users, Proximity or RF Technology. Built in Enrolment/Management Reader.

READERS

FD-020-080	Mullion reader 125 KHz for use with Transit controllers
FD-020-084	VR mullion reader 125 KHz for use with Transit controllers
FD-020-006	VR panel mount reader 125 KHz for use with Transit controllers

KEYS

Proximity key & card:

FD-010-012	125 KHz proximity fob for use with Transit & Passan systems
FD-010-070	125 KHz proximity card for use with Transit and Passan systems DUAL Technology proximity & RF Key
GB-010-015	125 KHz and 433 MHz combined proximity and RF fob for use with Passan & system

ACCESSORIES

GB-500-025	FDI Transit/Passan extension antenna kit, 433 MHz
------------	---



POSSIBLE CONFIGURATIONS

Building Access 1



Front Door (Access 1) and House Door (Access 2) controlled by the proximity key or by the proximity integrated in the dual technology key.

Building Access 2



Front Gate (Access 1) controlled by Channel 1 of the remote control Door for building access (Access 2) controlled by the proximity key integrated in the remote control or vice versa

Controllers working with B-Soft software

Micro LE (Read & Write) and Vitwo (read & write) can be used in conjunction with the same software

Micro L&E

A cost effective solution for single door access control where remote administration is required. Programming and administration is done off site using the B-Soft software. Access rights, user information and validity of the token are encoded onto the token itself using the desktop encoder. This is the entry point into Read & Write technology and is the ideal solution for blocks with a single entrance where there is a high tenant turnover and new fobs are regularly issued.

- Technology: Read & Write 13.56 MHz
- Users: 1000
- Output: 1 door 5A
- Programming: off-site with visiopac software + encoder
- Power Input: 9/30 Vdc or 12/24 Vac, 1A
- Standard cable wiring: only 2 wires
- Max distance between reader and controller: 100m
- Self diagnosis of the controller
- Operating temperature: -20°C to +70°C

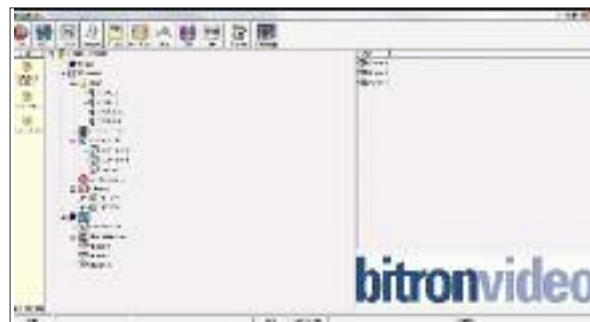

CONTROLLERS

code	description
GB-145-001	Read & Write 1-door 1000 user controller Micro LE V4

READERS

FD-020-081	Mullion reader 13.56 MHz for use with Ciprox, Vitwo Read Only, Micro LE Read & Write and Vitwo Read & Write controllers.
FD-020-086	VR mullion reader 13.56 MHz for use with Ciprox, Vitwo Read Only, Micro LE Read & Write and Vitwo Read & Write controllers.
FD-020-007	VR panel mount reader 13.56 MHz for use with Ciprox, Vitwo Read Only, Micro LE Read & Write and Vitwo Read & Write controllers.

KEYS

AV0151/012	13.56 MHz proximity fob for use with Ciprox, Vitwo, Micro LE & EASYDOORCONTROLLER
------------	---

ACCESSORIES

GB-130-061	Read & Write PC Administration kit - Contains VisioPac software for Read & Write systems, Desktop Encoder, USB Cable
GB-500-123	Vitwo, Ciprox & Micro LE handheld system programmer



Network Systems

Network System

Passan

Passan is a PC based networkable access control system. Unlike other network systems where you need a controller every time, with Passan you can expand your 2 doors controller to control 6 doors with only one controller! **YOU SAVE TIME, EQUIPMENT & MONEY.**

The PASSAN system includes multiple features, such as lift management, mail box management, SMS alerts, anti-pass-back, counting zone, proximity readers, RF transmitters, CCTV management, IP modules.

You can network 32 controllers to control up to 192 doors with 2700 users.

This system may be administered on-site or remotely, by IP or via a modem. FDI's software suite, PASSANSOFT, is a management-software solution that has been designed for easy use by non-specialist operators, while also providing a comprehensive range of configuration options. The PASSAN solution stands out from the competition due to its modularity. Just one controller allows users to control between two and six doors, with a wide variety of options. As a result, this solution is very competitive price-wise, as it uses a single controller platform for multiple doors.

- 2700 users
- Networkable 2 channel controller expandable to 6 channels using 2 channel plug in modules
- Tamper switch
- Controller password
- Security dongle for PC access
- Upgradeable plug in flash memory module
- Maximum distance between controller and reader keypad is 100m
- 6000 events for each controller
- LED diagnostic status for power, readers, exit button and network connections
- Controller compatible with FDI Proxter, panel mount and RF readers. Also networkable coded keypad
- Easycase compatible

EXTRA FEATURES: lift management, CCTV, car parks, gate automation, Biometric
12V DC 1AMP power supply required



CONTROLLERS:

code	description
GB-120-006	FDI Passan 2 Door Controller & Clock Card for 2700 Users - Expandable up to 6 doors - Programmed by PC only (Max 32 controllers per network) REQUIRES 12V DC 1AMP REGULATED PSU
GB-120-010	FDI Passan Extension Module for door 3 & 4
GB-120-015	FDI Passan Extension Module for door 5 & 6
GB-120-205	FDI Passan 8 Output Expansion Module
GB-120-206	FDI Passan 8 Input Expansion Module
GB-120-207	FDI Passan 4 In/Out Expansion Module
GB-120-208	Lift extension module for controlling up to four lift decoders
GB-040-026	Lift decoder for managing access to up to 10 floors

READERS

GB-020-006	VR panel mount reader 125 KHz for use with Passan controllers
GB-020-084	VR mullion reader 125 KHz for use with Passan controllers
GB-020-080	Mullion reader 125 KHz for use with Passan controllers

KEYS

FD-010-070	125 KHz proximity card for use with Transit and Passan systems
FD-010-012	125 KHz proximity fob for use with Transit & Passan systems
Dual Technology	
GB-010-015	125 KHz and 433 MHz combined proximity and RF fob for use with Passan system
FD-010-021	125 KHz and 868 MHz combined proximity and RF fob for use with Passan system

ACCESSORIES

GB-050-006	FDI Passansoft PC Software for programming, administration, reports and live viewing. Including security dongle
GB-050-006C	FDI Passan Connection Kit for Passansoft, Consists of USB to serial converter, 2M Serial Lead, 10M Serial Lead, Pair of RS232-RS485 Line Powered Converters and USB Memory Stick for Backing up configuration
GB-500-268	FDI Passan Desktop Management Reader - USB GB-500-191RS485 Repeater, extends total cable length of network to 2000 metres
GB-500-039	FDI Passan Serial (RS232) to TCP/IP interface to connect controllers over the internet
GB-025-072	Passan network keypad - 3 wires
GB-020-020	RF radio receiver 433 MHz for use with Passan controllers
GB-020-021	RF Radio receiver 868 MHz for use with Passan controllers

How to save time, save equipment and save money?

Build your Passan network - Group your readers



GB-120-006
2 door controller and Clock Card for 2700 users expandable up to 6 doors. Programmed by PC only (Max 32 controllers per site)



GB-120-010
2 door module doors 3 & 4



GB-120-015
2 door module doors 5 & 6



Readers & RF Receivers

There are different types of readers suited to different environments, readers that are mounted alone or integrated into entrance panels. Most of the following reader types and RF receivers are available in two different versions;

- 2 Wire versions - 13.56 MHz for proximity readers and 868 MHz for RF receivers. These are compatible with all Ciprox, Vitwo Read Only, Micro LE Read & Write and Vitwo Read & Write controllers.
- 3 Wire versions – 125 KHz for proximity readers and 433 MHz for RF receivers. These are compatible with all Transit stand-alone and Passan network controllers.



Reader Modules for Modular Panels

Access Control - Domular Classic Evolution Modules

code	description
AV0151/016	“SLIM” module: panel access control module. Domular Classic Evolution. With proximity reader and 2 LEDs. For connection to remote unit (2-4 doors) at max. 100 m. 12 Vac power.

Mullion reader

- Power Supply: 12V DC (supply by the controller)
- Current: 30mA
- Wire gauge: 2 or 3 wires
- Size: 78mm x 43mm x 16mm
- Read range: up to 60 mm
- Operating temperature: 0° to 60°C

Operation: The reader has a bi-colour LED to indicate status of a read token.

If the key is valid, the LED will change to green for 3 seconds. If token is not valid the LED will flash red.

code	description
GB-020-080	Mullion reader 125 KHz for use with Passan controllers (3 wires - 100m)
FD-020-080	Mullion reader 125 KHz for use with Transit controllers (3 wires - 100m)
FD-020-081	Mullion reader 13.56 MHz for use with Vitwo, Micro LE and Vitwo controllers (2 wires - 100m)
GB-020-122	Mullion reader Easy Door Controller (2 wire - FTP cable - 20m max.)



VR Mullion Reader

- Power Supply: 12V DC (supply by the controller)
- Current: 30mA
- Wire gauge: 2 or 3 wires
- Size: 60mm x 60mm x 20mm
- Read range: up to 60 mm
- Operating temperature: -20° to 70°C

Operation: The reader has a bi-colour LED to indicate status of a read token.

If the key is valid, the LED will change to green for 3 seconds. If token is not valid the LED will flash red.

code	description
GB-020-084	VR mullion reader 125 KHz for use with Passan controllers (3 wires - 100m)
FD-020-084	VR mullion reader 125 KHz for use with Transit controllers (3 wires - 100m)
FD-020-086	VR mullion reader 13.56 MHz for use with Vitwo and Micro LE (2 wires - 100m)
GB-020-123	Vandal resistant surface mount reader Easy Door Controller (2 wire - FTP cable - 20m max.)



VR Panel Mount Reader

- Power Supply: 12V DC (supply by the controller)
- Current: 30mA
- Wire gauge: 2 or 3 wires
- Size: 60mm x 60mm x 20mm
- Read range: up to 40mm
- Operating temperature: -20° to 70°C



Operation: The reader has a bi-colour LED to indicate status of a read token. If the key is valid, the LED will change to green for 3 seconds.

If token is not valid the LED will flash red.

GB-020-006	VR panel mount reader 125 KHz for use with Passan controllers (3 wires - 100m)
FD-020-006	VR panel mount reader 125 KHz for use with Transit controllers (3 wires - 100m)
FD-020-007	VR panel mount reader 13.56 MHz for use with Micro LE and Vitwo controllers (2 wires - 100m)
GB-020-126	VR panel mount reader 13.56 MHz for use with EASYDOORCONTROLLER (2 wire - FTP cable - 20m max.)
VR Prox cutout	Extra for proximity reader cutout in VR-Inox entry panel
VR-PROX	Vandal Resistant Prox Reader Panel c/w Surface Housing - requires 40 x 40 panel mount reader.
VRF-PROX	Vandal Resistant Prox Reader Panel c/w Flush Housing - Requires 40 x 40 panel mount reader

Easy Door Controller - All in One

GB-140-058	Flush mounted reader + controller Easy Door Controller all in one
GB-140-059	Surface mounted reader + controller Easy Door Controller all in one

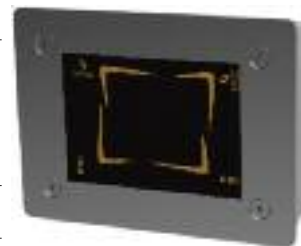

RF Receiver

It is designed to receive a radio signal from a RF transmitter FD-010-048/015/021/022. No specific configuration is needed when connecting the RF reader to the controller. An LED called 'environment' gives you information about the electromagnetic environment. When the led is off, there is a high quality RF reception.

But when the light is on, the environment has electromagnetic disturbances.

A LED indicates when the RF reader received a signal from a FDI RF transmitter.

Another led indicates if there is a good communication between reader and controller.

- Power Supply: 12V DC (supply by the controller)
- Wire gauge: 2 or 3 wires / 50m max
- Size: 72mm x 60mm x 12mm
- Read range: up to 50m
- Operating temperature: -20°C to +70°C



GB-020-020	RF radio receiver 433 MHz for use with Passan controllers
GB-020-021	RF radio receiver 868 MHz for use with Passan controllers
GB-020-023	RF radio receiver 868 MHz for use with Vitwo Read & Write controllers.



Proximity Fobs/Cards and Dual Technology Fobs

As with the readers and receivers, there are different versions of the fobs and cards for the different systems. If you have a Transit system with 125 KHz readers, it stands to reason that you will need 125 KHz fobs.

Proximity Key 125 KHz for transit system

- Size: 47mm x 35mm x 4mm
- Rating: IP68 - IK08
- Housing: ABS
- Operating temperature: -20°C to +70°C
- Engraved with a 8 digit alphanumerical number
- Can be customised

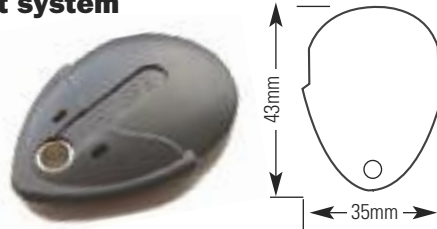

Proximity tokens are IP68 and IK08 rated. They are fitted with a durable metal ring for continuous everyday use. Each proximity key has a unique serial number ensuring complete security (no site code required). It can be customised with your logo or the residence logo.

code	description
FD-010-012	125 KHz proximity fob for use with Transit & Passan systems

Proximity Keys

13.56 MHz (different colours available) for VITWO, MICRO LE, EASYDOORCONTROLLER

Coloured proximity tokens for both systems

FD-010-010	Key 13.56MHz Black	FD-010-027	Key 13.56MHz White
FD-010-030	Key 13.56MHz Green	FD-010-028	Key 13.56MHz Blue
FD-010-078	Key 13.56MHz Yellow	FD-010-029	Key 13.56MHz Red
FD-010-081	Key 13.56MHz Orange	FD-010-146	Box of 10 mixed 13.56MHz

Proximity Card

ISO proximity cards have a unique serial number ensuring complete security (no site code required). They are coded in the factory with one of 4 million possible combinations. It can be customised with your logo or the residence logo.

- Size: 85mm x 54mm x 1mm
- Operating temperature: -20°C to +50°C
- Engraved with a 8 digit alphanumerical number
- The code is on the cards to ease programming and identification
- Can be customised

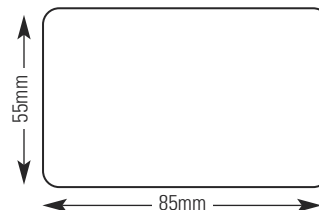

FD-010-070	125 KHz proximity card for use with Transit and Passan systems
FD-010-051	13.56 MHz proximity card for use with Vitwo, Micro LE & EASYDOORCONTROLLER

Dual Technology Fob

FDI remote controls use dual technology to combine proximity and RF. They are fitted with a durable metal ring for continuous everyday use. Each proximity key has a unique serial number ensuring complete security (no site code required). It can be customised with your logo or the residence logo.

It contains a Lithium battery of 3V.

- Size: 63mm x 36mm x 13mm
- Rating: IP54
- Housing: ABS
- Operating temperature: -20°C to +70°C
- Engraved with a 8 digit alphanumerical number
- Life time expectation: 22000 operations

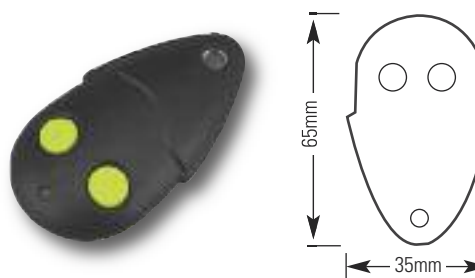

GB-010-022	13.56 MHz and 868 MHz combined proximity and RF fob for use with Vitwo systems
GB-010-015	125 KHz and 433 MHz combined proximity and RF fob for use with Passan & Transit system
FD-010-021	125 KHz and 868 MHz combined proximity and RF fob for use with Passan system



Keypads

KPAD water resistant

Dedicated to home automation, 1 LED dedicated to the KPAD and 2 LEDs can be connected to other equipment.

- 100 user codes
- Codes from 3 to 8 digits
- 3 LEDs:
- Yellow for the keypad, red & green (status LEDs)
- Keypad with blue backlight
- Lock release time from 1 to 99 seconds
- Monostable or bistable mode
- Tamper
- Clock input for time management
- IP65 rated
- Operating temperature: -20° to +60°
- Dimensions: 105 x 40 x 80 mm



code	description
FD-060-117	Surface mount keypad 1 relay 8A
FD-060-118	Surface mount keypad 2 relay (8A and 1A)

Wiring Diagram

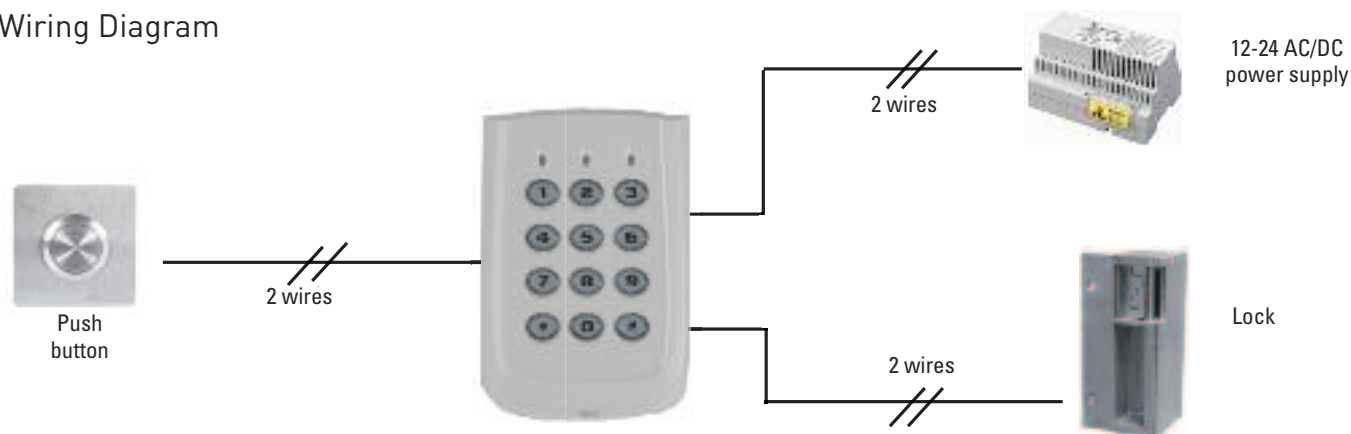

Included with the product:

- 3 pegs, and 3 screws with assembly tool
- User manual
- 1 Transil

Keypads

Stand-Alone

Stand-Alone Keypads

These keypads are quick and simple to wire up: two wires to connect to the lock, two wires to connect to the power supply and two wires to connect to the push button.

It has an integrated intelligence allowing local programming at the door, fast adding and deleting code no tools required. Codes are changed via the keypad using the master code. All functions including addition and removal of codes is carried out at the keypad itself.

KEYPADS can be "stand-alone", in that they are not connected to any network, however, there is networked version of the panel mount or surface VR keypad that can be connected to the Passan system. This acts just like a reader on the system and can be managed remotely and monitored etc.

Stand-Alone Keypads

- 22 resident codes of 3 to 8 digits
- Power supply: 12Vac or 12Vdc
- 2 door relays NO / NC + 1 request to exit
- Lock release time: from 1 to 99 seconds
- 1 Master Code
- 1 Reset Code
- Backlights available
- Operating temperature: -10°C to + 70°C



code	description
FD-70-000-914	Stand-alone flush keypad 2.5mm stainless steel backlight
FD-60-030-277	Optional surface box with rain hood
BVGPKP	Stand-alone Surface mount VR keypad - 2 relays
GB-025-072	Passan network keypad - 3 wires

VR Panel Mount Keypad

FDI keypads are an easy to administer and cost-effective means of controlling access to a building. This range of keypads provides an ideal solution where access control systems are for external use. Keypads are mounted outside the door and control fail safe and fail secure locks.

- 22 resident codes of 3 to 8 digits
- Power supply: 12Vac or 12Vdc
- 2 door relays NO / NC + 1 request to exit
- Lock release time: from 1 to 99 seconds
- 1 Master Code
- 1 Reset Code
- Backlights available
- Operating temperature: -10°C to + 70°C



BVGPKP	VR panel mount backlit keypad
	VR Keypad Additional charge for keypad cut-out in VR-Inox panels

Keypad Modules for Modular Panels

AN5779/L	Domular Class Coded Keypad module, aluminium finish
AV4187/68	TClass keypad module



Grothe has a long history

Founded 1892 in Cologne and then in 1998 Grothe moved to Hennef.

Within the group Grothe performs the central support as centre of competence for chimes, wireless technology and transformers. The strength of the company is in the wide-ranging assortment of products for home communication.

It ranges traditionally from chimes, push buttons, safety- and bell-transformers and products for signalization for industry, public buildings and schools home inter phones, door stations in all variations to security technology. The large assortment for security technology contains wireless and wired alarm systems as well as video detection as local solution or as network-(IP)-solution.

This means security for all demands.

Technical guidance will be given by our sales force, to installers or wholesaler. All telephone queries will be dealt with by our customer services. Continuous innovation and development is ensured by our research and development department as well as by our product management.



Doorbells & Chimes

Bitron Video also offer a complete range of Door Chimes from Grothe. Grothe are another group company based in Germany and are a leading manufacturer of door chimes in Europe. The range includes wired door chimes & wireless door chimes, kits and accessories with industry leading features. All are extremely high quality, German engineered products and feature modern design and advanced features.

Mistral Wireless Chime kits

The full range of Mistral wireless chime receivers can be used as wireless call repeaters on our audio or video door entry systems by using a transmitter interface connected across the call tone on one of the doorphones. This means the call from the entry panel can be notified in areas where there it is not possible to cable an additional doorphone and can also give a portable solution to notifying a call at the entrance.

Functions

- 17 appealing polyphonic melodies (including 2/3 tone, Westminster, classical, pan pipes, kettledrum, glockenspiel, dog)
- User-friendly selection of melodies and two alternately flashing super-bright white LEDs. easyTIP system
- Alarm function with DIN emergency call tone for special situations
- Distance booster: any desired range can be achieved by linking several transmitter/ receiver combinations
- Water-proof combination transmission button (IP54) with inscribable nameplate and LED transmission indicator
- 20 different paging signals for optimum access control, max. 20 transmitters can be memorised
- Central paging: several receivers can be controlled from a single transmitter
- Individual paging: each receiver can be controlled individually from additional transmitters
- Matrix paging: combined central and individual paging is possible
- Transmitter/ Receiver pre-programmed at the factory. Easy memorising of additional transmitters at the touch of a button. EasyTIP system
- Optical and acoustic LowBatt display for the batteries of the receiver AND of the transmitter
- 4-stage slide switch for paging signal setting (1-melody/flashing; 2-melody only; 3-flashing only; 4-mute)
- Receiver: can be set up on a surface, hung up or screwed into place; transmitter: can be screwed into place or hung up with a clip
- Compatible with almost all intercom and doorbell systems (page forwarding as standard feature)
- Control unit easily accessible
- A neutral covering cap is enclosed for the transmitter especially for installation with page forwarding.



■ MISTRAL 210m



■ MISTRAL 211m

■ MISTRAL 600



■ MISTRAL 300m



■ CROMA 100A-a



code description

Chimes

GR43400	Mistral 600 radio chime set. Includes 12 interchangeable design motifs
GR43303	Mistral 210M radio chime set. Silver finish. No visual alert
GR43300	Mistral 300M radio chime set. White finish. Xenon flash alert
GR43305	Mistral 200M radio chime set. White finish. 3 melodies, no visual alert

Additional Receivers/Transmitters

GR43401	Mistral 600E radio chime, receiver only
GR43301	Mistral 300M E radio chime, receiver only. White finish
GR43440	Mistral SE 0.30-s radio transmitter button. 250m range, silver finish
GR43441	Mistral SE 0.30 radio transmitter button. 250m range, white finish
GR43450	Mistral PSE 0.40-s power radio transmitter button. 500m range, silver finish



Wired Door Chimes

The range of wired door chimes is very cost effective and there are different types of chimes and bell pushes to suit any environment. Also wired chimes can be battery powered for ease of installation (only a 2 core wire from the bell push to the chime is required) or they can be mains powered via transformer which means there are no battery changes required.

Functions

- 17 brilliant polyphone sounds (2/3 tone, Westminster, pop, special tone seq. for people with hearing difficulties, classical etc.)
- Switchable from melody to ALARM tone (optimal for use in combination with movement detectors in a shop, for example, when a melody should sound during the day and an ALARM tone at night)
- Volume adjustable up to max. 86 dB(A)
- 2 different paging signals for optimum access control
- SILENCE function (one-button mute function) with LED indicator
- User-friendly easyTIP control unit for all functions (fold-up cover)

■ CROMA 50



■ CROMA 231



■ CROMA 230



code	description
Battery Powered	
GR43150	Croma 50 wired electronic chime. White finish, 3 melodies
GRCROMA50KIT	Grothe Croma 50 Doorbell Kit Includes White Button
Battery or separate transformer	
GR43170	Croma 100A wired electronic chime. Silver finish, 17 melodies
Integral transformer	
GR43175	Croma 230 wired electronic chime. White finish, 17 melodies
GR43177	Croma 231 wired electronic chime. Silver finish, 17 melodies

Electro-Mechanical Chimes

These are the traditional types of doorbell with a two-tone “ding-dong” sound or a bell with an action and sound like that of old-fashioned alarm clock. These are the simplest and most cost effective method of visitor notification possible.

■ CHIME 665



■ CHIME 0650



code	description
GR44465	Chime 465A-gb electro-mechanical chime. Gloss black
GR44466	Chime 465A-gw electro-mechanical chime. Gloss white
GR44067	Chime 065 electro-mechanical chime. White/silver
GR24071	Underdome bell. 8V AC electro-mechanical bell. White/chrome

Bell Pushes

A large variety of different bell pushes are available from the basic and functional to the high-end designer solution.



■ GR55595



■ GR64036



■ GR64094

code	description
GR64035	KKO2005 basic bell-push. Black/white
GR64036	KKO2005-w basic bell-push. White/black
GR64090	KKO2001-w golf ball bell-push. White
GR64094	KKO2001-s golf ball bell-push Silver/black
GR51011	Montilux bell-push with name window, can be illuminated
GR55595	Surface brass bell-push, brushed brass
GR55541	Deluxe square stainless steel bell-push. Machined solid stainless steel, surface mount
GR55632	Classic storey plate, 2 buttons with windows. Surface mount, white
GR55633	Classic storey plate, 3 buttons with windows. Surface mount, white
GR55634	Classic storey plate, 4 buttons with windows. Surface mount, white



Bell/Safety Transformers

The range of Grothe transformers allows the operation of door chime circuits with mains power or for other low voltage AC circuits. They are suitable for DIN rail mounting in consumer units/distributor panels or can be surface mounted. They all include PTC short circuit protection (except GR14207 Failure safe bell transformer) which means they are virtually indestructible. They are all certified to the highest and most stringent European standards of safety and conformity.



■ GR14034



■ GR14101



■ GR14060



■ GR14073

code	description
GR14207	GT50810 Failure-safe bell transformer 8V AC
GR14201	GT3148 PTC protected bell transformer 8V AC
GR14073	GT3173 PTC protected bell transformer 4/8/12V AC
GR14936	GT36AP surface mount installation kit for bell transformers
GR14101	GT1975 safety transformer 12V AC (1.5A)
GR14034	GT1973 safety transformer 8/12V AC (2.0A)
GR14160	GT1990 safety transformer 12/24V AC (5.2/2.6A)

Locks, locking accessories and metalwork

All of the Bitron Video door entry systems are capable of controlling a 12V AC lock without any additional relays or PSU. If a DC lock (including mag-locks) is required or if the system is to trigger a lock via a coded access keypad or proximity controller, an interface relay will be required. To achieve timed lock release on a system with no access control element, a timer relay will be required which may also need a separate DC PSU.

All of the FDI access control systems are capable of controlling AC or DC locks. An extra lock PSU will not be required providing an appropriately rated PSU is used to power the controller and all locking devices connected to it.



Locks, PSU's and Accessories

code	description
BV1003	Combined rim/mortice fixed 12V AC lock release - fail secure
BV2004	Mortice fixed 12V DC lock release - fail safe
ML600LED	600lb holding force monitored mag-lock with LED
ZL600LED	"Z&L" mounting bracket for the above mag-lock
ML1200LED	1200lb holding force monitored mag-lock with LED
ZL1200LED	"Z&L" mounting bracket for the above mag-lock
ML800G	800lb holding force stainless steel external mag-lock for gates
ZL800G	Z&L" mounting bracket for the above mag-lock
BVRELAY	2 Pole Interface Relay PCB 12-28V AC/DC To Be used with DC Release
BVTIMERRELAY	Single Pole 12V DC Timer Relay for timed Lock release Requires 12v DC psu
PTE1	Request to exit button, white plastic, standard single gang switch size
PTE2	Request to exit button, stainless steel plate, steel button, standard single gang size c/w surface box. engraved "Press To Exit"
PTE3	Request to exit button, stainless steel plate, steel button, Slim fit 85mm x 39mm c/w surface box. engraved "Press To Exit"
PTE4	Request to exit button, white plastic, Slim Exit Button
PTE5	Request to exit push plate. Round metal push plate engraved "Press To Exit" Single gang size, ideal for hospitals and public buildings
BGU	Green emergency break glass unit - re-settable
BGU-C	Break glass unit with cover - non-resettable
PTE-Dome	Request to exit button, Stainless Steel, Green Mushroom Dome - COM/NO/NC Change over contacts
PTE-DDA	Large Moulded Exit Plate - Disabled logo push to open Engraved
PTE-BGU	Dual unit, press to exit with green dome button and combined break glass unit
PTE-BGU-SS	Dual unit, press to exit with stainless steel button
PSB1A-12	1amp cased PSU with Battery back up facility. Switch Mode (12V)
PSB2A-12	2amp cased PSU with Battery back up facility. Switch Mode (12V)
PSB3A-12	3amp cased PSU with Battery back up facility. Switch Mode (12V)
PSB5A-12	5amp cased PSU with Battery Backup facility. Switchmode



Metal fabrication for all your requirements

Metalwork

We can provide a range of metalwork from "Firemans Drop-Key" switches to posts for mounting entrance panels or readers at gates for pedestrian or vehicle entrances.

code	description
FS4	Drop Key Firemans switch
FS4/SH	Drop Key Firemans switch, surface mount
PEDP1.2	Pedestrian Post 1.2 Mtr
PEDP1.6	Pedestrian Post 1.6 Mtr
PEDPDH	Pedestrian post, dual height
VEHP1.2	Vehicle post 1.2 Mtr
VEHDH	Vehicle post, dual height 2.0 Mtr
VPAP-SH1	Post Adaptor Plate for SH1 Surface Hood
VPAP-SH3	Post Adaptor Plate for SH3 Surface Hood
POSTROOT	Embedding root for posts

■ FS4



Metalwork to Order

■ FS4/SH



■ PEDPI.6



■ VEHP1.2



■ POST ROOT

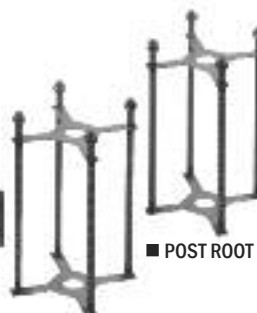

We can also accommodate requests for various other metalwork items such as engraved plaques with instructions for visitors, building name plates, post boxes, pillars, bollards etc. These items can be manufactured in a range of materials including 316 stainless steel, brass and aluminium and can be finished in various methods. i.e. polished, brushed, powder coated or anodised.

Contact our sales team who will be happy to discuss your requirements and help to realise your idea.

Bitron Video Group Ltd “ The Company” - Standard Terms and Conditions of Sale

- i. The following terms and conditions shall prevail over any other terms of trading of the Buyer.
- ii. The Company reserves the right to supply goods to the seller upon investigation of the Buyer's financial or trade status. The Company shall not be obliged nor liable to make any payment to the seller by way of compensation or damages.
- iii. Due to continuous product development The Company reserves the right to change specifications and prices without prior notice. All quotations, technical information and price lists are prepared without prejudice and whilst every effort is made to ensure their accuracy we reserve the standard E&OE terms.
- iv. The legal title of goods shall not pass to the Buyer until The Company has received full payment for the goods. All goods supplied shall be at the Buyers risk from delivery.
- v. Standard Payment terms are 30 days month end.
- vi. Stock items are usually dispatched by the next working day. Estimated dates for delivery of non stock or special order items will be given on request, however The Company shall not be liable for damages for late delivery, for loss of profit (direct or consequential) or otherwise. Products not in stock may take up to 6 weeks for delivery. Delivery/small order processing charges will be applied on orders under £250 nett (uk mainland only). Please request details of charges at time of placing order.
- vii. All goods supplied are covered by warranty for a period of 12 months from date of invoice. This warranty be comes void if the goods supplied are subject to misuse, vandalism, incorrect installation or incorrect use. The Company shall not be liable for damages, for loss of profit (direct or consequential) or otherwise as a result of equipment failure.
- viii. Any discrepancies on the delivery of goods or invoices must be notified to The Company in writing within 3 days.
- ix. The Return of Goods procedure must be followed in the unlikely event that goods are faulty or have been incorrectly delivered.
- x. All prices quoted are exclusive of VAT and the company reserves the right amend its prices with out prior notification. Formal quotations are valid for a period of 3 months.

Delivery of Goods

For specific delivery charges please contact us for a quotation.

The Company shall not be liable for late delivery by the carrier, even when timed delivery is requested. Arrangements can be made for your own carrier to collect from our premises if required.

Returns Procedures

All equipment must be returned in original packaging, and packaging must be unmarked.

Please follow the steps detailed below to ensure that we are able help and remedy any problems that you may encounter.

For Faulty Equipment

- Step 1 Ensure that the equipment has been correctly connected. If in doubt phone for technical support.
- Step 2 If there is an equipment fault a returns number will be issued and a form will be faxed or emailed to you. Please ensure that you follow the instructions fully to return products to us.
- Step 3 Faulty equipment will be repaired or replacement issued at the discretion of the supplier. If no fault is found the unit will be returned to you and a investigation fee will be charged. This charge will be detailed on the goods return form.

Equipment ordered in error or no longer required.

- Step 1 Contact the supplier within 14 days of delivery to check if goods can be returned. Certain goods that have been specially ordered e.g. special or custom panels, will not be accepted for return. Please ensure that all equipment and packaging returned is in brand new unused condition.
- Step 2 If the return is accepted a minimum charge of £25.00 or 25% of the equipment value + VAT will be charged. The customer is responsible for the cost of carriage back to the supplier. This charge is subject to review without prior notice.

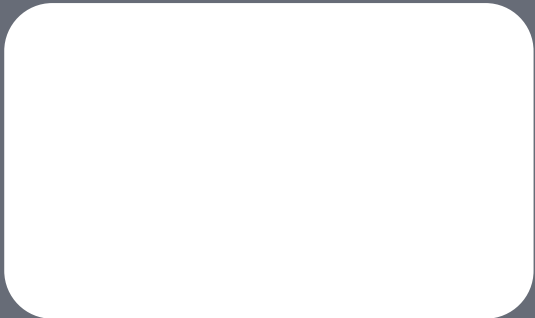

FDi GROTHE



bitronvideo

BitronVideo Group Ltd
480 Urban Hive
Skyline 120
Avenue West
Great Notley
Essex CM77 7AA

T: 01376 551351
F: 01376 556027
E: sales@bitronvideo.co.uk
W: www.bitronvideo.co.uk

Tel: 01376 551351 • sales@bitronvideo.co.uk • Fax: 01376 556027