

System Layout in Distributor Mode

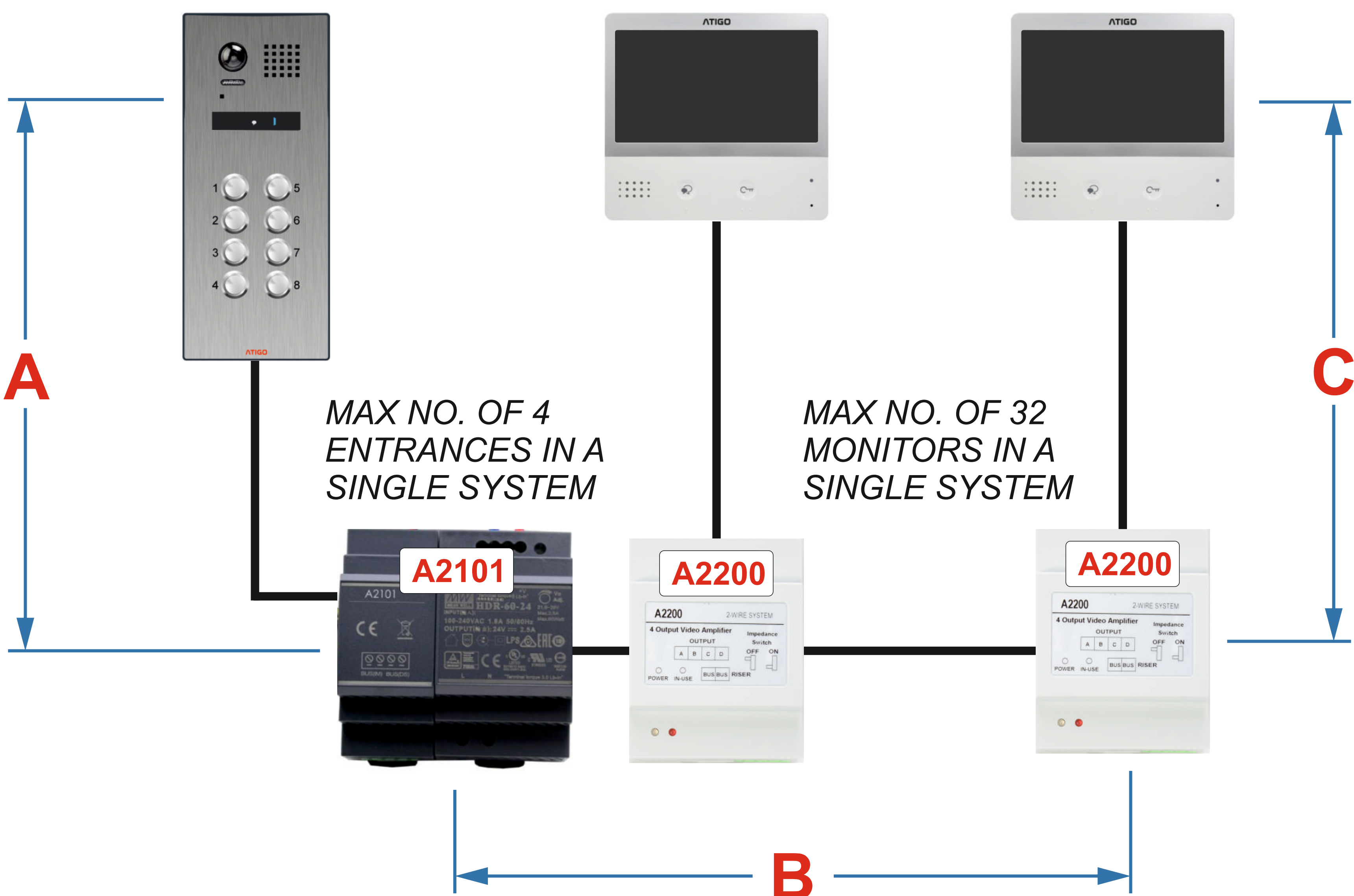

MAXIMUM CABLE DISTANCE

CABLE TYPE	A	B	C
Combine CAT5*	40 M	40 M	20 M
Belden 8762 or Equivalent	60 M	60 M	30 M
Single Twisted Pair Stranded Cale 2 x 0.75mm	60 M	60 M	30 M
Single Twisted Pair Stranded Cale 2 x 1.00mm	80 M	70 M	30 M

Combine CAT5*:
This cable type require all cores to be equally divided and twisted together in to two cores:
Solid colours = core 1
White colours = core 2

Connections Diagram

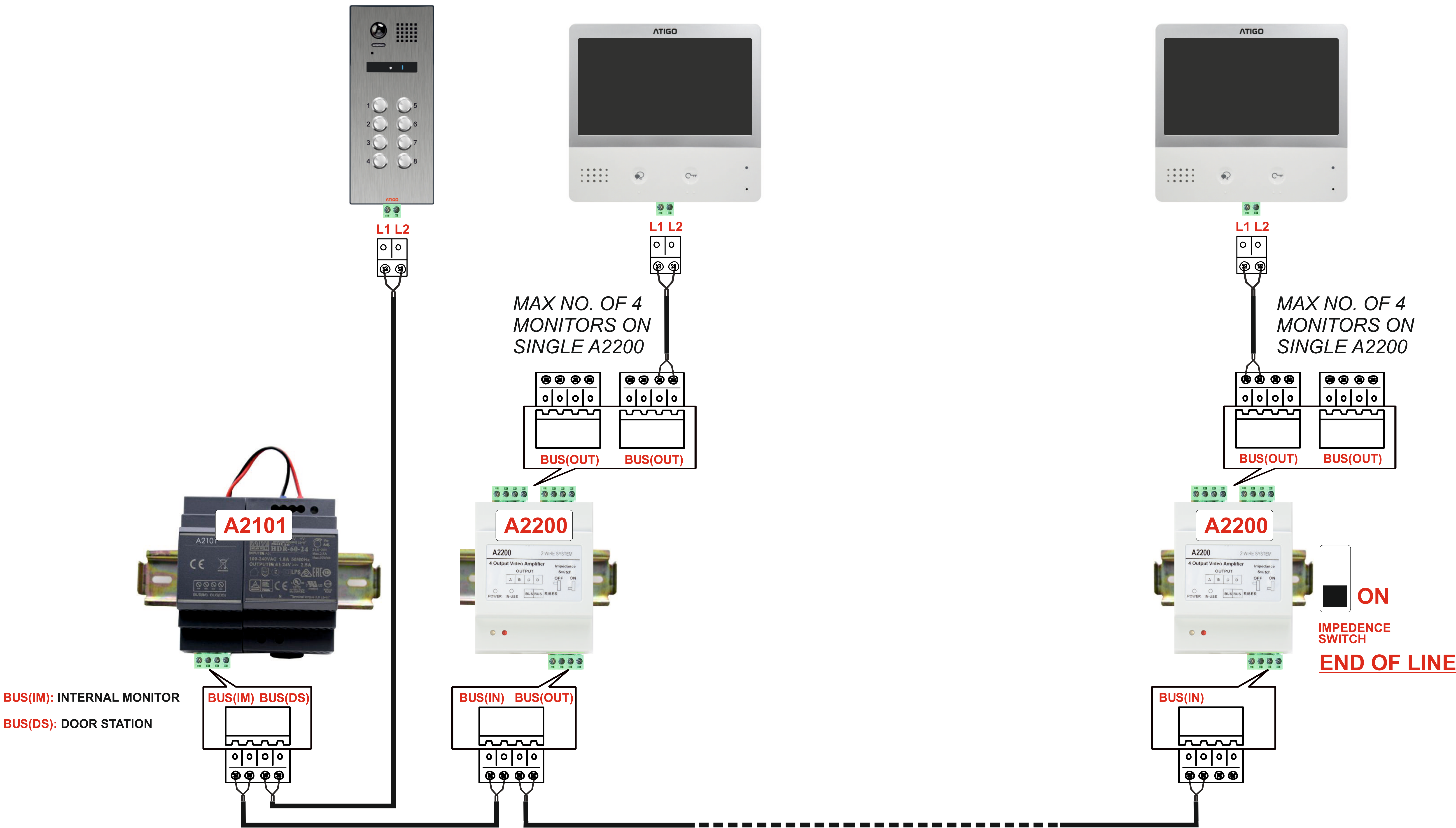

System Layout in Distributor Mode

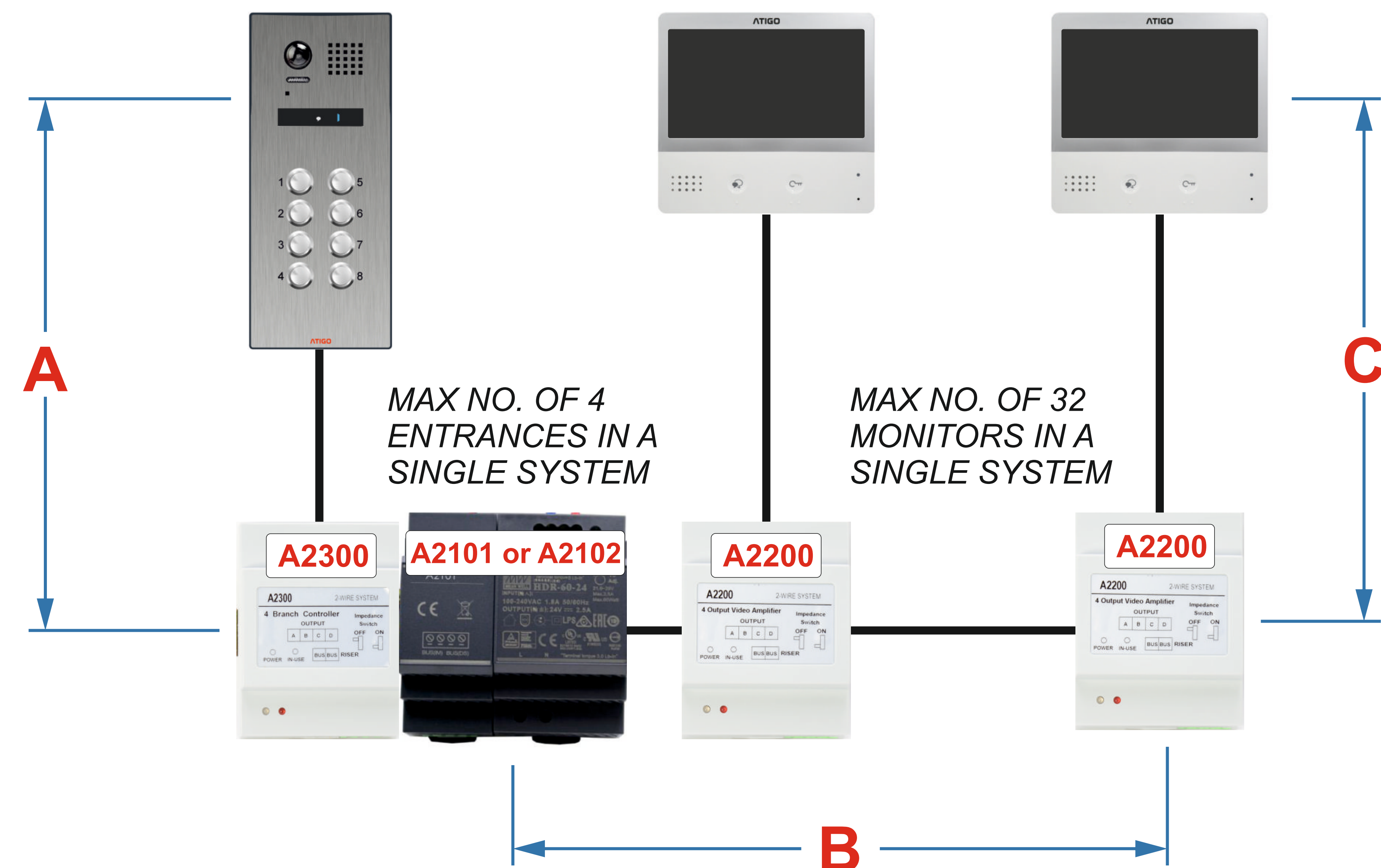

MAXIMUM CABLE DISTANCES

CABLE TYPE	A	B	C
Combine CAT5*	40 M	40 M	20 M
Belden 8762 or Equivalent	60 M	60 M	30 M
Single Twisted Pair Stranded Cale 2 x 0.75mm	60 M	60 M	30 M
Single Twisted Pair Stranded Cale 2 x 1.00mm	80 M	70 M	30 M

Combine CAT5*:
This cable type require all cores to be equally divided and twisted together in to two cores:
Solid colours = core 1
White colours = core 2

Connections Diagram

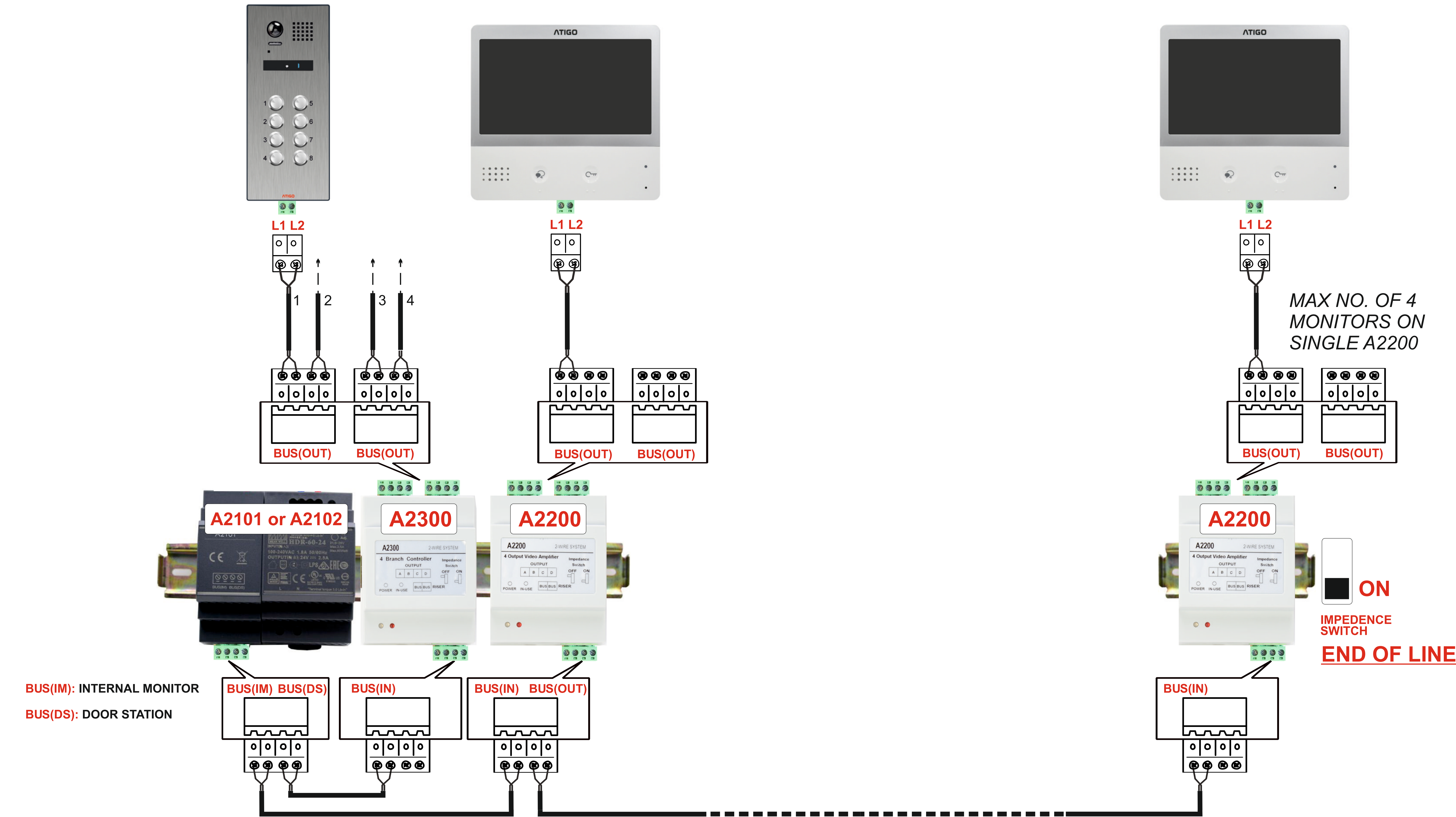

System Layout in Riser Mode

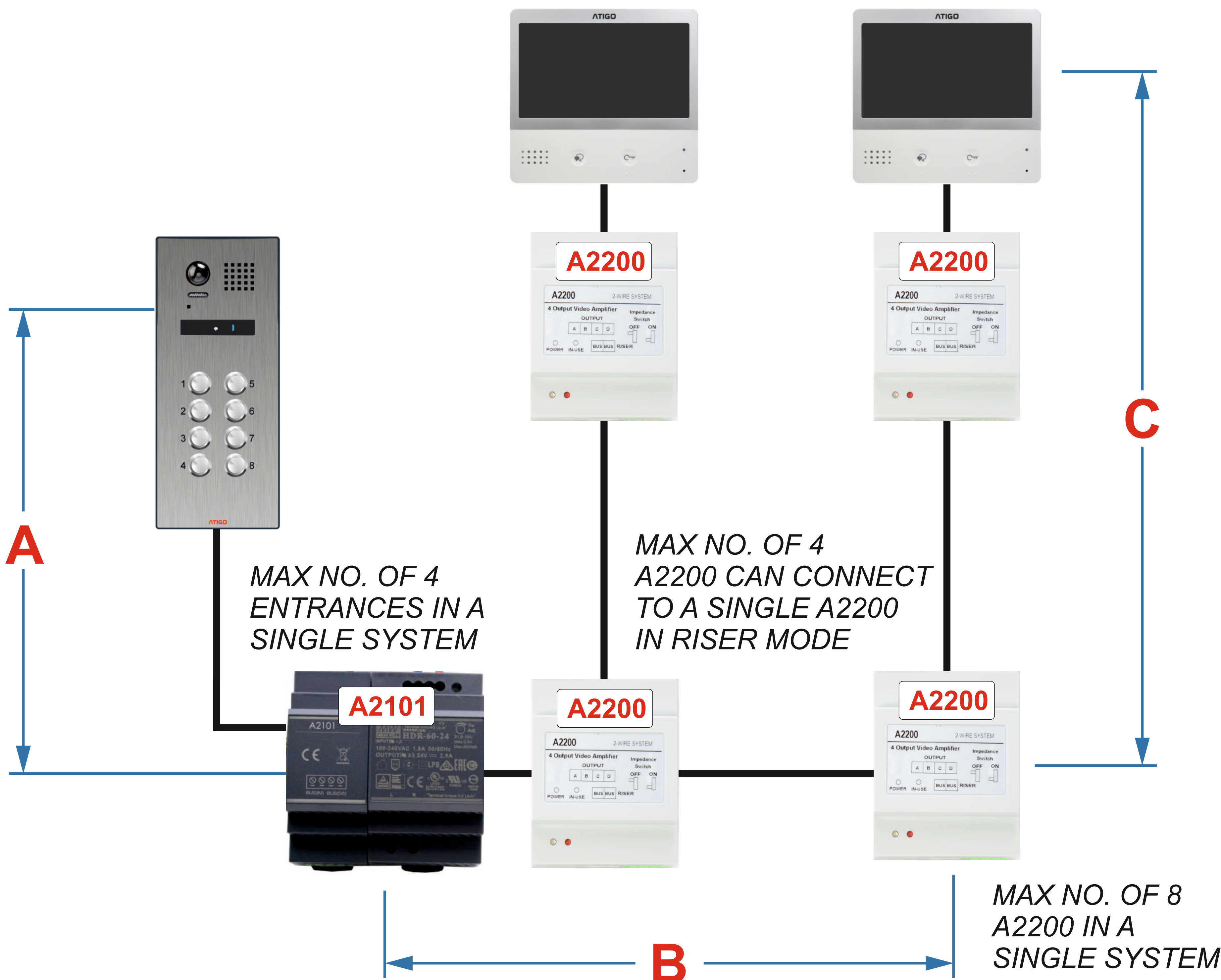

MAXIMUM CABLE DISTANCE

CABLE TYPE	A	B	C
Combine CAT5*	40 M	40 M	20 M
Belden 8762 or Equivalent	60 M	60 M	30 M
Single Twisted Pair Stranded Cale 2 x 0.75mm	60 M	60 M	30 M
Single Twisted Pair Stranded Cale 2 x 1.00mm	80 M	70 M	30 M

Combine CAT5*:
This cable type require all cores to be equally divided and twisted together in to two cores:
Solid colours = core 1
White colours = core 2

Connections Diagram

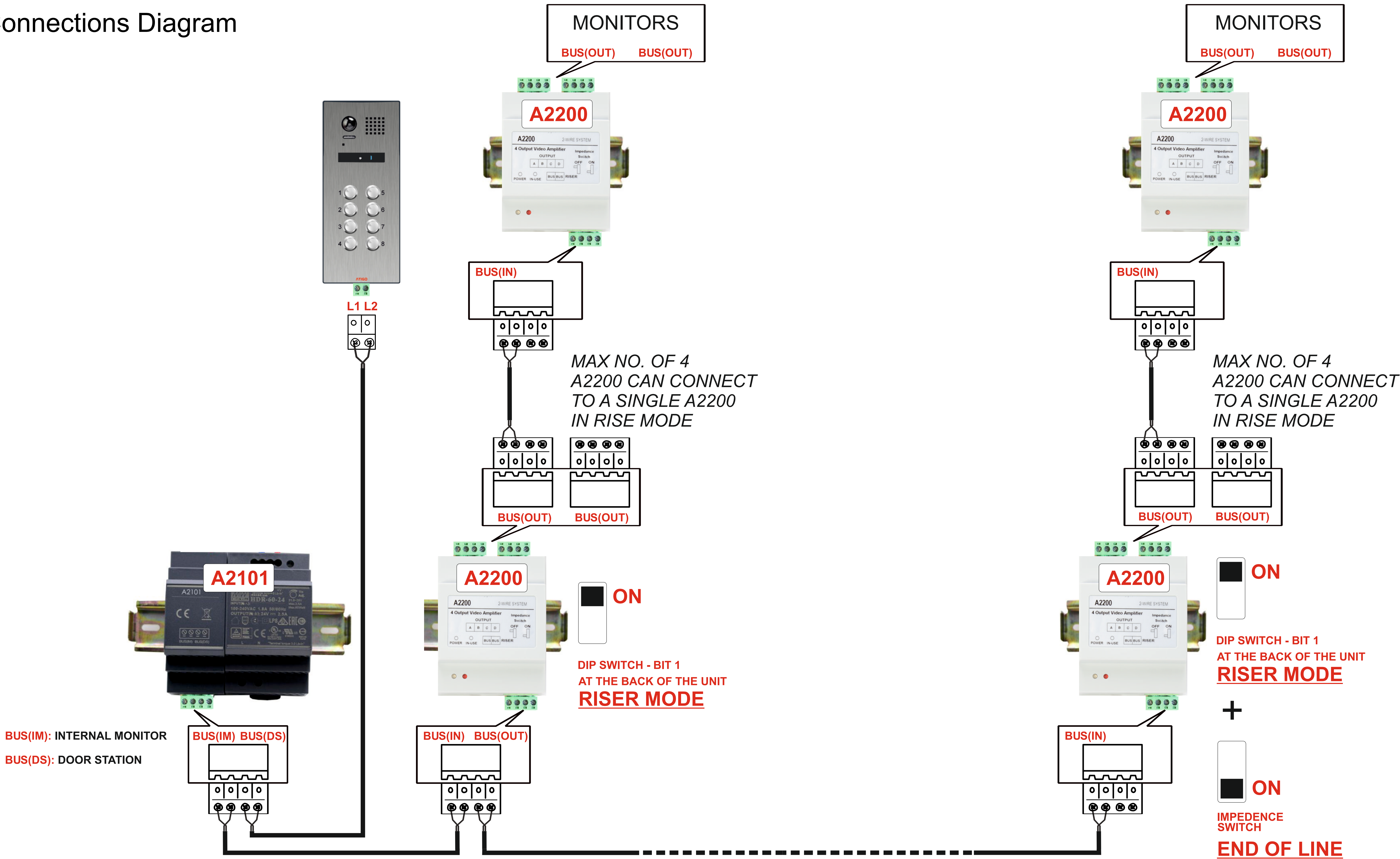

A

MAX NO. OF 4 ENTRANCES IN A SINGLE SYSTEM

MAX NO. OF 4 A2200 CAN CONNECT TO A SINGLE A2200 IN RISER MODE

B

MAX NO. OF 8 A2200 IN A SINGLE SYSTEM

C

CABLE TYPE	A	B	C
Combine CAT5*	40 M	40 M	20 M
Belden 8762 or Equivalent	60 M	60 M	30 M
Single Twisted Pair Stranded Cable 2 x 0.75mm	60 M	60 M	30 M
Single Twisted Pair Stranded Cable 2 x 1.00mm	80 M	70 M	30 M

Connections Diagram

