

# bitronvideo

CITOFONIA - VIDEOCITOFONIA - TVCC - TELEFONIA

CE

**STAFFA PER MONITOR T-Line**

MANUALE ISTRUZIONI

**BRACKET FOR T-Line MONITORS**

INSTRUCTIONS MANUAL

**ETRIER POUR MONITEURS T-Line**

MANUEL D'INSTRUCTIONS

**HALTERUNG FÜR T-Line MONITOR**

GEBRAUCHSANWEISUNG

**SOPORTE PARA VIDEOINTERFÓNO T-Line**

MANUAL DE INSTRUCCIONES

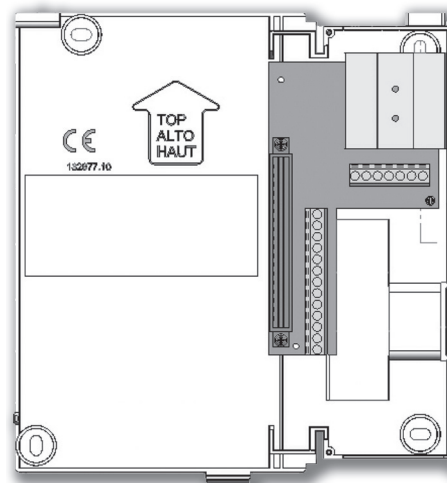

AV1423/013

**STAFFA PER SISTEMI CON CAVO COASSIALE**  
**BRACKET FOR SYSTEMS WITH COAX CABLE**  
**ETRIER POUR SYSTEMES AVEC CABLE COAX**  
**HALTERUNG FÜR SYSTEME MIT KOAXIALKABEL**  
**SOPORTE PARA SISTEMAS CON CABLE COAXIAL**

# ENGLISH

## INSTALLATION

1. Prepare outlet of the cable duct for the system cables at the bracket cable installation area. The recommended height is from 1.48 to 1.52 from the finished floor.
2. Fasten to the wall using the 4 screws provided and make the central gap of the bracket coincide with either the previously walled-in embedding box (where applicable) or with the wire protruding from the wall.
3. Connect the wires to the terminal board on the bracket.
4. Fit the monitor to the bracket by engaging the upper hooks first and then turn it to lock it using the automatic fastener. To remove it from the bracket, press the fastener shown in the figure and reverse the operation.

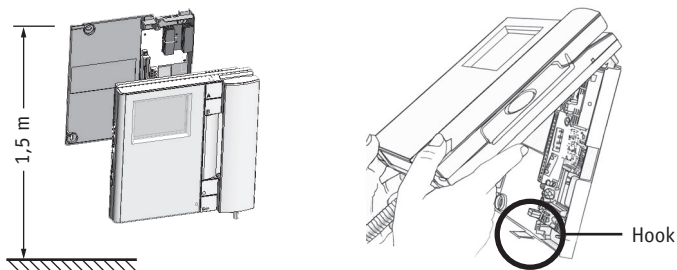

## CONNECTIONS

Two terminal boards for wiring the following signals are found on the bracket:

- M:** Monitor power I/O auxiliary control
- 3:** Monitor power positive
- :** System ground
- Q1, Q2:** Spare NO contacts 24V 0.5A monitor buttons A and B
- T:** Positive power-on command without call
- LD:** Red LED on monitor for open door indication
- V:** Coaxial video signal
- S:** Video ground
- P:** Floor call ringer input
- C7:** Electronic call
- 8:** Door lock release common connected to signal 6; cut jumper JP2 to insulate the door lock release button contact from the audio earth
- 6:** Audio common
- 9:** Door lock release
- 2:** Microphone
- 1:** Speaker
- E2:** Auto power-on button
- E1:** Auto power-on button common

✓ **Wires 1, 2, 6, 9, 3, -, S and V must be connected for correct system operation.**

## Description of auxiliary connections

All the connections described below allow to use some auxiliary monitor functions.

- **Terminal P**, if connected, is used to activate the floor call service function.
- **Terminal T**, if connected, is used to switch the monitor on without operating the ringer. This function is available by supplying +12V positive voltage between T and 1 when a voltage of +20V is present on terminal 3.
- **Terminal M** allows two auxiliary functions (one output and one input):
  - 1) to control a relay powering an auxiliary monitor (output)

2) to receive auxiliary power to switch on a monitor using an alternative power source with respect to that of the column (input).

- **Terminals E1 and E2**, if connected as shown in diagram 175 946 74, are used to switch the monitor and the camera on by pressing the button with the “•” symbol on the monitor. The function is available only if no other monitor is on.
- **Terminals Q1** make the normally open clear contact of button “A” on the monitor available. This may be used, for example, to operate staircase lights, cameras, electrical gates, etc.
- **Terminals Q2** make the normally open clear contact of button “A” on the monitor available. They may be used, for example, to operate staircase lights, cameras, electrical gates, etc.
- **Terminal LD** makes it possible to use the red LED on the monitor. The LED will light up when a positive +12V continuous voltage is applied. This voltage must be referred to the system earth (“1”). The red LED may be used to indicate open door conditions or, connecting terminal LD to terminal “3” it may be used to indicate when the system is working and consequently that auto power-on is not possible. When the monitor is on, the same LED will light up with green light and this colour will prevail on external indications, if any. Set the monitor correctly (see monitor manual) and provide +12V direct voltage to terminal **LD** to make the red LED light up indicating muting function (**MUTE**).

## SET-UPS

**Termination:** The standard video signal impedance of the bracket is low (typically 75 Ohm). The impedance will be set to high (47k Ohm) if the wire JP1 is cut. Cut the jumper to obtain high impedance only on brackets installed in systems without floor video signal distribution boxes, (cod. AN0606 or AN0564) in so called in-out systems, where the video signal connection wires must reach monitor terminals S and V directly and proceed from the same terminals to the next monitors.



In this system configuration, on terminal pins “V” and “S” of the last monitor is required a 75 Ohm termination resistor.

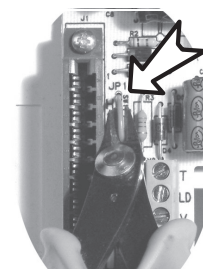

**Door lock release button:** cut jumper JP2 to eliminate the connection which carries one terminal of the door lock release button to the audio common (terminal 6) thus making both door lock release contacts available on terminals 8 and 9.

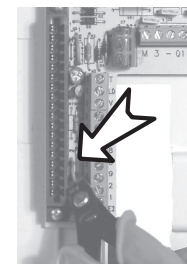

(SISTEMA "4 + n - COAX.") IMPIANTO VIDEOCITOFONICO 1 POSTO ESTERNO, 1 COLONNA  
 ("4 + n - COAX." SYSTEM) VIDEO DOOR PHONE SYSTEM WITH 1 VISITOR PANEL, 1 RISER  
 (SYSTEME "4 + n - COAX.") SYSTEME VIDEO 1 ENTREE, 1 COLONNE  
 ("4 + n Draht- KOAXIAL" SYSTEM) VIDEOSPRECHANLAGE 1 AUßENSTELLE, 1 STEIGLEITUNG  
 (SISTEMA "4 + n - COAX.") SISTEMA VIDEOINTERFONICO 1 MICROALTAVOZ, 1 COLUMNNA

All rights reserved - Diritti riservati a Norma di Legge

AV 1423/013 +  
 AV 1423/001 - AV1423/003

Tasto chiamata al piano  
 Call button at the floor  
 Bouton appel palier  
 Etagenruftaste  
 Tecla llamada al piso

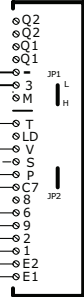

VIDEOCITOFONO T-LINE  
 T-LINE MONITOR  
 MONITEUR T-LINE  
 VIDEOANLAGE T-LINE  
 VIDEOINTERFONO T-LINE

Apriporta esterno  
 External door opener  
 Bouton de sortie  
 Externer Türöffner  
 Apertura de puerta externo

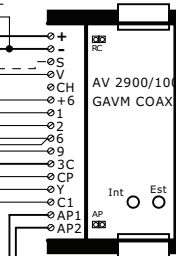

Serratura  
 Lock  
 Serrure  
 Schloss  
 Cerradura

Alimentatore  
 Power supply  
 Alimentation  
 Netzgerät  
 Alimentador  
 AV2900/303

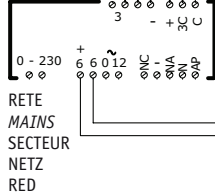

Connettore di Chiusura senza collegamenti  
 Closure Connector without connection  
 Connecteur Fermeture sans connexions  
 Abschlussverbinder ohne Anschlüsse  
 Conector de Cierre sin conexiones

# bitronvideo

CITOFONIA - VIDEOCITOFONIA - TVCC - TELEFONIA

Bitron Video adotta una politica di continuo sviluppo. Bitron Video si riserva il diritto di effettuare modifiche e miglioramenti a qualsiasi prodotto descritto nel presente documento senza preavviso.

Bitron Video follows a policy of continuous evolution of its products. Therefore Bitron Video reserves the right to introduce changes or modifications all its products in any moment and without prior notice.

Bitron Video applique une méthode de développement continu. Par conséquent, Bitron Video se réserve le droit d'apporter des changements et des améliorations à tout produit décrit dans ce document, sans aucun préavis.

Bitronvideo verfolgt eine Strategie der kontinuierlichen Entwicklung und behält sich daher das Recht auf Änderungen und Verbesserungen an jedem in dieser Anleitung beschriebenen Produkt ohne Vorankündigung vor.

Bitronvideo sigue una política de constante desarrollo; por lo tanto, se reserva el derecho de aportar modificaciones y mejoras a cualquier producto descrito en este documento sin aviso previo.

**BITRON VIDEO s.r.l.**

<http://www.bitronvideo.com>

e-mail : [info@bitronvideo.com](mailto:info@bitronvideo.com)