

NETATMO

presence

Outdoor security camera
with people, car and
animal detection



TRAINING BOOK

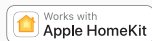



Pitch

Presence – a breakthrough in outdoor home security

Netatmo Presence is the first outdoor security camera that **detects and reports people, cars and animals**. It analyses and alerts in real-time if someone loiters around your home, a car enters your driveway or an animal is in your yard.

With Presence, you can check in on your home through **livestream from anywhere and any device**. Customise notifications to fit your needs: choose to receive alerts about any combination of people, cars and animals, or for all three.

The **integrated floodlight** helps you find your way safely at night and deters any unwanted visitors. It can be set to switch on when Presence detects a person, a car or an animal.

Presence **simply installs as an outdoor light**. Just replace one of your existing outdoor light fixtures and connect through Wi-Fi.

There is no subscription fee. Storing your videos is completely free.

3 reasons to buy Presence



Be alerted about what matters

Smart-Sight lets you know exactly what happens in front of your home—you know if there's a person, a car or animal.



Integrated smart floodlight

The integrated smart floodlight detects unwanted visitors and lights up the way.



Simply installs as an outdoor light

In just a few minutes you have a smart security system with a powerful floodlight for protection day and night.

Revolutionary outdoor security



SMART-SIGHT

Smart-Sight uses a breakthrough deep learning algorithm to detect and report the presence of people, cars and animals.



ALERT-ZONES

The Alert-Zones feature allows you to choose specific areas for alerts – you know instantly when someone enters a zone you selected.



SMART FLOODLIGHT

Presence's smart floodlight deters any unwanted visitors and lights up your way at night.



CUSTOM ALERTS

Customize notifications to fit your needs: choose to receive alerts about a combination of people, cars and animals, or for all three.

A powerful experience



STUNNING FULL HD VIDEOS

Full HD 1080p provides the highest video quality, so you can see clearly what's happening at home.



SUPERIOR NIGHT VISION

At night, choose to switch the floodlight on or watch discreetly with Presence's high-powered infrared LED night vision.



INSTALLS AS AN OUTDOOR LIGHT

Presence simply replaces one of your existing outdoor light fixtures. In a few minutes you have a sophisticated security system with a powerful floodlight.



ENTIRELY WEATHERPROOF

Presence is specifically designed for outdoor use and can withstand the elements including rain, snow, moisture, dust and dirt.

Free and secure video storage



ENTIRELY PRIVATE SD CARD STORAGE

Recorded videos stay entirely private thanks to the camera's local microSD card. A microSD card is included.



BACKUP SCREENSHOT

A screenshot of each event is the only thing stored in the Netatmo cloud – and nothing else. The camera selects the clearest image of each event.



OPTIONAL CLOUD STORAGE

Backup your videos on your personal Dropbox account or FTP server.



DATA PROTECTION

Your data is secured by an encrypted connection to guarantee the highest level of confidentiality.

Optional Dropbox or FTP storage

MICRO SD CARD STORAGE

The videos are recorded by Presence and automatically stored on its internal micro SD card.

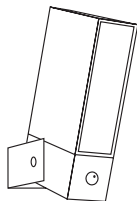

Automatic storage



OPTIONAL DROPBOX OR FTP STORAGE

Additionally, you can choose to backup videos immediately on your personal Dropbox account or FTP server.



Optional storage

FTP

No extra fees



FREE VIDEO ACCESS

Access your videos and live stream through the Security app – anytime, anywhere, on any device.



FREE VIDEO STORAGE

There is no subscription, no contract and no fee. Storing your videos is free on the included microSD card, with the option of using your Dropbox account or your FTP server as additional storage.

Know instantly what is happening outside your home

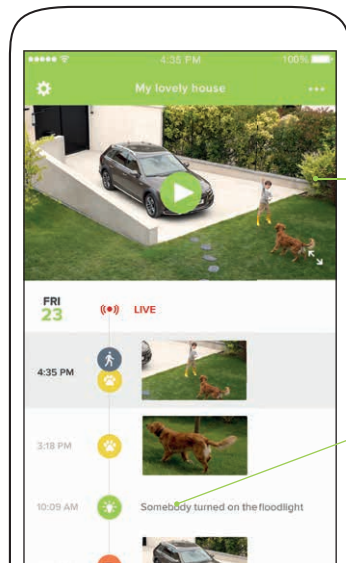

Access live streaming with a click.

Access past videos with a simple click on the timeline event.

The camera only records what matters, preventing hours of empty footage.

Each video can be downloaded.

Customise notifications and video recording

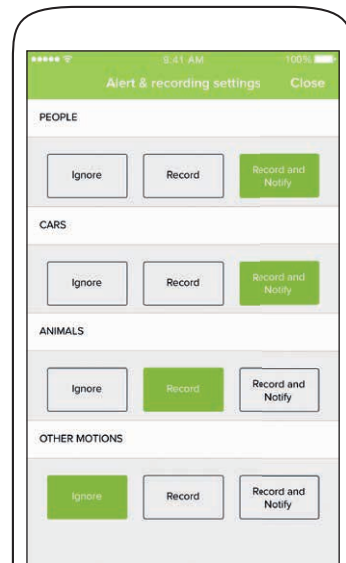

Choose what you want to record and be notified about it.

Customize floodlight activity

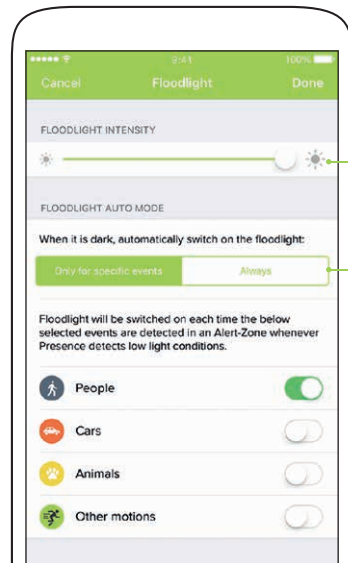

Customise light intensity.

Decide when the floodlight switches on.

Alert-zones

Select up to 4 Alert-Zones to choose what and where Presence needs to monitor.



Ultra-precise notifications

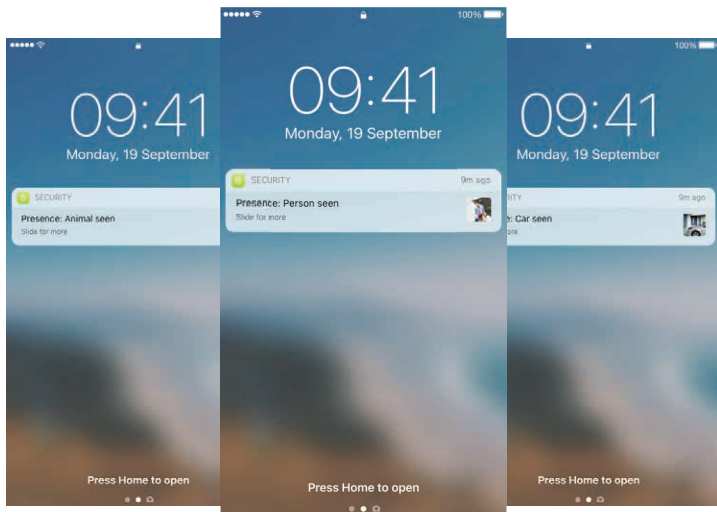

Make your home smarter with Apple HomeKit

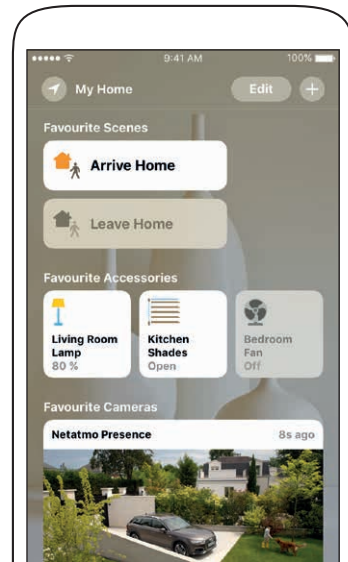

Presence works with Apple's revolutionary HomeKit technology to provide an unparalleled and effortless smart home experience.

For easy control of all your smart home devices, just open the Home app or ask Siri – it's magic!



App compatibility

PRESENCE IS COMPATIBLE WITH:



IFTTT

Apple WATCH

Apple Watch



iOS 9 minimum required



Android 4.3 minimum required
with access to Google Play

NETATMO webapp

PC/Mac

Setup

①

I have an existing
outdoor light



Guided installation video available at
<https://www.netatmo.com/presence-installation>

②

I do not have an existing outdoor
light or I want to install Presence
from scratch



Call a qualified electrician

Setup

Presence connects through Wi-Fi and can easily be installed in place of an existing outdoor light. The do-it-yourself installation is effortless: set up the camera in just a few minutes!

SET UP PRESENCE ON YOUR PHONE

- 1 Download the Security app on your smartphone from <http://presence.netatmo.com>
Available in the app store or Google Play Store
- 2 Create a Netatmo account
- 3 Pair Presence with your phone by following the instructions on the app



REQUIREMENT:
Wi-Fi Internet
connection

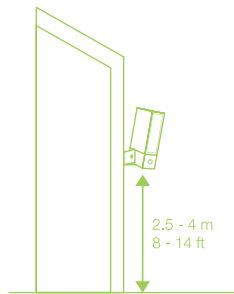

RECOMMENDED:
Height: 2.5 to 4
metres 8-14 ft

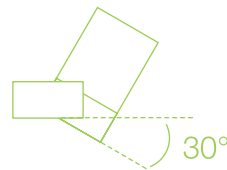

RECOMMENDED:
Tilt angle: 30°

FAQ Netatmo Presence

Use

- How can I access my videos?

Your videos can be easily accessed through the Security App on your smartphone, tablet, PC/Mac or Apple Watch.

- How many people can have access to the camera?

As many people as you wish can have access to the camera via the App.

- How many cameras can I connect to the App?

An unlimited number of Presence cameras.

- How many videos does Presence record?

The number of video clips depends on how long a video is and the size of the microSD card used. With the included microSD card you can usually store more than 100 video sequences on average.

- Is there face recognition?

No, there is not, Presence uses a different technology than face recognition to analyse and report people, cars and animals. It works by detecting the entire form of a moving object. Therefore, Presence can see a person from a distance and recognize that it is a person even when their faces are too small and too far to be recognized by the human eye.

- What if I don't want to be notified about certain things but still record them?

In Presence's settings, you can choose to turn off notifications for certain events but still have them be recorded and appear on the timeline.

- What are Alert-Zones?

The Alert-Zones feature allows you to select specific areas for alerts – you know instantly when someone enters a zone you selected. They're a great way to receive only the alerts you're interested in.

FAQ Netatmo Presence

- How many Alert-Zones can I define? You can select up to four Alert-Zones.
- What is the smart floodlight? The integrated smart floodlight detects unwanted visitor and lights up the way. It can be set to switch on when Presence detects a person, car or animal.
- Can I choose for which event the floodlight will turn on? Yes, the floodlight can be set to turn on when Presence detects people, cars, animals, or for all three. It can also be manually switched on in the App.
- What can I do with HomeKit? Using HomeKit to control your Welcome, you can:
 - Set scenes to control multiple HomeKit-enabled devices
 - Access the live stream of your camera directly in the Home app
 - Ask Siri on your iOS device to show you the live stream view of your camera
 - Create smart home scenarios

Specifications

- What is Smart-Sight? The Smart-Sight feature uses a breakthrough deep learning algorithm to detect the presence of people, cars and animals. It lets you know exactly what happens in front of your home.
- Is there audio? Presence has one-way audio, so all videos will be recorded with sound.
- Is Presence weatherproof? Yes, Presence is designed completely for outdoor use and can withstand the elements including rain, snow, moisture, dust, and dirt thanks to HZO technology and its innovative thin-film coating solution. To learn more, visit www.hzo.com
- How far and wide of an area can Presence see? Presence has long range detection of up to 20m (65 ft), and a 100° field of view.

FAQ Netatmo Presence

- What is the range of night vision?

Presence's infrared night vision can detect shapes up to 15m (50ft) away.

- How much energy does Presence use?

The average power consumption during the day is 5W. At night, because of the floodlight, the average power consumption is 15W when the light is on.

- Are my videos secure?

Yes, bank-level and end-to-end encryption is used to guarantee the highest level of protection

Setup

- Where should I place Presence?

Ideally Presence replaces an existing light fixture outside your home. It is designed to be placed at a height between 2.5-4 m (8-14 ft) for optimum performance.

- How is Presence installed?

Presence installs as an outdoor light. It simply replaces one of your existing outdoor light fixtures.

- Can I install my camera without replacing an existing light fixture?

Yes, you will need to find a power source and install it as a new outdoor light fixture. It is recommended to contact a qualified electrician.

- How is Presence powered?

Presence's power source is the same as of any traditional lamp at home: two cables carrying 100V or 240V, depending on your region.

- Will I receive a notification when the camera has no power?

Yes, a notification will be sent to your smartphone.

FAQ Netatmo Presence

- Will I have a Wi-Fi connection problem because of the distance between Presence and my router?

Presence is designed for outdoors and has a very powerful Wi-Fi antenna so that communication is optimised.

- What happens if there is no internet connection?

You receive a notification that there is no internet connection. As long as it is powered, Presence still works and records videos, but it cannot send new videos to the app without internet. Presence will add all the new videos to the app once there is an internet connection again.

- What are the requirements for using HomeKit and Siri?

HomeKit requires iOS 10 or later on your iPhone, iPad, or iPod touch. To use HomeKit away from home and create home automation scenarios, you will need an Apple TV (4th generation or later) with tvOS 10 or later, or an iPad with iOS 10 or later set up as a home hub.

- How do I setup HomeKit?

Follow the instructions in the Netatmo Security app to setup your camera with HomeKit.

Storage

- What is the maximum SD card size I can use for my Presence?

The maximum SD card size that is compatible with Presence is 32 GB class 10.

- Can I backup videos on the cloud?

Yes, you can connect Presence with your Dropbox account or your personal FTP server to store videos additionally on the cloud.

- How does FTP work?

Your videos will always be encrypted and also stored on Presence's microSD card, plus, if you activate Dropbox or FTP in your app's settings, they will be instantly stored on your personal server as an additional backup. In the app settings you can choose to connect your camera with your FTP account.

- How does Dropbox work?

In the app settings you can choose to connect your camera with your Dropbox account.

FAQ Netatmo Presence

- What is stored in the Netatmo cloud?

There is only a backup screenshot of each video stored for free in the Netatmo cloud. The camera selects a screenshot with the clearest photo of each event. Screenshots are sent through a bank-level encrypted connection to your device.

- What is stored on the camera?

Videos are stored locally on the cameras internal microSD card. Remove the microSD card and the videos are removed from the camera.

- What is stored in the App?

No videos and no screenshots are stored on the App or on your mobile device. All videos are stored on the camera and sent through an end-to-end encrypted connection to your App.

PRESENCE



WELCOME



	OUTDOOR CAMERA	INDOOR CAMERA
Camera type	OUTDOOR CAMERA	INDOOR CAMERA
Livestream	✓	✓
Face recognition	✗	✓
Notifications with names of people it recognises	✗	✓
Notifications for people, cars and animals	✓	✗ (only for people and animals)
Free and full video recording and playback	✓	✓
Fully customisable notifications	✓	✓
Floodlight	✓	✗
Alert-Zones	✓	✗

Notes

WANT TO KNOW MORE
ABOUT PRESENCE?



NETATMO

www.netatmo.com

Netatmo © 2017 All rights reserved. Apple, Apple Watch, iPad, iPad Air, iPhone, and iPod touch are trademarks of Apple Inc., registered in the U.S. and other countries. HomeKit is a trademark of Apple Inc. Use of the Works with Apple HomeKit logo means that an electronic accessory has been designed to connect specifically to iPod touch, iPhone, or iPad, respectively, and has been certified by the developer to meet Apple performance standards. Apple is not responsible for the operation of this device or its compliance with safety and regulatory standards. App Store is a service mark of Apple Inc., registered in the U.S. and other countries. Google Play and the Google Play logo are trademarks of Google Inc. Actual product may differ from the image displayed.