

# Door Entry Solutions Designed for Installers

**ATIGO**



Door Entry Kits

Door Entry Panels

Door Entry Monitors

Accessories



## Why **ATIGO** ?

- Great design
- Simple installation
- Easy life

## Why **Simple-2-Wire** ?

- 2-Wire, non-polarity conscious cabling
- Simple range of products designed with the installer in mind
- Out-of-the box, easy installation solutions
- No training needed
- Easy to configure
- High quality materials

# Contents

4-5	Villa Kits
6-13	Multi-Apartment System
6-7	System Layout
8-10	Entrance Panels
11	System Expansion
12-13	Video Monitors
14-15	Accessories and Power Supplies

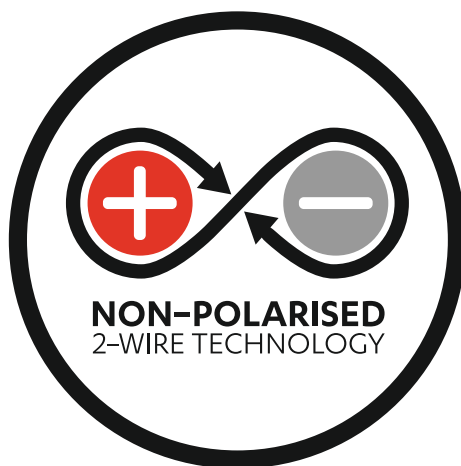



## Atigo Video Villa Kits



### Simple-2-Wire

A sleek door entry system with clean lines and uncomplicated layout. This elegant, non-polarised 2-wire solution is ideal for small installations expandable to four monitors and two door stations. Available with and without Wi-Fi.

Calls diverted to your mobile when using Wi-Fi monitors A1712.



### Attention Indicators

The front door station is equipped with voice and LED status indicators allowing the visitors to know that the intercom is ringing, the door is open, there is no one

### Easy Setup

No complicated programming. DIP switches allow setting of unlock time and lock types.

### Lock

12V DC 250 mA lock output (Fail Open/ Fail Locked) or Volt Free. Lock can be powered by the Atigo 12V DC power supply A2110.

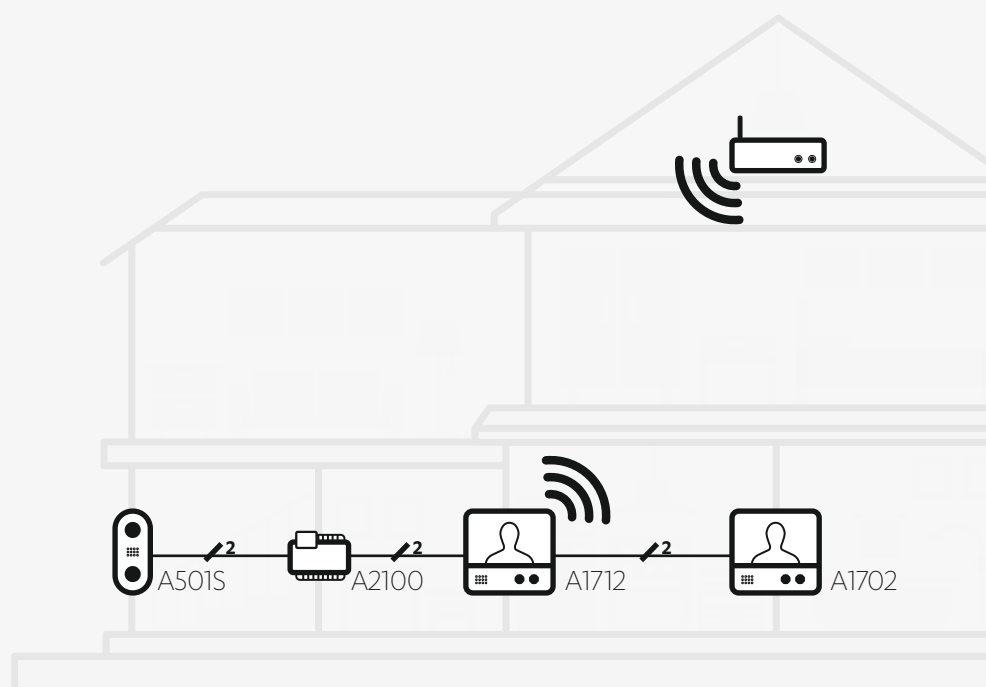



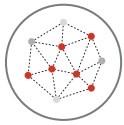

## Atigo Video Villa Kits

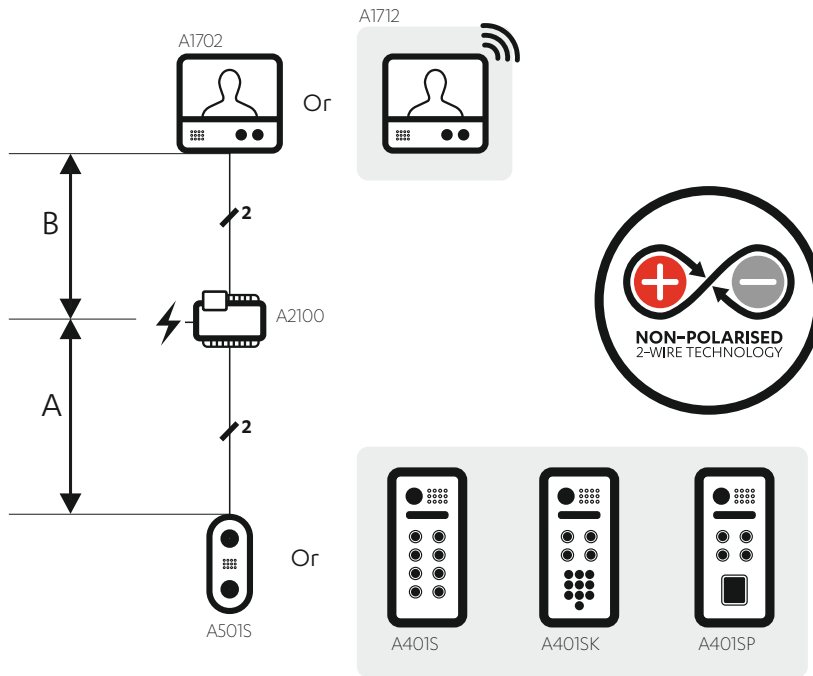

### Installation Notes:

7" video monitors options. Choice of A1702 standard monitor or A1712 Wi-Fi monitor.

You can call up to three additional monitors. No additional equipment is necessary.

If you require mobile app one of the monitors must be Wi-Fi enabled eg. A1712.

### Entrance Panel options:

Choice of four surface mount entrance panels.

	A501S	A401S	A401SK	A401SP	A1702	A1712
Kit includes:	A2100	A3101 A2100	A3101 A2110 A2100	A3101 A2700 A2100	7" Monitor	7" Wi-Fi Monitor
A95017S	1				1	
A95017SW	1					1
A94017S		1			1	
A94017SW		1				1
A94017KS			1		1	
A94017SKW			1			1
A94017SP				1	1	
A94017SPW				1		1

### Notes:

A2100 - Kit Power Supply

A3101 - Camera Unit

A2110 - Keypad Power Supply

A2700 - Proximity Reader, Controller,

10 tags & Power Supply

### Distance (Metres)

Cable Type	A	B	C	D
CAT5e Twisted Cores	40	40	30	60
Twisted Flex PVC Cable 2 x 0.75 mm <sup>2</sup>	60	60	30	110
Twisted Flex PVC Cable 2 x 1.00 mm <sup>2</sup>	80	70	30	140

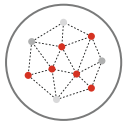

## Atigo Multi-Apartment System

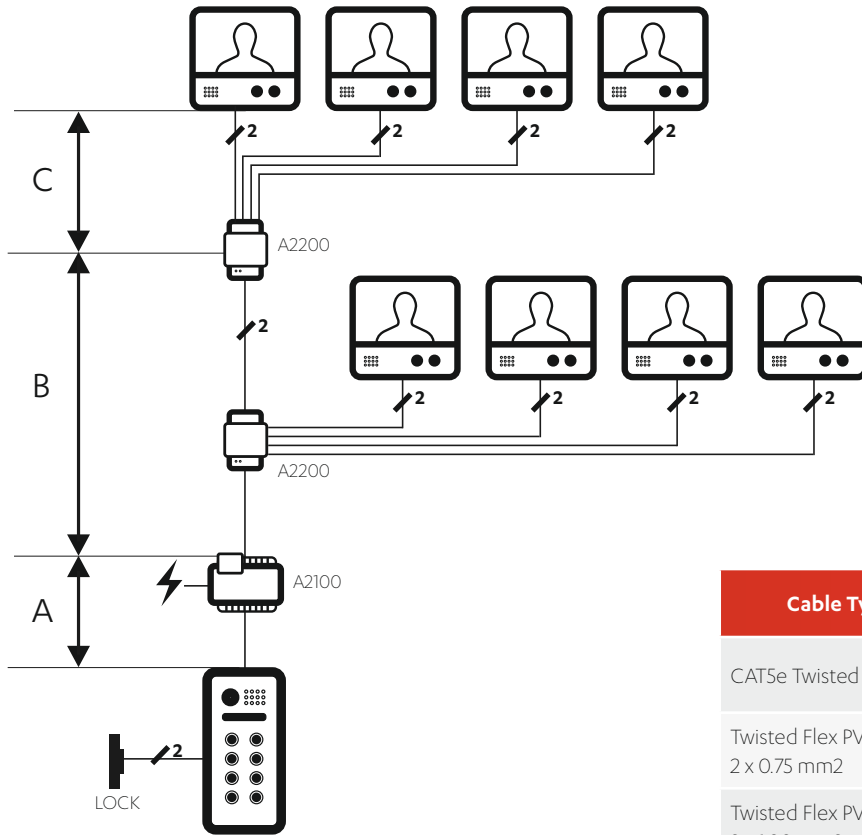

Cable Type	Distance (Metres)			
	A	B	C	D
CAT5e Twisted Cores	40	40	30	60
Twisted Flex PVC Cable 2 x 0.75 mm <sup>2</sup>	60	60	30	110
Twisted Flex PVC Cable 2 x 1.00 mm <sup>2</sup>	80	70	30	140

### Video Door Entry on Single Riser - with Keypad Access Control

Number of Apartments							or	
	Entrance Panel	A3101	A2110	A2100	A2200	A1702	Video Monitor	Wi-Fi Monitor
1	A401SK	1	1	1		1	1	1
2	A402SK	1	1	1	1	2	2	2
3	A403SK	1	1	1	1	3	3	3
4	A404SK	1	1	1	1	4	4	4
5	A405SK	1	1	1	2	5	5	5
6	A406SK	1	1	1	2	6	6	6
7	A407SK	1	1	1	2	7	7	7
8	A408SK	1	1	1	2	8	8	8
9	A409SK	1	1	1	3	9	9	9
10	A410SK	1	1	1	3	10	10	10
11	A411SK	1	1	1	3	11	11	11
12	A412SK	1	1	1	3	12	12	12



## Atigo Multi-Apartment System

Video Door Entry on Single Riser

Number of Apartments	A3101 A2100 A2200 A1702					or	A1712
	Entrance Panel	Camera Unit	Power Supply	Distributor	Video Monitor		Wi-Fi Monitor
1	A401S	1	1		1		1
2	A402S	1	1	1	2		2
3	A403S	1	1	1	3		3
4	A404S	1	1	1	4		4
5	A405S	1	1	2	5		5
6	A406S	1	1	2	6		6
7	A407S	1	1	2	7		7
8	A408S	1	1	2	8		8
9	A409S	1	1	3	9		9
10	A410S	1	1	3	10		10
11	A411S	1	1	3	11		11
12	A412S	1	1	3	12		12
13	A413S	1	1	4	13		13
14	A414S	1	1	4	14		14
15	A415S	1	1	4	15		15
16	A416S	1	1	4	16		16
17	A417S	1	1	5	17		17
18	A418S	1	1	5	18		18
19	A419S	1	1	5	19		19
20	A420S	1	1	5	20		20

Video Door Entry on Single Riser - with Proximity Access Control

Number of Apartments	A3101 A2700 A2100 A2300 A1702						or	A1712
	Entrance Panel	Camera Unit	Access Control	Power Supply	Distributor	Video Monitor		Wi-Fi Monitor
1	A401SP	1	1	1		1		1
2	A402SP	1	1	1	1	2		2
3	A403SP	1	1	1	1	3		3
4	A404SP	1	1	1	1	4		4
5	A405SP	1	1	1	2	5		5
6	A406SP	1	1	1	2	6		6
7	A407SP	1	1	1	2	7		7
8	A408SP	1	1	1	2	8		8
9	A409SP	1	1	1	3	9		9
10	A410SP	1	1	1	3	10		10
11	A411SP	1	1	1	3	11		11
12	A412SP	1	1	1	3	12		12



## Atigo Stainless Steel Video Panels



Atigo **A412S**

### Simple-2-Wire

A sleek, surface mounted panel with up to 12 buttons and video camera module. The front plate is high quality, BS316 stainless steel. It has been laser cut for precision with an anthracite grey powdercoated, stainless steel hood. The camera is equipped with fisheye lens for super wide, 170 degree viewing angle.

- BS316 stainless steel construction
- Vandal resistant 19 mm call buttons
- Video camera with 170 degree fisheye lens
- Clear high-quality audio
- Light for night view
- Voice confirmation
- LED indicators

· call in progress

· speak now

· door open

SKU	"Number of Buttons"	Size	"Panel Height"	"Panel Width"	"Panel Depth"	"Hood Depth"
A401S - A404S	1 - 4	1	169	114	50	61
A405S - A412S	5 - 12	2	269	114	50	61
A413S - A420S	13 - 20	3	369	114	50	61





## Atigo Stainless Steel Video Panels with keypad



Atigo **A404SK**

### Simple-2-Wire

A sleek, surface mounted panel with up to 12 buttons and video camera module. The front plate is high quality, BS316 stainless steel. It has been laser cut for precision with an anthracite grey powdercoated, stainless steel hood. The camera is equipped with fisheye lens for super wide, 170 degree viewing angle.

- BS316 stainless steel construction
- Vandal resistant 19 mm call buttons
- Video camera with 170 degree fisheye lens
- Clear high-quality audio
- Light for night view
- Voice confirmation
- LED indicators
  - call in progress
  - speak now
  - door open

### Keypad Features

This panel has the added feature of a keypad which can be used to control a door or gate with the use of a pin code.

Power supply A2110 required

- Keypad with 108 user codes & 2 user modes
- Durable square buttons with illuminated keys
- Reassurance beep when the key is pressed
- Non-volatile data storage

SKU	"Number of Buttons"	Size	"Panel Height"	"Panel Width"	"Panel Depth"	"Hood Depth"
A401SK - A404SK	1 - 4	2	269	114	50	61
A405SK - A412SK	5 - 12	3	369	114	50	61



## Atigo Stainless Steel Video Panels with proximity reader



Atigo **A406SP**

### Simple-2-Wire

A sleek, surface mounted panel with up to 12 buttons and video camera module. The front plate is high quality, BS316 stainless steel. It has been laser cut for precision with an anthracite grey powdercoated, stainless steel hood. The camera is equipped with fisheye lens for super wide, 170 degree viewing angle.

- BS316 stainless steel construction
- Vandal resistant 19 mm call buttons
- Video camera with 170 degree fisheye lens
- Clear high-quality audio
- Light for night view
- Voice confirmation
- LED indicators

- call in progress
- speak now
- door open

### Proximity Features

This panel has the added feature of a proximity cut-out. This will give the end user the ability to open their door or gate using a proximity card or fob when used with A2700.

- 40 x 40mm square panel mount proximity reader
- 2000 user controller
- 12V DC power supply
- 10 x proximity tags

SKU	"Number of Buttons"	Size	"Panel Height"	"Panel Width"	"Panel Depth"	"Hood Depth"
A401SP - A404SP	1 - 4	2	269	114	50	61
A405SP - A412SP	5 - 12	3	369	114	50	61



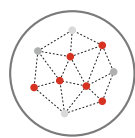

## Atigo Extending the system

### Simple-2-Wire

#### Additional Entrances

The A2300 allows expansion of up to four entrance panels.

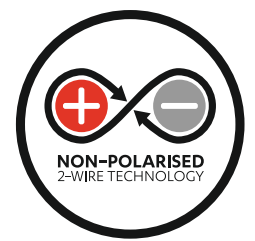
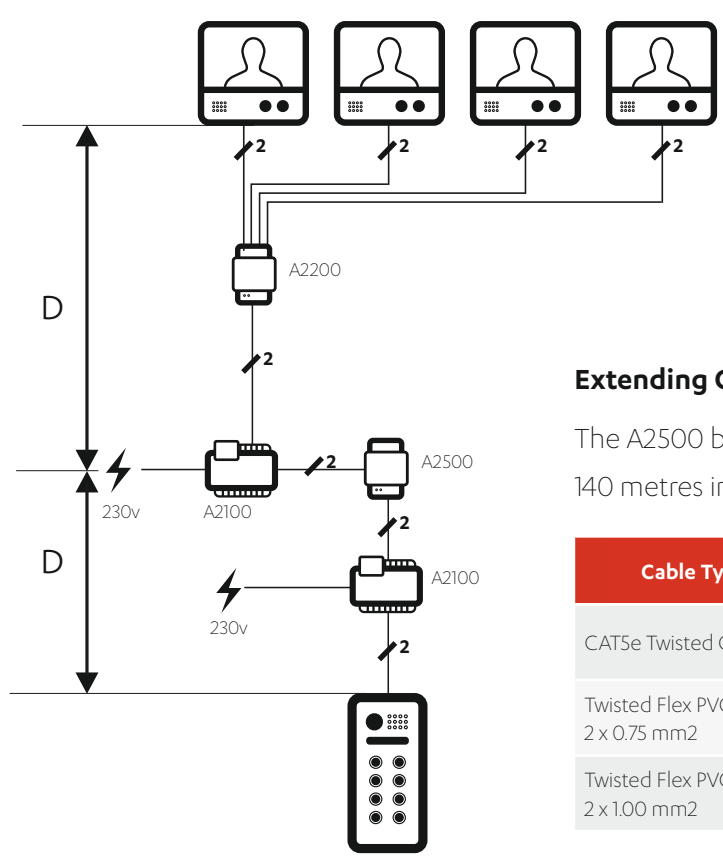
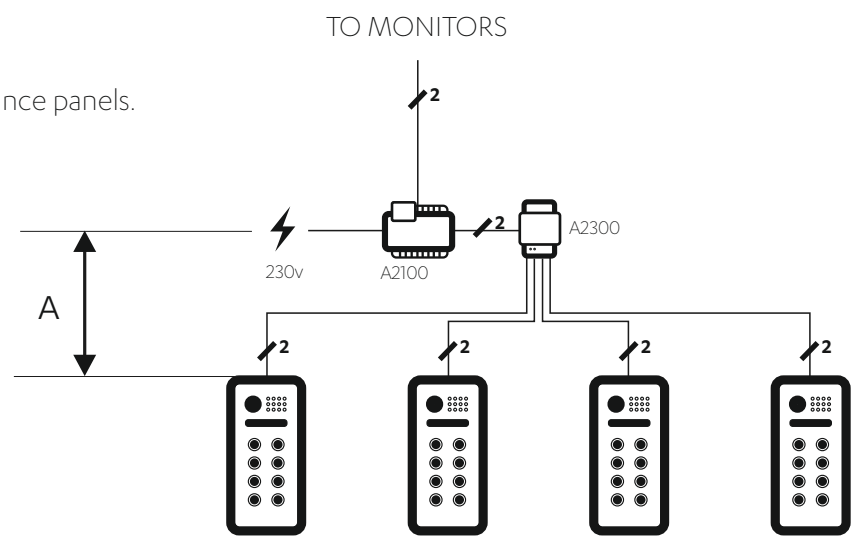

#### Extending Cable Distances

The A2500 boosts the cable distance up to 140 metres in each direction.

Cable Type	Distance (Metres)			
	A	B	C	D
CAT5e Twisted Cores	40	40	30	60
Twisted Flex PVC Cable 2 x 0.75 mm <sup>2</sup>	60	60	30	110
Twisted Flex PVC Cable 2 x 1.00 mm <sup>2</sup>	80	70	30	140

# MONITORS



## Atigo Touchscreen Monitors

### Atigo **A7100**

Atigo Desktop Bracket for 2-Wire Colour Monitor (White)



7" monitors are slim, discreet and ideal for wall or desk mounting. Available in an elegant white & light grey finish. The 7" touchscreen monitor has 800 x 400 resolution and ultra-thin design. LED indicators lock monitor status. To table or desk mount add A1702DK desk kit. The A1712 Wi-Fi enabled monitor facilitates app call to mobile (iOS or Android). Connecting is a easy using the **Simple-2-Wire** non-polarised cabling system.

	A1702	A1712
Simple and intuitive menu with navigation	1	1
7" LCD display with touch screen	1	1
Ultra-thin design (22mm)	1	1
Built in Wi-Fi for calling via Mobile App		1
LED indicator for calling status	1	1
Do not disturb indicator	1	1
Wall or desk mount (with A7100 kit)	1	1

# MONITORS

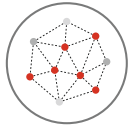

## Atigo Additional Monitors

### Simple-2-Wire

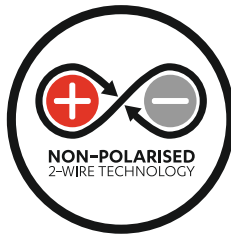
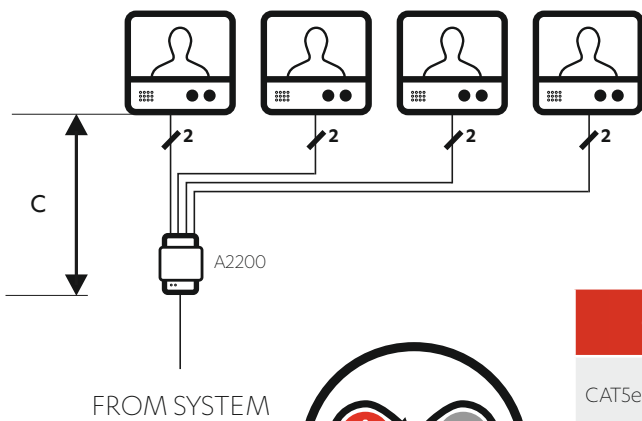

SKU	Height	Width	Depth
A1702	161	174	22
A1712	161	174	22
A1702DK	157	161	151

### Distance (Metres)

Cable Type	A	B	C	D
CAT5e Twisted Cores	40	40	30	60
Twisted Flex PVC Cable 2 x 0.75 mm <sup>2</sup>	60	60	30	110
Twisted Flex PVC Cable 2 x 1.00 mm <sup>2</sup>	80	70	30	140

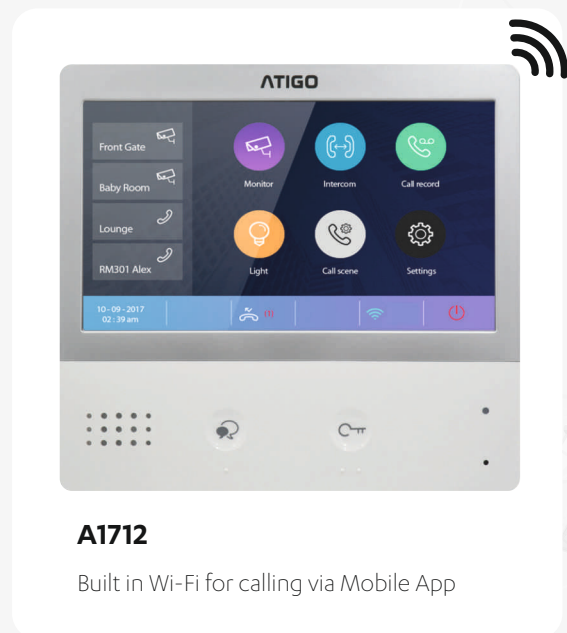



## A2100 Power/Bus combiner

- Input: 100 ~ 240 VAC
- Output: 26V DC ± 2V rated at 1.5A
- Short-circuit, overload, and over-voltage protection
- DIN rail mountable



## A2110 Keypad Power Supply

- Input: 90 ~ 264 VAC
- Output: 12V DC rated at 1.5A
- Output power: 18W
- DIN rail mountable



## A2200 Video Riser Distributor

- Four outputs video amplifier
- Riser mode and Distributor mode
- Built-in short-circuit indication
- Separate isolation protection
- Automatic self-detection mechanism for recovery



## A2300 Four output distributor for multiple entrances

- Status indicator
- Impedance switch
- Din-Rail mountable





## A2400 Push-button Expander

- Used for up to eight mechanical buttons
- Maximum of four modules

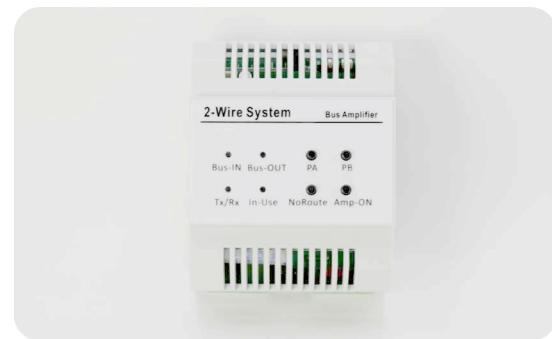

## A2500 BUS Amplifier

- Increases distance between first panel & expander by up to 140m
- Increases distance between last monitor & expander by up to 140m
- Status indicator
- DIN rail mountable

### Power & Control devices

SKU	Height	Width	Depth	DIN
A2100	90	140	60	8
A2110	95	25	56	1
A2200	90	71	45	4
A2300	90	71	45	4
A2400	46	64	17	n/a
A2500	90	72	60	4



[atigo.uk](http://atigo.uk)