

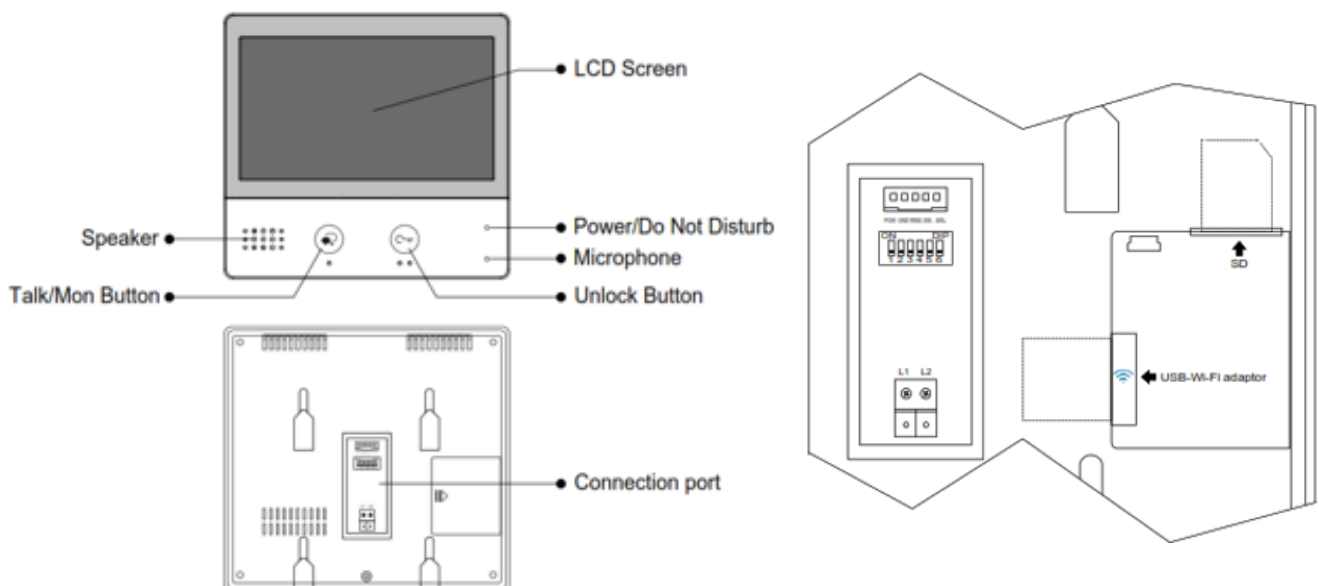

## Features

- Simple and intuitive menu & navigation;
- 7" display with touch screen;
- Ultra-thin design (22mm);
- Built in Wi-Fi for call divert or mobile calling via App
- Made of high-quality ABS plastic.

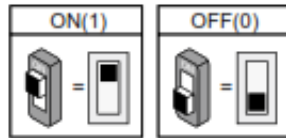



Bit-6 line terminal setting:

Bit state	Setting	Bit state	Setting
	Monitor not at the end of the line.		Monitor at the end of the line.

## Parts & Functions

- SW+ / SW-: Extra doorbell call button connection port
- Ring / GND: Extra buzzer connection port
- POW / GND: 12~16V extra power connection port
- DIP Switches: Used to program the monitor address
- BIT1 ~ BIT5: User code setting (address)
- BIT6: Video impedance matching
- L1 / L2: BUS line terminal

## Specification

- Input Voltage: 20~28V DC
- Power Consumption: Standby 1.8W – Working 8.16W
- Screen Size: 7" Colour TFT
- Display Resolution: 800x480 pixels
- Video Signal: 1Vp-p, 75Ohm, CCIR standard
- Wiring: 2 wires non-polarized
- Dimension: 160\*174\*22mm (H\*W\*D)