

## DATA SHEET

COD. **3454**

### TOUCH SCREEN STAINLESS STEEL A/V ENTRANCE PANEL ? VIP

Stainless steel flush-mounted entrance panel with 7" capacitive touch screen with impact-proof glass. IK08 certified. Configurable graphics (list of names with search, up to 60 virtual buttons (or 10 with images, name directory, access codes up to 8 digits). Integrated RFID reader which can be used in conjunction with Simplekey. Users and settings are simple to program using VIP Manager part. 1449. It is compatible with all VIP products and functions. Pre-assembled with VIP a/v unit part. 4682C for audio/video/door lock management, and flush-mounted box with concealed fixing screws. Dimensions 342x182x3 mm.

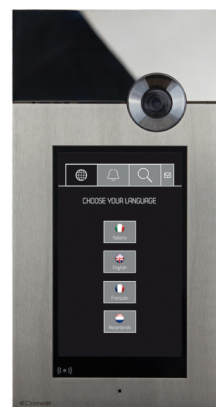

#### Main specifications

Vandal Resistant IK: **IK08**

#### Compatibility

Video door entry family: **Oui**

Vip system: **Oui**

#### Mounting/Installation

Flush-mounted: **OUI**

#### Audio/video specifications

Signal/noise ratio (dB): **48**

Angle of view on 3 axes (°): **D:80,27 H:67.07 V:47,37**

Display size (inches): **8'**

Camera pixels (H x V): **500x582**

Display resolution (H x V): **800x480**

Audio system: **NON**

Audio/video system: **OUI**

Type of display: **Ecran Tactile**

#### Hardware specifications

DDE function: **OUI**

#### Connectivity

Type of connections/ports: **RS485, ETH**

Ethernet ports: **1**

RS485 ports: **2**

# DATA SHEET

## Functions - Settings

|                             |     |
|-----------------------------|-----|
| Key button function:        | OUI |
| Loudspeaker volume control: | OUI |

## Technical properties

|                         |           |
|-------------------------|-----------|
| Temperature range (°C): | -25~+55°C |
|-------------------------|-----------|

## Electrical specifications

|             |     |
|-------------|-----|
| Absorption: | 25W |
|-------------|-----|

## General info

|                      |     |
|----------------------|-----|
| Product height (mm): | 342 |
| Product width (mm):  | 182 |
| Product depth (mm):  | 60  |

## Packaging

|                          |      |
|--------------------------|------|
| Single pack height (mm): | 130  |
| Single pack width (mm):  | 515  |
| Single pack weight (g):  | 4350 |
| Single pack depth (mm):  | 235  |