

TELEPHONES



200/500 Series Telephones

- 500 video features 3.5" LCD colour screen
- Electronic ringer with adjustable volume
- Plug-in handset
- Mute switch
- Dual camera mode
- Door status monitoring

The Entryphone® 200 (audio) and 500 (video and audio) series telephones feature similar styling but differ slightly depending whether audio or video is required. Model variants allow features in addition to door release such as dual camera control, door monitoring, ring mute, porter call and other ancillary switching requirements.

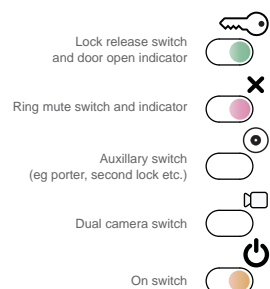

*Symbols shown for 530 type phones, symbols vary for other models

Desk-Mounted Options

The 530 series telephones are designed for wall fixing but most models can be adapted for desk mounting with an appropriate desk plate and conversion kit.

Dimensions (mm)

Height	Width	Depth
195	90	60

Video on 5 Wires

Upgrade existing audio systems to video without re-wiring with Entryphone® 500 series.



200/500 Series Telephones

Audio

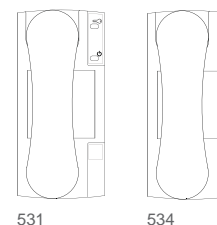
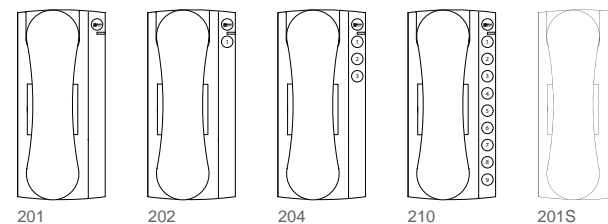

Video

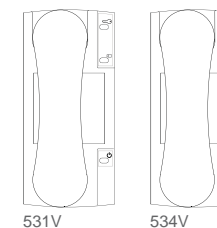

Desk kit for 200/500 series

* Note: 232V model is a compatible replacement video telephone for 900 and 200 series systems only. For new video installations use 500 series.