

Mod. 1155/22

With 2 call buttons
for 4+n systems

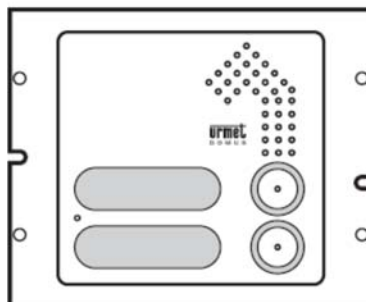

DESCRIPTION OF TERMINALS Ref. 1155/20, Ref. 1155/21 AND Ref. 1155/22A

1	Traditional voice out (from speaker to door phone)
1A	Electronic voice out (from speaker to door phone)
-	Door unit power negative
+	Door unit power positive
2	Voice in (from microphone to door phone)
-0	} Button and name tag light LED power
-12	
U2	Call button (Ref. 1155/22A module only)
G/T2 (°)	Call button common (Ref. 1155/22A modules only)
U1	Call button (Ref. 1155/21 and 1155/22A modules only)
G/T (°)	Call button common (Ref. 1155/21 and 1155/22A modules only)

(°) this terminals are usually short-circuited and may be separated by the installer.

Note: use terminal "1A" in systems with electronic call door phone and terminal "1" for Mod. 1130 door phone.

CALL BUTTON CONTACT SEPARATION

Proceed as follows to separate G/T common contacts in 1155/12A, 1155/13A and 1155/14A button modules.

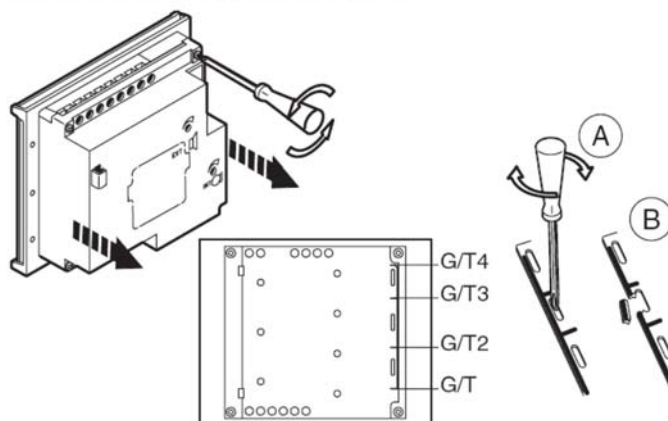

Simply cut the jumper between two terminals in 1155/22A and 1155/32A door unit modules.

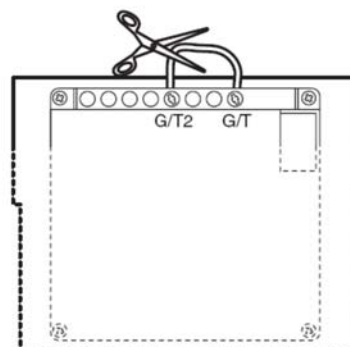

Either groups or buttons or single buttons may be isolated according to the point where the contacts are separated (dotted X in the drawings).



Keypad quick start instructions

Press the button (marked PASSWORD) on the rear of the keypad three times within a time period of six seconds

Enter a password (must be six digits) and press the 'Key' button

Enter the door release time, for example for five seconds press 5 and then press the 'Key' button

Enter the first door open code (between three and eight digits) and press the 'Key' button

Up to eight different door open codes can be entered.
After you have finished entering door open codes press and hold
the 'X' button until a long bleep is heard.
This will exit from the programming mode.

To change the door open code -

Press the 'Key' button followed by the 'X' button followed by the 'Key' button;
now enter the six-digit password

Press the 'Key' button TWICE

Press 5 (for 5 seconds door release time) and press the 'Key' button

Enter the new door open code (between three and eight digits) and press the 'Key' button

Up to eight different door open codes can be entered.
After you have finished entering door open codes press and hold
the 'X' button until a long bleep is heard.
This will exit from the programming mode.

Urmet Domus Communication & Security UK Ltd Urban Hive, Avenue West Skyline 120 Great Notley Essex CM77 7AA Tel 01376 556010 Fax 01376 567874 www.urmet.co.uk	Title	Audio entry system connection details
	Drawing No	UD01596
	Date	23-9-2005
	Revision	01