

Unique Anti-Residual design

When there is no power, there will be no holding force, and the push-off button will pop out immediately, to release the Electromagnetic Lock and the Armature Plate for no residual magnetism.

Statement

10000 is one of the basic and standard fail-safe electromagnetic lock that is simply, works well in order to effectively secure with doors. 10000 is a mortise electromagnetic lock, therefore it is suitable for using by sliding gate applications. The 10000 electromagnetic lock designed to hold 600 lbs can be selectable for 12V or 24V DC dual input voltage.

10000R electromagnetic lock is the upgraded version of 10000. The bond sensor has been added. The bond sensor is used to indicate the door status as in a locked or unlocked condition.

Specifications

- Voltage Tolerance: 15%
- Current Draw: 500mA@12Vdc ; 250mA@24Vdc (at temperature 20 C)
- Magnetic bond sensor monitor output (10000R): SPDT rated 0.25A@12V DC
- Operating Temperature: -10~55C (14~131F)
- Humidity: 0~95% non-condensing.
- Lock's surface Temperature (when the power is on): can not exceed ambient temperature by 20 C.
- Holding Force: Up to 600 lbs (272 Kg)
- Dimensions:
 - Magnet:(L) 230, (W) 38, (D) 27 mm
 - Armature Plate:(L) 185, (W) 38, (D) 12 mm
- Special Finishes for magnet and armature plate: Zinc
- Epoxy Potting Compound: E87252 (S), UL94V-0
- Weight (Approx.): 2.0 Kg

Dimension

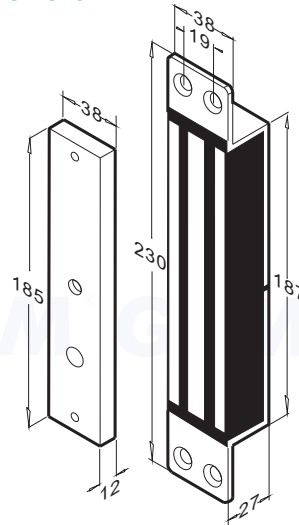

Unit: mm

Application

Suitable for sliding door

Optional Bracket AMB-300

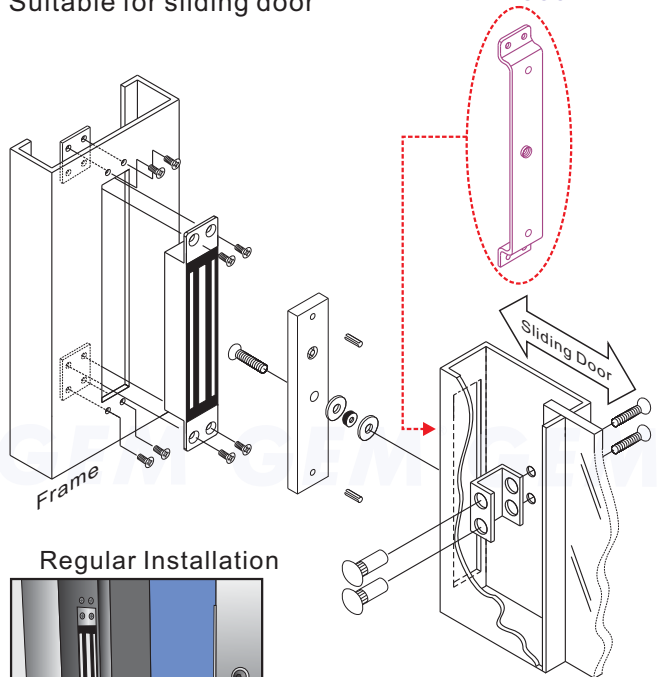

Regular Installation

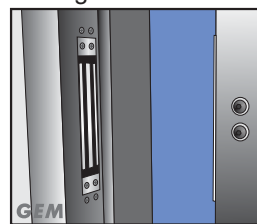

Warranty

The product is warranted against defects in material and workmanship while used in normal service for a period of 5 year from the date of sale to the original customer. The GEM policy is one of continual development and improvement; therefore GEM reserves the right to change specifications without notice.

GIANNI INDUSTRIES, INC.

